

Brand ZUCCHETTI

Class

SAVOIR

SAVOIR

ZSA077.1900CN Built-in thermostatic shower mixer with volume control













$\frac{3}{4}$ " built-in thermostatic shower mixer with volume control.
8 GPM @ 43,5 PSI

R99630.1900

Rough-in

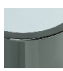

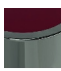
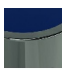
Finishes

 CN Chrome + Black	 CC Chrome + Chrome	 CW Chrome + White	 CR Chrome + Red	 CL Chrome + Blue	 CV Chrome + Green	 C8C8 Polished Nickel
 C8W Polished Nickel+White	 C8N Polished Nickel+Black	 C8R Polished Nickel+Red	 C8L Polished Nickel+Blue	 C8V Polished Nickel+Green		

Brand ZUCCHETTI

Class

SAVOIR

SAVOIR

ZSA077.1900CN Overall Drawing

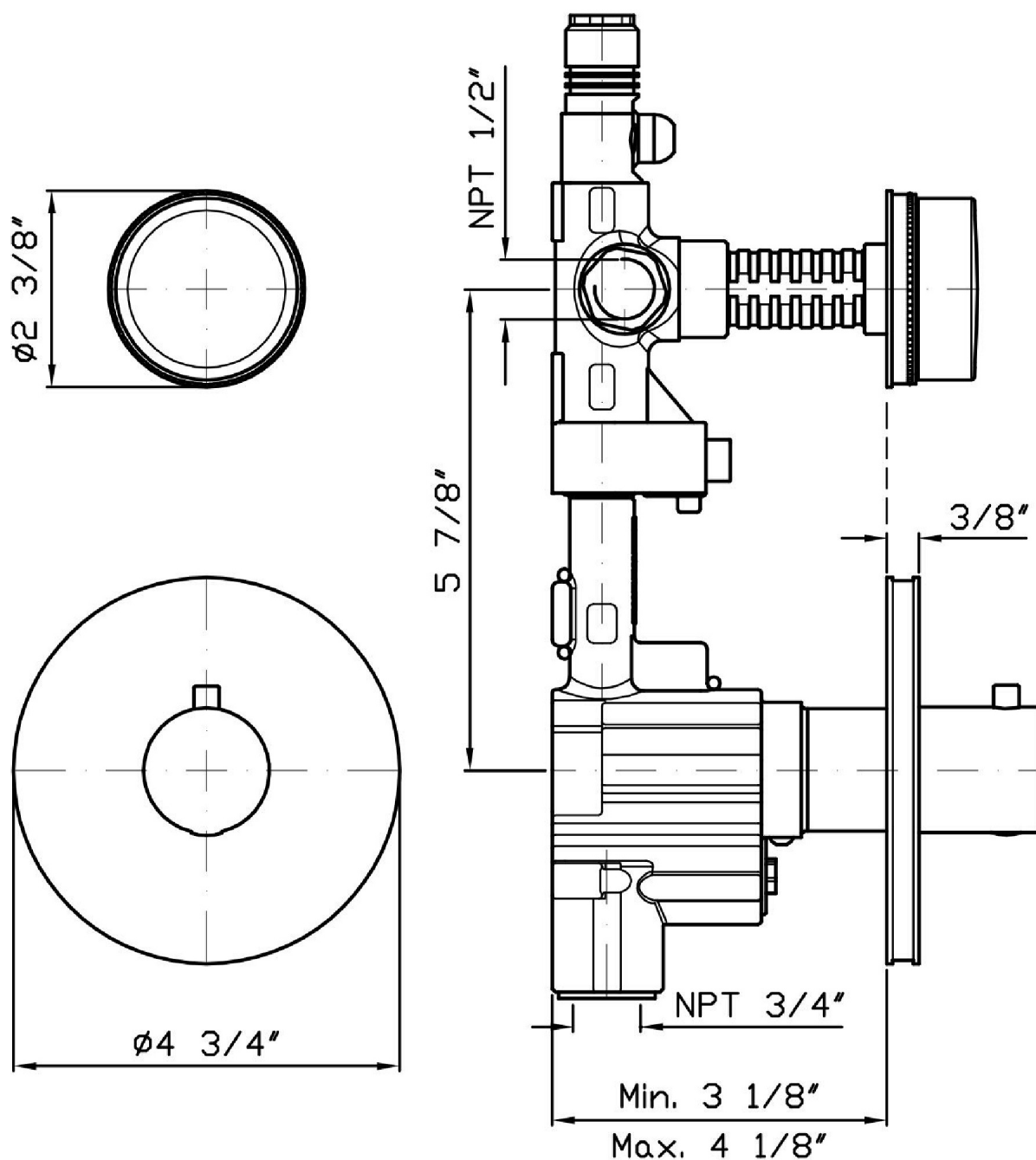

Brand ZUCCHETTI

Class

SAVOIR

SAVOIR

ZSA077.1900CN Exploded

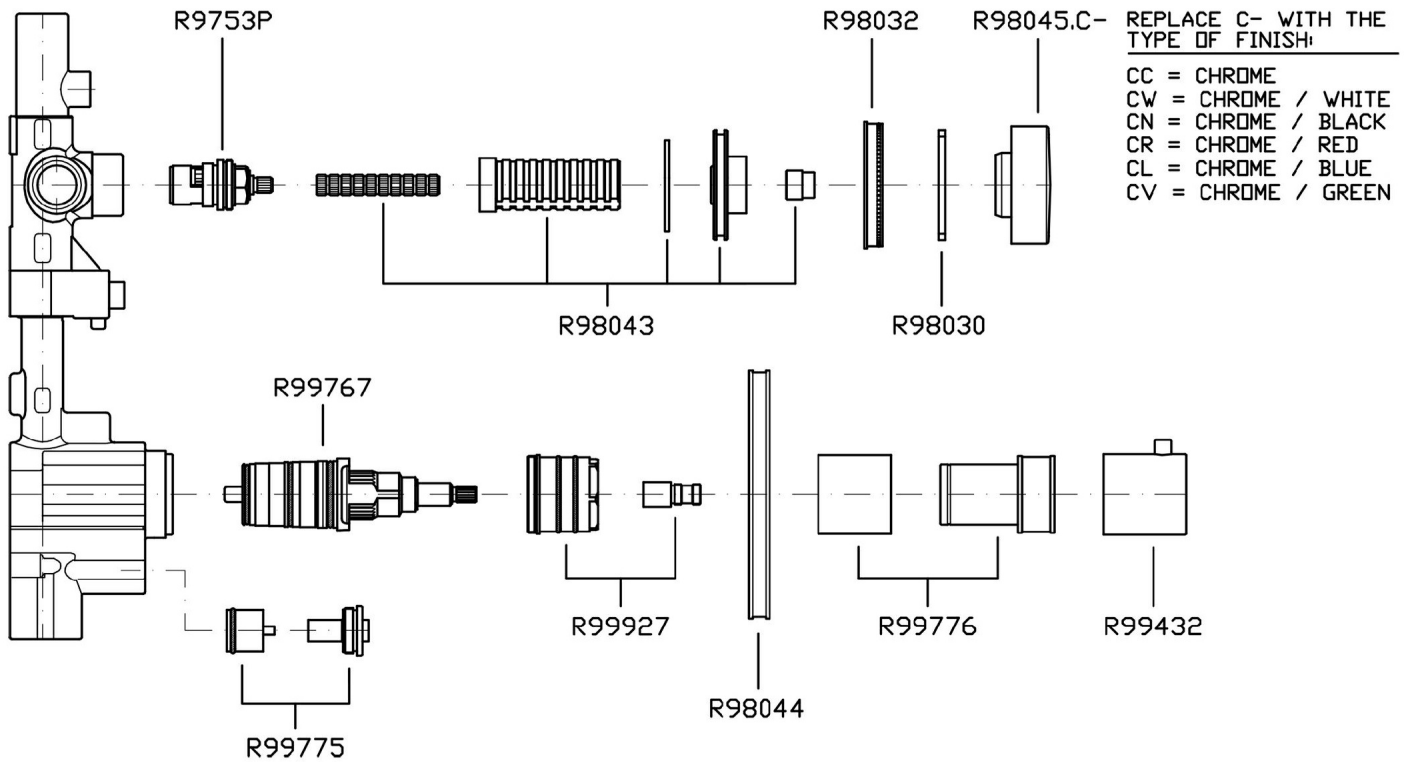

Brand ZUCCHETTI

Class

SAVOIR

SAVOIR

ZSA077.1900CN Certifications

USA

IAPMO

SAVOIR

ZSA077.1900CN Weights and Sizes

Weight (lb)	1,935 (Kg)	4,265901 (lb)
Volume (dc3) - (in3)	11,01 (dc3)	0,000672 (in3)
h (mm) - (in)	90 (mm)	3,543309 (in)
L1 (mm) - (in)	335 (mm)	13,1889835 (in)
L2 (mm) - (in)	365 (mm)	14,3700865 (in)

