

SHOWER

Z93939.1900

Wall-mounted handshower support.



Wall-mounted handshower support, 1/2" hose connection.

Finiture / Finishes



Chrome



Polished Nickel

C8



Gold

C40



Brushed Gold

C41

SHOWER

Z93939.1900 Disegno Complessivo / Overall Drawing

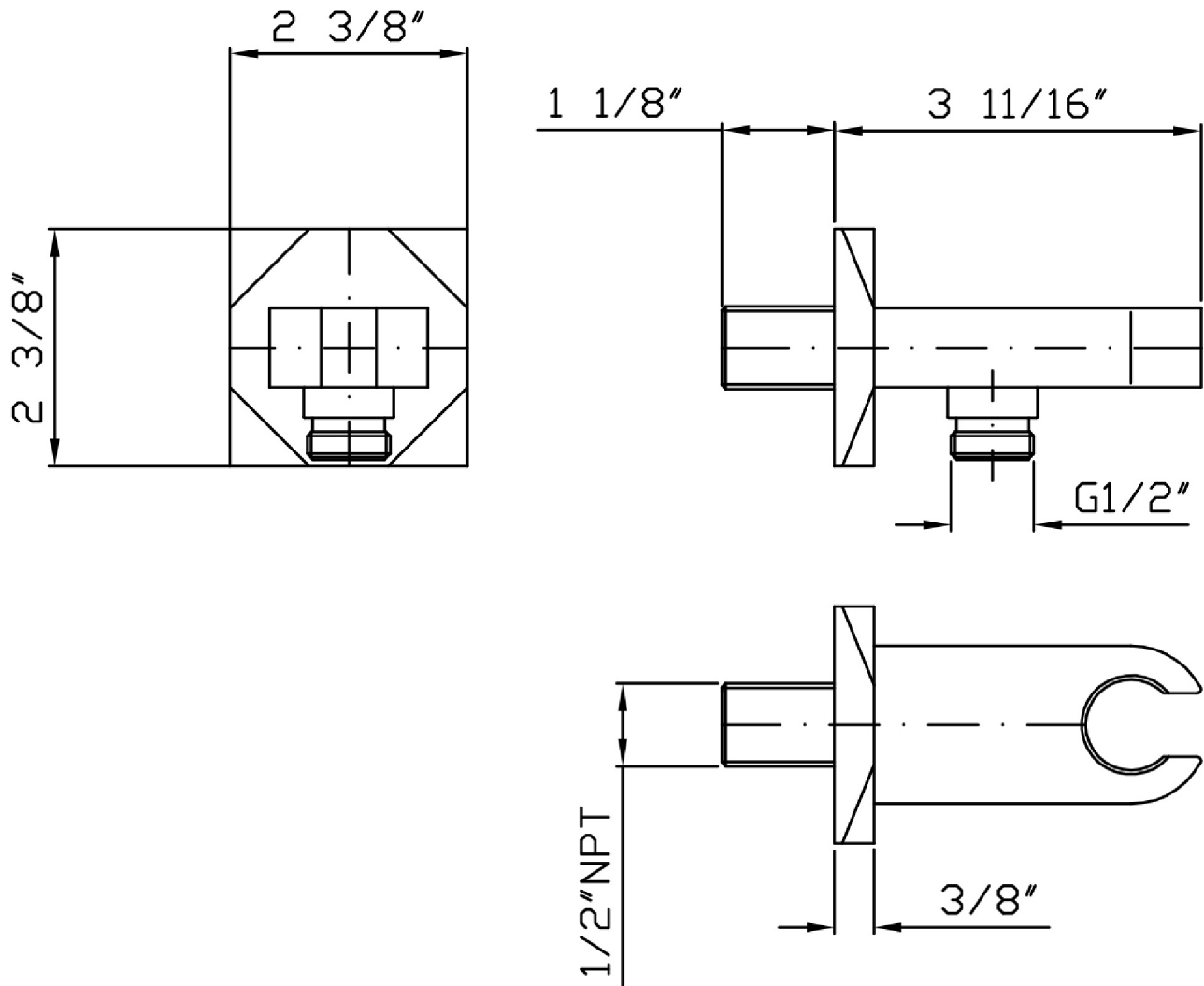

SHOWER

Z93939.1900

Certificazioni / Certifications

USA

IAPMO

SHOWER

Z93939.1900

Pesi e Misure / Weights and Sizes

Peso (Kg) Weight (lb)	0,77 (Kg)	1,70 (lb)
Volume test (dc3) - (in3)	1,21 (dc3)	73,84 (in3)
h (mm) - (in)	73,00 (mm)	2,87 (in)
L1 (mm) - (in)	127,00 (mm)	5,00 (in)
L2 (mm) - (in)	130,00 (mm)	5,12 (in)

