



4" CENTERSET GOOSENECK

Z812T3

TAG _____



Engineering Specifications: Zurn AquaSpec® Z812T3

Polished chrome-plated cast brass faucet body with integral shanks, quarter turn ceramic disc cartridges and a 4-1/2" [114mm] centerline rigid gooseneck spout with vacuum breaker. Unit is furnished with a 2.2 GPM [8.3 L] pressure compensating aerator (complying with ANSI A112.18.1 Standard for flow), 2" [51mm] vandal-resistant color-coded metal dome lever handles, mounting hardware and 1/2" NPSM coupling nuts for standard lavatory risers.

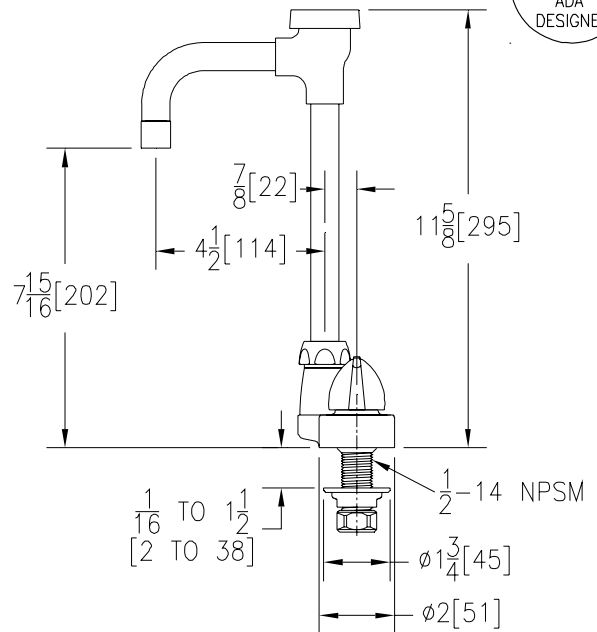
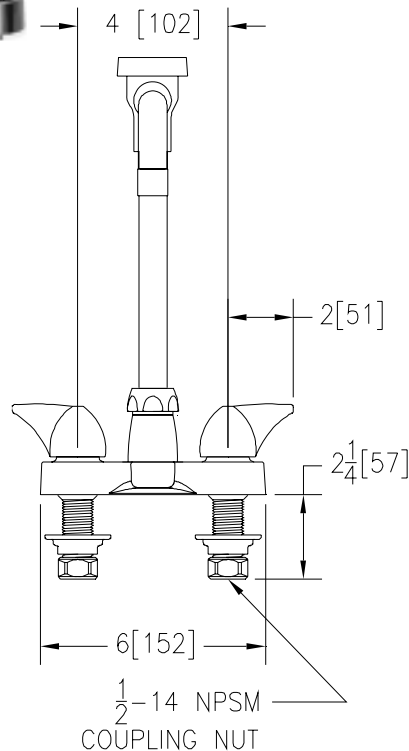

Note: All dimensions are for reference only. Do not use for pre-plumbing.

OPTIONAL ACCESSORIES

Suffix	Description
— -FC	2.0 GPM [7.6 L] Laminar Flow Control in Base of Spout
— -G	1-1/4" [32mm] Grid Strainer Drain
— -HCT	Hot/Cold Text Indexes
— -LP	Low Profile
— -P	1-1/4" [32mm] Pop-up Drain
— -PT	1-1/4" [32mm] Cast Brass P-Trap with a 7-1/2" [191mm] Long 17-Gauge Wall Bend
— -2M	2.2 GPM [8.3 L] Vandal-Resistant Pressure Compensating Male Aerator
— -3M	0.5 GPM [1.9 L] Vandal-Resistant Pressure Compensating Male Aerator
— -4M	2.2 GPM [8.3 L] Vandal-Resistant Pressure Compensating Male Laminar Flow
— -5M	2.0 GPM [7.6 L] Male Spray Outlet
— -6M	2.0 GPM [7.6L] Male Serrated Nozzle Outlet
— -7M	1.0 GPM [3.8 L] Pressure Compensating Male Spray Outlet
— -16M	1.0 GPM [3.8 L] Vandal Resistant Pressure Compensating Male Spray Outlet
— -17M	1.5 GPM [5.7 L] Vandal Resistant Pressure Compensating Male Aerator
— -18M	1.5 GPM [5.7 L] Vandal Resistant Pressure Compensating Male Laminar Flow

ZURN INDUSTRIES, INC. ♦ COMMERCIAL BRASS OPERATION ♦ 2640 SOUTH WORK STREET ♦ FALCONER NY 14733

Phone: 1-716-665-1132 ♦ Fax: 1-716-665-1135 ♦ World Wide Web: www.zurn.com

In Canada: ZURN INDUSTRIES LIMITED ♦ 3544 Nashua Drive ♦ Mississauga, Ontario L4V1L2 ♦ Phone: 905/405-8272 Fax: 905/405-1292