



TEMP-GARD SOLID BRASS SHOWER HEAD

Z7000-S7

TAG _____

Engineering Specifications: Zurn Z7000-S7

Ball joint solid brass chrome plated shower head, maximum flow rate 2.2 GPM at 80 PSI, pressure compensating flow control, 1/2" NPT female threaded inlet, fixed body width spray pattern. Vandal proof resistance optional.

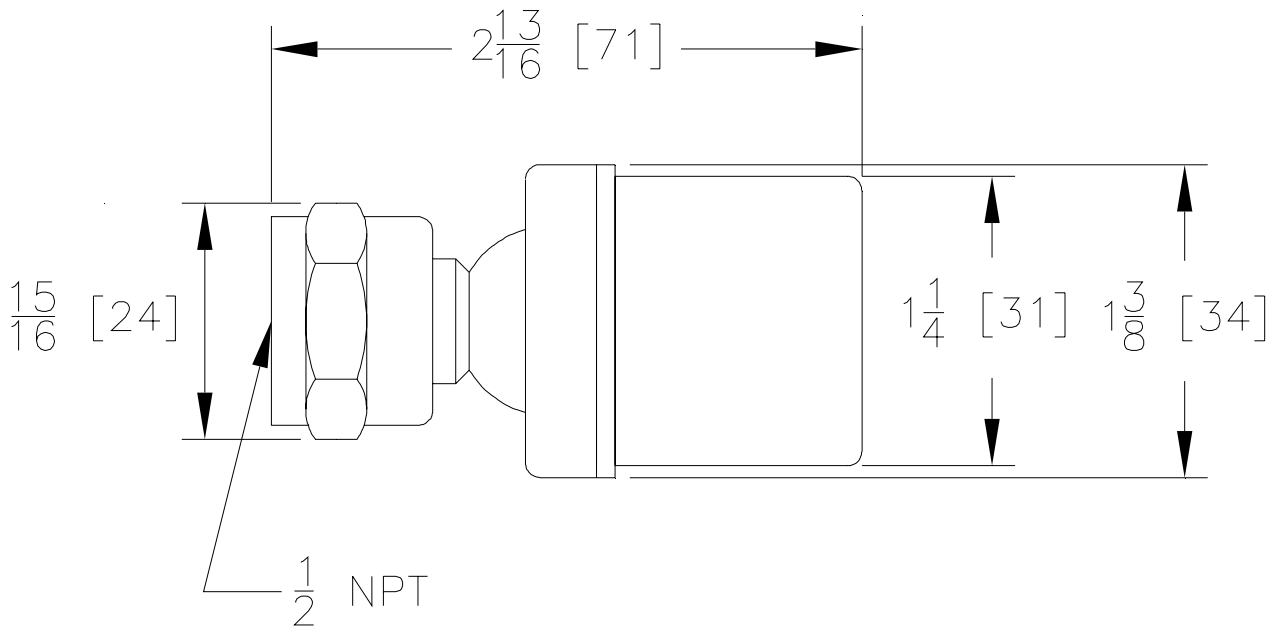

Note: All dimensions are for reference only. Do not use for pre-plumbing.

OPTIONS (Check/specify appropriate options)

Suffix	Description
___ -VP	Vandal Proof Set Screws

STANDARDS

Tested to meet the following standards for valves and plumbing fittings:
Shower Heads meet ANSI A112.18.1

ZURN INDUSTRIES, LLC ♦ COMMERCIAL BRASS OPERATION ♦ 2640 SOUTH WORK STREET ♦ FALCONER NY 14733

Phone: 1-716-665-1132 ♦ Fax: 1-716-665-1135 ♦ World Wide Web: www.zurn.com

In Canada: ZURN INDUSTRIES LIMITED ♦ 3544 Nashua Drive ♦ Mississauga, Ontario L4V1L2 ♦ Phone: 905/405-8272 Fax: 905/405-1292