



QET_GX

XL BRASS F1960 EXPANSION PEX TEE

SPECIFICATION SHEET

TAG _____

Dimensional Data (inches and [mm]) are Subject to Manufacturing Tolerances and Change Without Notice

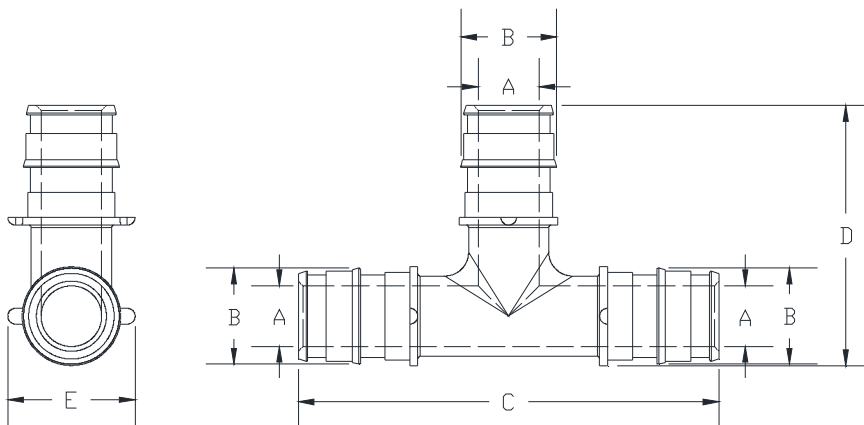

Part Number	XL Brass Expansion Tee size (EX PEX x EX PEX x EX PEX)	C	D	E
		in [mm]	in [mm]	in [mm]
QET333GX	1/2" x 1/2" x 1/2"	2.25 [57]	1.61 [41]	0.77 [20]
QET334GX	1/2" x 1/2" x 3/4"	2.49 [63]	1.86 [47]	1.02 [26]
QET433GX	3/4" x 1/2" x 1/2"	2.33 [59]	1.89 [48]	1.02 [26]
QET434GX	3/4" x 1/2" x 3/4"	2.61 [66]	2.13 [54]	1.02 [26]
QET443GX	3/4" x 3/4" x 1/2"	2.72 [69]	1.89 [48]	1.02 [26]
QET444GX	3/4" x 3/4" x 3/4"	2.92 [74]	2.13 [54]	1.02 [26]
QET445GX	3/4" x 3/4" x 1"	3.28 [83]	2.33 [59]	1.36 [34]
QET544GX	1" x 3/4" x 3/4"	3.04 [77]	2.47 [63]	1.36 [34]
QET545GX	1" x 3/4" x 1"	3.41 [87]	2.67 [68]	1.36 [34]
QET553GX	1" x 1" x 1/2"	3.20 [81]	2.20 [56]	1.36 [34]
QET554GX	1" x 1" x 3/4"	3.32 [84]	2.46 [62]	1.36 [34]
QET555GX	1" x 1" x 1"	3.79 [96]	2.69 [68]	1.36 [34]
QET654GX	1-1/4" x 1" x 3/4"	3.63 [92]	2.72 [69]	1.58 [40]
QET655GX	1-1/4" x 1" x 1"	3.87 [98]	2.94 [74]	1.58 [40]
QET663GX	1-1/4" x 1-1/4" x 1/2"	3.87 [98]	2.48 [63]	1.58 [40]
QET664GX	1-1/4" x 1-1/4" x 3/4"	3.88 [99]	2.72 [69]	1.58 [40]
QET665GX	1-1/4" x 1-1/4" x 1"	4.22 [107]	2.96 [75]	1.58 [40]
QET666GX	1-1/4" x 1-1/4" x 1-1/4"	4.55 [116]	3.20 [81]	1.58 [40]
QET754GX	1-1/2" x 1" x 3/4"	3.87 [98]	2.92 [74]	1.81 [46]
QET755GX	1-1/2" x 1" x 1"	3.98 [101]	3.17 [81]	1.81 [46]
QET757GX	1-1/2" x 1" x 1-1/2"	4.37 [111]	3.69 [94]	1.81 [46]
QET764GX	1-1/2" x 1-1/4" x 3/4"	4.13 [105]	2.92 [74]	1.81 [46]
QET765GX	1-1/2" x 1-1/4" x 1"	4.42 [112]	3.15 [80]	1.81 [46]
QET766GX	1-1/2" x 1-1/4" x 1-1/4"	4.69 [119]	3.43 [87]	1.81 [46]
QET773GX	1-1/2" x 1-1/2" x 1/2"	4.38 [111]	2.68 [68]	1.81 [46]
QET774GX	1-1/2" x 1-1/2" x 3/4"	4.38 [111]	2.92 [74]	1.81 [46]
QET775GX	1-1/2" x 1-1/2" x 1"	4.65 [118]	3.15 [80]	1.81 [46]
QET776GX	1-1/2" x 1-1/2" x 1-1/4"	4.89 [124]	3.42 [87]	1.81 [46]
QET777GX	1-1/2" x 1-1/2" x 1-1/2"	5.09 [129]	3.68 [93]	1.81 [46]
QET874GX	2" x 1-1/2" x 3/4"	4.87 [124]	3.74 [95]	2.56 [65]
QET875GX	2" x 1-1/2" x 1"	4.98 [127]	4.00 [102]	2.56 [65]
QET876GX	2" x 1-1/2" x 1-1/4"	5.22 [133]	4.26 [108]	2.56 [65]
QET877GX	2" x 1-1/2" x 1-1/2"	5.33 [135]	4.52 [115]	2.56 [65]
QET878GX	2" x 1-1/2" x 2"	5.87 [149]	4.96 [126]	2.56 [65]
QET883GX	2" x 2" x 1/2"	5.05 [128]	3.51 [89]	2.56 [65]
QET884GX	2" x 2" x 3/4"	5.28 [134]	3.74 [95]	2.56 [65]
QET885GX	2" x 2" x 1"	5.76 [146]	4.00 [102]	2.56 [65]
QET886GX	2" x 2" x 1-1/4"	5.80 [147]	4.24 [108]	2.56 [65]
QET887GX	2" x 2" x 1-1/2"	5.95 [151]	4.50 [114]	2.56 [65]
QET888GX	2" x 2" x 2"	6.90 [175]	4.96 [126]	2.56 [65]

TYPICAL CONNECTION SIZE		
Tee Port size	A	B
	in [mm]	in [mm]
1/2" EX PEX	0.38 [10]	0.61 [16]
3/4" EX PEX	0.60 [15]	0.87 [22]
1" EX PEX	0.80 [20]	1.11 [28]
1-1/4" EX PEX	0.96 [24]	1.36 [34]
1-1/2" EX PEX	1.08 [28]	1.49 [38]
2" EX PEX	1.55 [39]	2.08 [53]

Engineering Specification: Zurn PEX® XL-Low Lead Brass F1960 Expansion PEX Tee. The QET__GX is used with Zurn Non-Barrier Pex tubing in potable water applications. Not for use in reverse osmosis systems or in areas with known localized aggressive water chemistries. Manufactured from EcoBrass®, C69300. These fittings, as a system with Zurn PEX® tube and Zurn PEX reinforcing rings are pressure rated at 160 PSI at 73°F, 100 PSI at 180°F, and 80 PSI at 200°F. These fittings are 3rd Party certified as complying with the following standards: NSF/ANSI Standard 61, NSF/ANSI Standard 372 (Low Lead), ASTM F1960, CSA B137.5

Accessories

- ____ QER3X 1/2" PEX Expansion Reinforcing Ring w/Stop
- ____ QER4X 3/4" PEX Expansion Reinforcing Ring w/Stop
- ____ QER5X 1" PEX Expansion Reinforcing Ring w/Stop
- ____ QER6X 1-1/4" PEX Expansion Reinforcing Ring w/Stop
- ____ QER7X 1-1/2" PEX Expansion Reinforcing Ring w/Stop
- ____ QER8X 2" PEX Expansion Reinforcing Ring w/Stop
- ____ QEMT345 F1960 Manual Expansion Tool Kit - 1/2" to 1"