

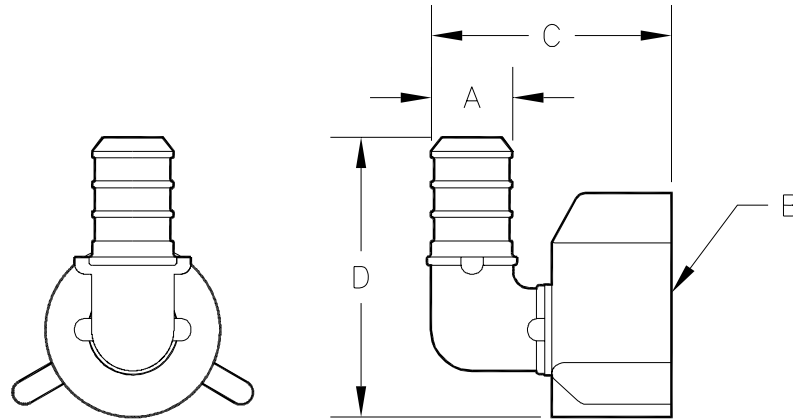

QickSert CR™ Barb x 1/2" Female Thread Swivel Elbow - QQPE__BSX Specification Sheet

Tag _____

Dimensional Data: Inches and [mm] are subject to manufacturing tolerances and change without notice.



Part Number	Description	'A' in [mm]	'B' in [mm]	'C' in [mm]	'D' in [mm]
QQPE33BSX	1/2" Barb x 1/2" Female Swivel Elbow Adapter	0.473" [12.0]	1/2" - 14	1.41" [35.8]	1.87" [47.5]
QQPE44BSX	3/4" Barb x 3/4" Female Swivel Elbow Adapter	0.668" [17.0]	3/4" - 14	1.57" [39.9]	2.13" [54.1]

Engineering Specification: ZurnPEX® QickSert CR™ Barb x female thread swivel elbow. The QQPE__BSX adapter is used to transition from PEX to male pipe threads. Molded from Acudel®. These fittings, as a system with Zurn PEX® tube, are pressure rated at 160 PSI at 73°F, 100 PSI at 180°F, and 80 PSI at 200°F. These fittings are listed by NSF as complying with the following standards: NSF/ANSI Standard 14, NSF/ANSI Standard 61, ASTM F877, and CSA B137.5, and ASTM F2159.

Accessories

- ___ **QCLP3X** 1/2" QickClamp™ Crimp Ring
- ___ **QCLP4X** 3/4" QickClamp™ Crimp Ring
- ___ **QCR3X** 1/2" Copper Crimp Ring
- ___ **QCR4X** 3/4" Copper Crimp Ring

Rev. A	Date: 06/26/08	C.N. No. 98692
Dwg. No. 82189		Prod. No. QQPE__BSX