



FD2

5" Top Assembly Adjustable Floor Drain with Deck Plate

SPECIFICATION SHEET

TAG _____

**PATENT
PENDING**

Dimensional Data (inches and [mm]) are Subject to Manufacturing Tolerances and Change Without Notice

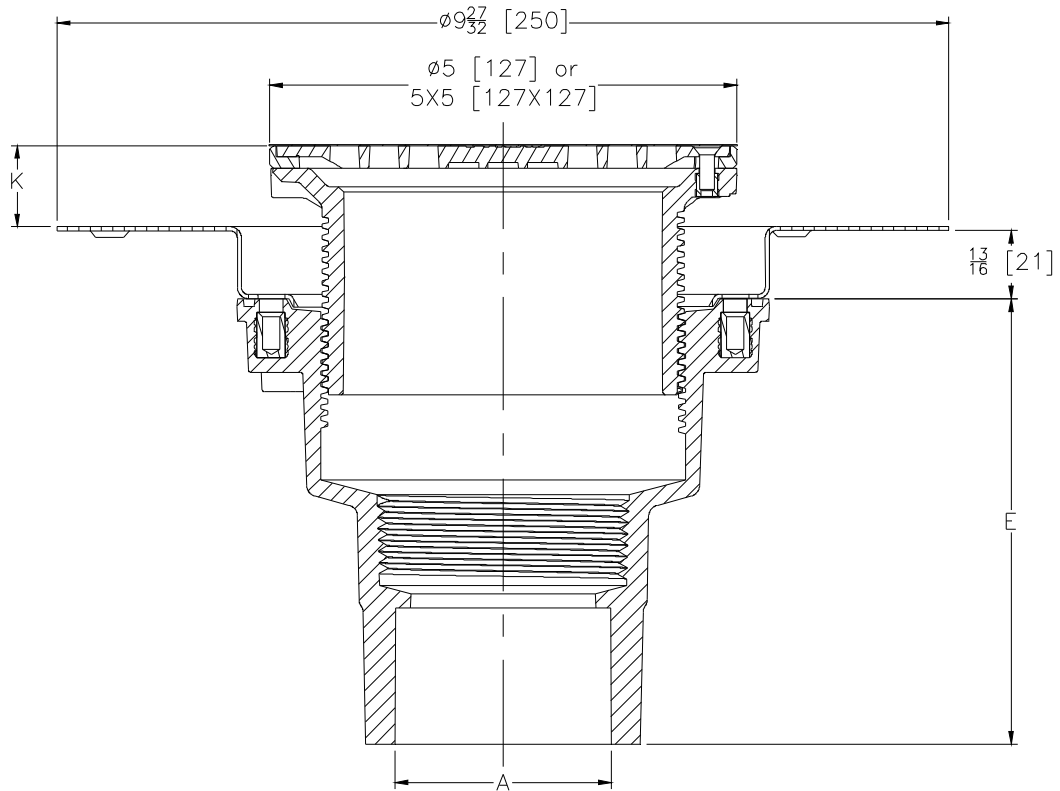

Dimensions in Inches [mm]						Approx. Wt. Lbs [kg]	Strainer Open Area Sq. In. [cm ²]	Strainer Type
Product Number		A	E	K				
PVC Body	ABS Body	Pipe Size	Body Height	Min	Max			
FD2-PV2	FD2-AB2	2-3 [51-76]	4-15/16 [125]	0	1-7/16 [37]	5 [2]	6-1/4 [40]	Nickel Bronze Round
FD2-PV3	FD2-AB3	3-4 [76-102]	3-25/32 [96]	0	1-7/16 [37]	5 [2]	6-1/4 [40]	Nickel Bronze Round
FD2-PV2-ST	FD2-AB2-ST	2-3 [51-76]	4-15/16 [125]	7/16 [11]	1-11/16 [43]	6 [3]	9 [58]	Nickel Bronze Square
FD2-PV3-ST	FD2-AB3-ST	3-4 [76-102]	3-25/32 [96]	7/16 [11]	1-11/16 [43]	6 [3]	9 [58]	Nickel Bronze Square
FD2-PV2-SS	FD2-AB2-SS	2-3 [51-76]	4-15/16 [125]	0	1-7/16 [37]	5 [2]	6-1/4 [40]	Stainless Steel Round
FD2-PV3-SS	FD2-AB3-SS	3-4 [76-102]	3-25/32 [96]	0	1-7/16 [37]	5 [2]	6-1/4 [40]	Stainless Steel Round
FD2-PV2-ST-SS	FD2-AB2-ST-SS	2-3 [51-76]	4-15/16 [125]	7/16 [11]	1-11/16 [43]	6 [3]	9 [58]	Stainless Steel Square
FD2-PV3-ST-SS	FD2-AB3-ST-SS	3-4 [76-102]	3-25/32 [96]	7/16 [11]	1-11/16 [43]	6 [3]	9 [58]	Stainless Steel Square

ENGINEERING SPECIFICATION:

Zurn FD2 floor and shower drain, PVC or ABS solvent weld body with bottom outlet and 1/2" [13] trap primer connection knock-out plug, stainless steel deck plate, and top assembly. FD2 drainage series is available with a square or round light duty strainer in nickel bronze or stainless steel.

SUFFIXES

- ___ -CC Stainless Steel Clamp Collar
- ___ -EF 3/4 [19] Extension Frame
- ___ -FI Floor Insert (For Round Top Assembly Only)
- ___ -TSP Trap Seal Protection Device
(Size Matches Outlet Selected)
(See Z1072)
- ___ -U 2 - 3-1/4 [51-83] High Extension Adapter
- ___ -VP Vandal-Proof Secured Top
- ___ -Y Sediment Bucket