

**313-1.2L-AUT-★**

Wall Mounted Automatic Faucet

★ See next page for function options

Not temperature control – water must be premixed

Flow Rate: 1.2 GPM

Hole Diameter: 1 7/8 – 2 1/8"

Note: Sensor box may be installed a maximum of 12" linear from center of inlet.

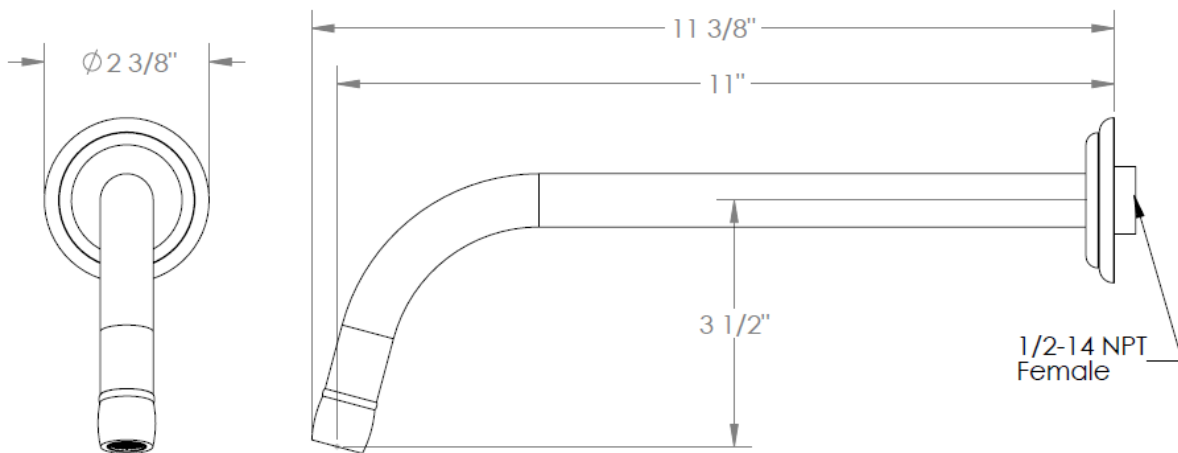

# AUT1.2-W-RGH

Automatic Faucet System

Requires 1 pc of CR-P2 6V Battery

**BATTERY NOT INCLUDED**

WTM2 and WPM4: 12s metering cycle

| ★ Function Options |                   |
|--------------------|-------------------|
| Code               | Function          |
| WT1                | Touch on/off      |
| WTM2               | Metered touch     |
| WP3                | Touchfree         |
| WPM4               | Metered touchfree |

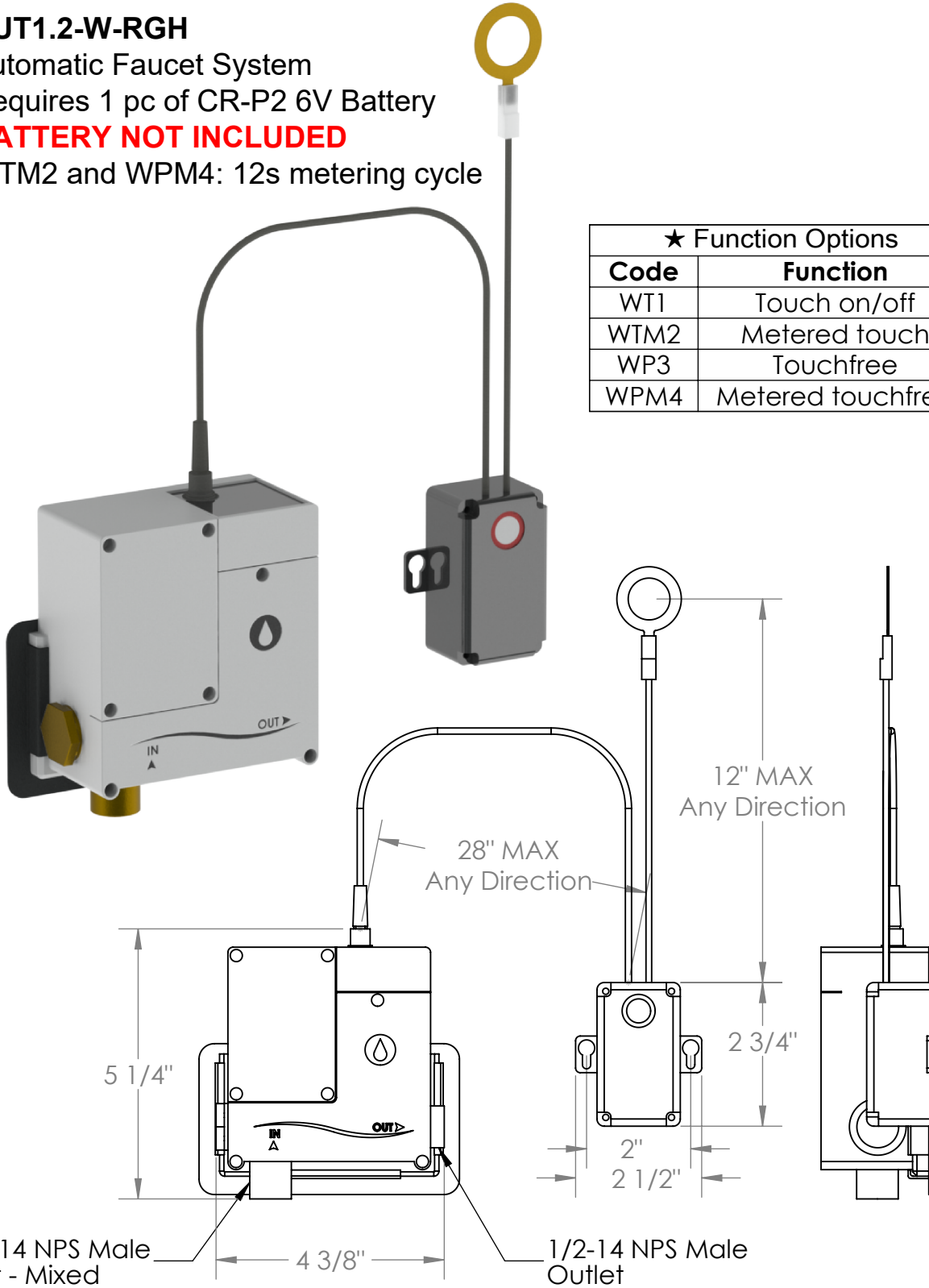

Meets the applicable requirements of ASME A112.18.1-2005/CSA B125.1-05, entitled "Plumbing Supply Fittings"