

BOND

B3P12S

Bond Rally Series Three Way Pressure Balance Diverter Trim
with Roman Numerals and Lever Handle

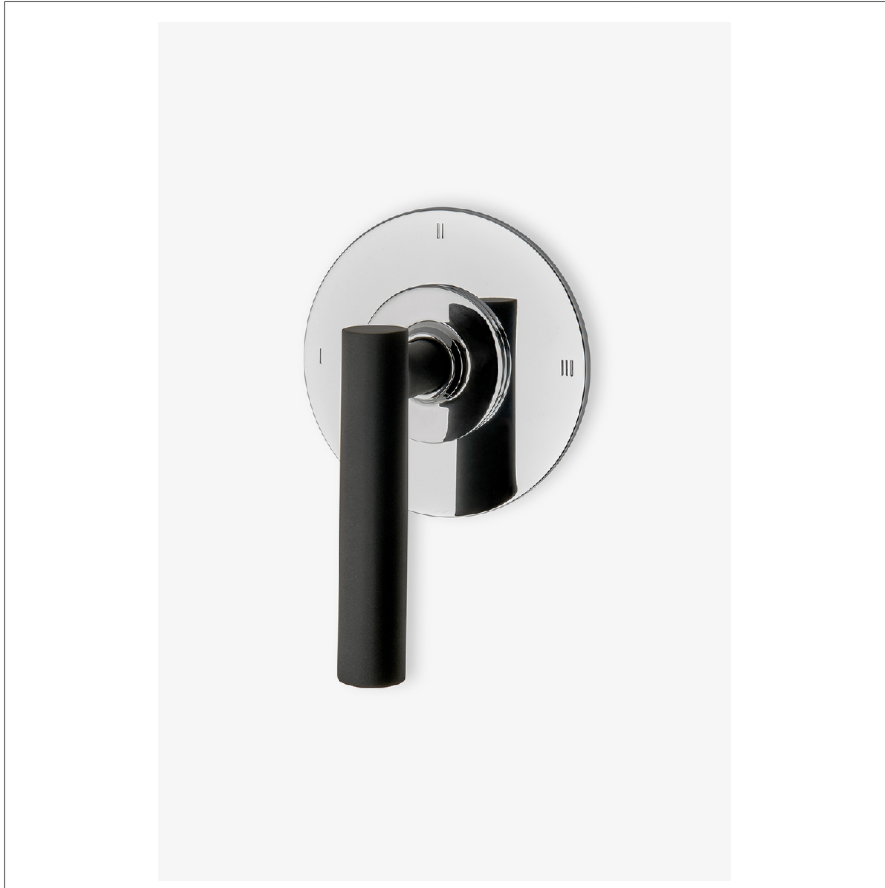

SHOWN IN BOND RALLY SERIES THREE WAY PRESSURE BALANCE DIVERTER TRIM WITH ROMAN NUMERALS AND LEVER HANDLE
| B3P12S

TECHNICAL DETAILS

ADA Compliance: Yes
Fittings Hole Diameter: 2"
Number Of Holes: One Hole
Primary Material: Brass

INSPIRATION

Modern designs infused with rare soul and artistry. Explore our wide range of Bond bath and kitchen elements, from fittings to fixtures to hardware.

CODES & STANDARDS

PRODUCT FEATURES

Lever Handle

For use with a Pressure Balance shower system and three waterway outlets such as a handshower, shower head, or tub spout

Features a Sport Black Finish, smooth and velvety to the touch

Stocked in Chrome/Sport Black

Requires rough valve, sold separately: GUDV65 (USA) or GU65DV (UK/International)

CERTIFICATIONS

PRODUCT (NOTES)

BOND

B3P12S

Bond Rally Series Three Way Pressure Balance Diverter Trim
with Roman Numerals and Lever Handle

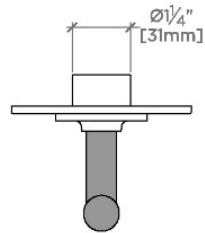

TOP VIEW

SCALE: 3"=1'-0"

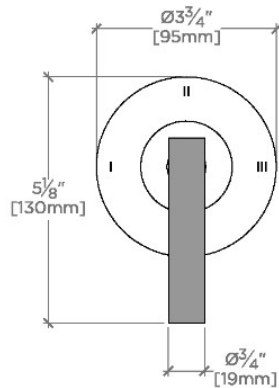

FRONT VIEW

SCALE: 3"=1'-0"

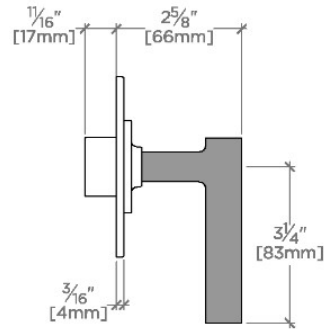

SIDE VIEW

SCALE: 3"=1'-0"