

BOND

BKM12D

Bond Union Series One Hole Gooseneck Integrated Pull Spray Kitchen Faucet with Enamel Guilloche Lines Lever Handle



SHOWN IN BOND UNION SERIES ONE HOLE GOOSENECK INTEGRATED PULL SPRAY KITCHEN FAUCET WITH ENAMEL GUILLOCHE LINES LEVER HANDLE | BKM12D

INSPIRATION

Modern designs infused with rare soul and artistry. Explore our wide range of Bond bath and kitchen elements, from fittings to fixtures to hardware.

PRODUCT FEATURES

Lever Handle

Two Function Integrated Pull Spray operated by a sliding button, switches from aerated stream to jet spray. The button returns to aerated stream when disengaged and remains in spray mode without holding down
Features Guilloche Lines combined with Enamel Handle

Stocked in Nickel and Brass

Available in 1.75gpm (6.6L/min) flow rate

TECHNICAL DETAILS

ADA Compliance: Yes
Adjustable Versus Fixed Spray: Adjustable
Deck Thickness Maximum: 2 1/4"
Deck Thickness Minimum: 1/4"
Fittings Hole Diameter: 1 1/2"
Handle Turn Angle: Tilt and Turn
Handshower Spray Hose Length: 59"
Inlet Connection Size: 3/8"
Inlet Connection Type: Compression Connection Hoses
Integrated Diverter: Y
Restricted Maximum Flow Rate: 1.75 gpm
Spout Swivel: Y
Spray Included In Unit: Y
Valve Material: Ceramic
Water Pressure Maximum: 85.0 psi
Water Pressure Minimum: 25.0 psi
Water Pressure Recommended: 45.0 psi

CODES & STANDARDS

NSF/ANSI/CAN 61:Q < 1, ASME A112.18.1/CSA B125.1, State of MA

CERTIFICATIONS



PRODUCT (NOTES)

WATERWORKS

BOND

BKM12D

Bond Union Series One Hole Gooseneck Integrated Pull
Spray Kitchen Faucet with Enamel Guilloche Lines Lever
Handle

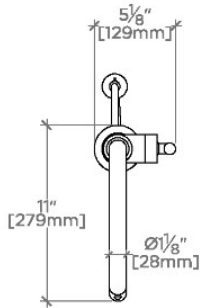

TOP VIEW

SCALE: 1"=1'-0"

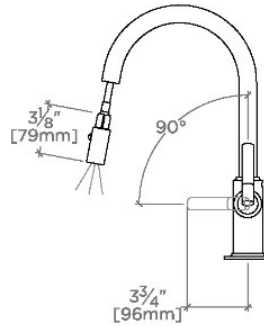

SPRAY AND HANDLE OPERATION

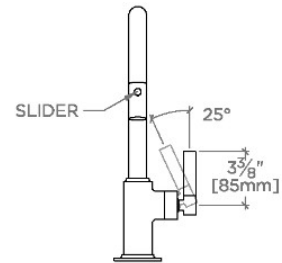

SCALE: 1"=1'-0"

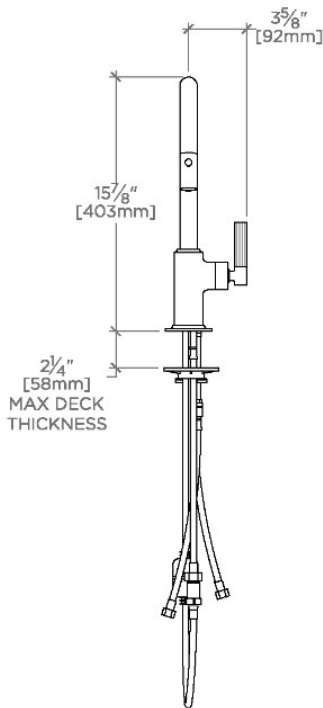

FRONT VIEW

SCALE: 1"=1'-0"

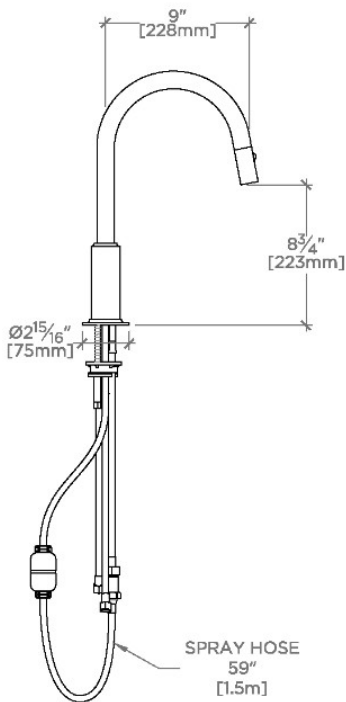

SIDE VIEW

SCALE: 1"=1'-0"

NOTE:
ADAPTER AND GASKET (x2) INCLUDED -
INTERNATIONAL USE ONLY

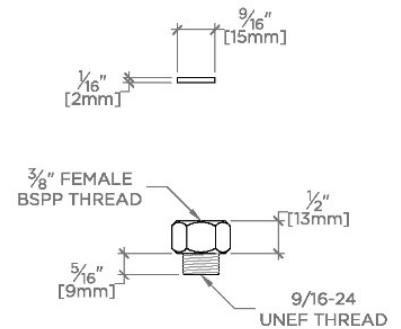

ADAPTER

NOT TO SCALE