

INSTALLATION GUIDELINES

UNIVERSAL SINGLE OR DOUBLE SIDED GLASS MOUNT ADAPTER

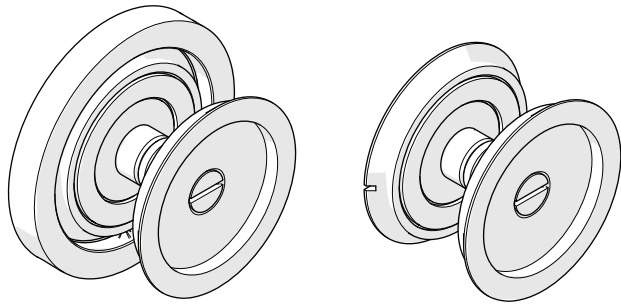

STYLES	
100725	100726

IMPORTANT:

- To ensure this product is installed properly, you must read and follow these guidelines.
- The owner/user of this product must keep this information for future reference.
- This product must be installed by a professional licensed contractor.
- This product can be installed on glass that is 1/4" [6mm], 3/8" [10mm], 1/2" [13mm], or 3/4" [19mm] thick.
- This product requires a 1/2" [13mm] hole for proper installation. If using this product with a TOWEL BAR or SHELF, verify the on-center spread of the specific product being used **before** drilling the 1/2" [13mm] holes.
- To avoid damaging the product, do NOT use power tools during installation.
- If further assistance is required, please contact Product Support at 1-800-927-2120 Monday through Friday, 8am - 6pm EST.

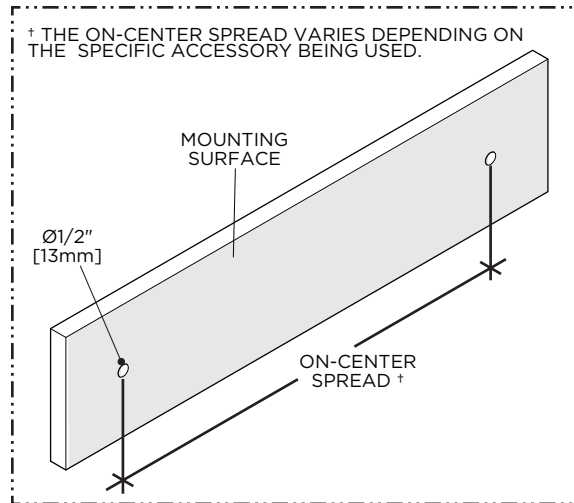

1. Ensure any pre-drilled hole is a 1/2" [13mm]. For ACCESSORIES with 2 mounting holes, ensure the holes are level and at the proper on-center spread.

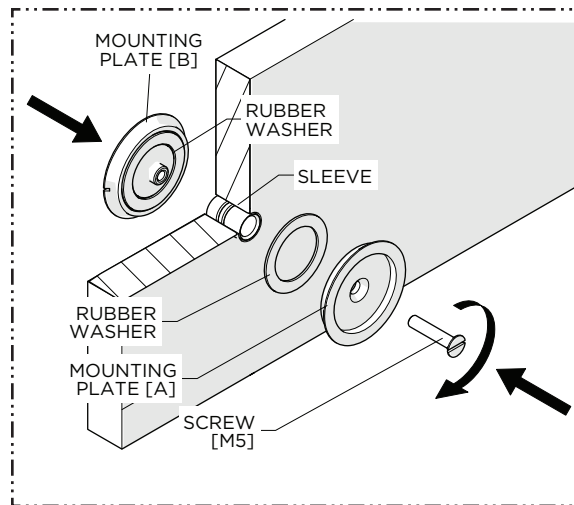

3. Insert the SLEEVE into the pre-drilled hole then reassemble the ADAPTER using the SCREW provided.

NOTE: The SLEEVE can be cut and two SCREWS [M5] are provided to accommodate different glass thicknesses.

WATERWORKS

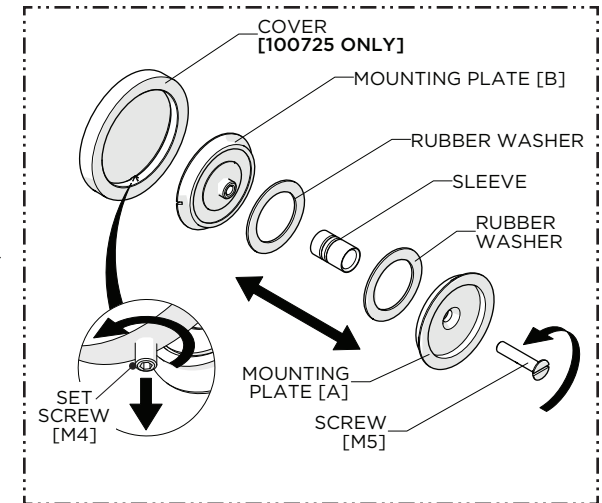

2. Disassemble the components by unthreading the SCREW on the MOUNTING PLATE [A].

NOTE: Remove the COVER used on style number 100725 by loosening the SET SCREW.

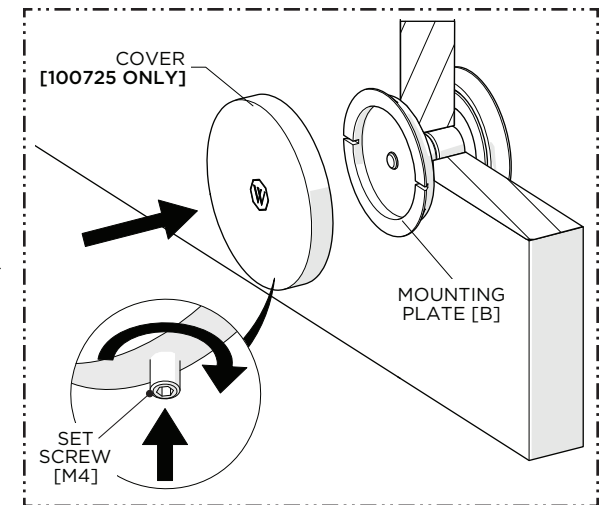

4. If used, reattach the COVER.

➤ **FINISH THE INSTALLATION FOLLOWING THE GUIDELINES PROVIDED WITH THE ACCESSORY BEING USED. THE MOUNTING PLATE(S) PROVIDED WITH THE ACCESSORY CAN BE DISCARDED.**