

# INSTALLATION GUIDELINES

## UNIVERSAL SHOWERHEAD

### IMPORTANT:

- To ensure this product is installed properly, you must read and follow these guidelines.
- The owner/user of this product must keep this information for future reference.
- This product must be installed by a professional licensed contractor and must be on-site prior to rough-in, this allows the installer to visualize the installation.
- Be sure your installation conforms to federal, state, and local codes. In the State of Massachusetts, all installations must comply with the rules and regulations set forth within 248 CMR.
- Inspect this product to ensure you have all the parts required for proper installation.
- Use only a strap wrench or protected/smooth-jaw wrench on any finished surface.
- The use of certain plumber's putty may stain stone or tile surfaces.
- If further assistance is required, please contact Product Support at 1-800-927-2120 Monday through Friday, 8am - 6pm EST.
- For use with VALVES rated at 1.3gpm [4.9L/min] or higher.
- Showerheads larger than 6" are not recommended for use with the Universal Wall Mounted 45 Degree Shower Arms.

### TECHNICAL DETAILS:

INLET CONNECTION	1/2" FEMALE THREADS WITH RUBBER WASHER
INTEGRATED DIVERTER	NO
PIVOT	YES
WATER PRESSURE RANGE	20psi [1.5 bar] <b>MIN</b> 85psi [6.0 bar] <b>MAX</b>
WATER PRESSURE RECOMMENDED	45psi [3.0 bar]

### WALL INSTALLATION SHOWN:

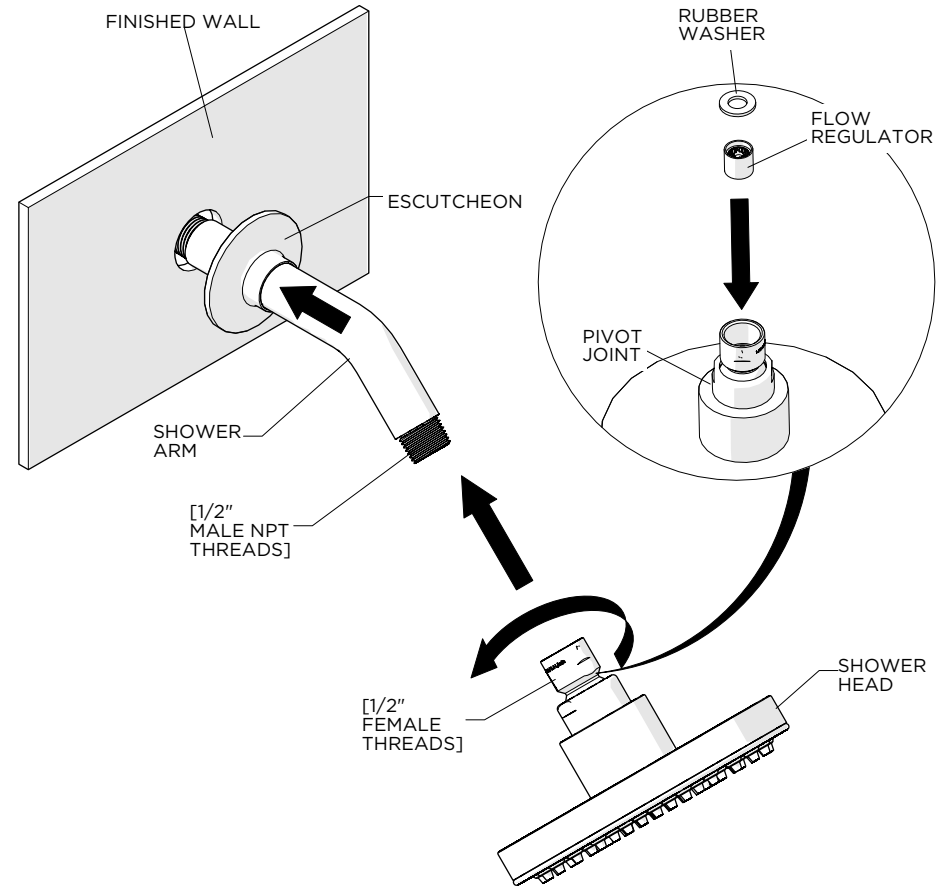

1. Flush out the supply line prior to installing the SHOWERHEAD.
2. Thread and securely tighten the PIVOT JOINT onto the SHOWER ARM, making sure to use the RUBBER WASHER provided.  
**NOTE:** A FLOW REGULATOR is located inside the PIVOT JOINT.
3. Run water through the SHOWERHEAD and ensure it pivots and functions properly.  
**NOTE:** Some SHOWERHEADS have adjustable spray features.
4. Check for leaks and complete the installation.