

**STYLE No.** GUDV14†  
**CODE No.** GUSV14R

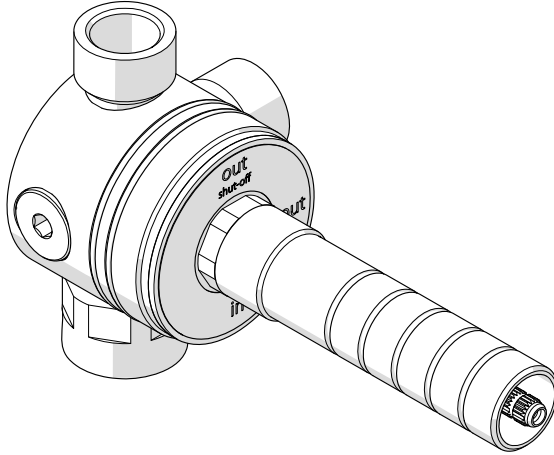

## SPECIFICATIONS:

<b>Fitting Hole Diameter</b>	Ø2 1/2" * (Ø 63.5mm)
<b>Inlet Connection Size &amp; Type:</b>	3/4" Female NPT†
<b>Outlet Connection Size &amp; Type:</b>	1/2" Female NPT†
<b>Recommended Water Pressure:</b>	45 psi (3 Bar)
<b>Unrestricted Maximum Flow Rate:</b>	14 gpm @ 45 psi (53 L/min @ 3 Bar)
<b>Valve Material:</b>	Ceramic
<b>Water Pressure:</b>	20 psi MIN - 80psi MAX (1.4 Bar Min - 5.5 Bar Max)

\* Ø2 1/2" hole is required for servicing the valve

† UK Style No. **GU14DV** supplied with 3 **BSP** Adapters, assembly required.

## REQUIRED PLUMBING DETAILS:

Universal Two Way Thermostatic Diverter Valve Trim

**STYLE No.** UNDV2T

Universal Thermostatic Valve

**STYLE No.** GUTH37 or,

Universal 1/2" Thermostatic Valve

**STYLE No.** GUTH56 or,

.25 Thermostatic Valve

**STYLE No.** GUTH78

## IMPORTANT:

- To ensure this product is installed properly, you must read and follow these guidelines.
- The owner/user of this product must keep this information for future reference.
- This product can only be used with either the Universal Thermostatic Valve (GUTH37), the Universal 1/2" Thermostatic Valve (GUTH56) or the .25 Thermostatic Valve (GUTH78).
- This valve requires a compatible wall valve trim and trim plate. ALL PRODUCTS SOLD SEPARATELY.

- This product, the thermostatic valve (GUTH37, GUTH56 or GUTH78) and the associated trims must be on-site prior to rough-in. This allows the installer to visualize the installation.
- Inspect this product to assure you have all the parts required for proper installation.
- Refer to the specification and assembly drawings attached. Product is sold partially assembled but shown fully disassembled for illustrative and service purposes only.
- This product must be installed by a professional licensed contractor. Be sure your installation conforms to all federal, state, and local codes. In the State of Massachusetts, all installations must comply with the rules and regulations set forth within 248 CMR.
- Check incoming water pressure.

## FUNCTION:

- The Thermostatic Valves (GUTH37, GUTH56 and GUTH78) only mix hot and cold water, they do not have an on/off or volume control function. Mixed water flows out at a fixed volume to the diverter valve (GUDV14) which has 3 positions:

2 that can direct water flow to a maximum of 2 devices. Water **cannot** flow out of the devices simultaneously (i.e. out of the shower head AND handshower together).

1 position that shuts the water off to all devices.

## ROUGH-IN:

- Valve **rough-in depth** is measured from the centerline of the inlets to the surface of the finished wall and varies depending on the trim and thermostatic valve being used.

### GUDV14 with GUTH37 Rough-In Depth:

Trim	Rough-In Depth
.25, Flyte, Opus & R.W. Atlas	3 1/8" MIN - 4-1/8" MAX (79mm MIN - 104mm MAX)
Formwork	3 1/8" MIN - 4 3/4" MAX (79mm MIN - 121mm MAX)
Henry	2 7/8" MIN - 4 1/8" MAX (73mm MIN - 104mm MAX)
All Other	2 1/2" MIN - 4 1/8" MAX (64mm MIN - 104mm MAX)

### GUDV14 with GUTH56 Rough-In Depth:

All Other	3 1/4" MIN - 4 1/4" MAX (83mm MIN - 108mm MAX)
-----------	---

### GUDV14 with GUTH78 Rough-In Depth:

All Other	3 1/8" MIN - 4 1/8" MAX (79mm MIN - 104mm MAX)
-----------	---

These guidelines have been prepared for the professional contractor to aid in the installation of:  
UNIVERSAL TWO WAY DIVERTER WITH SHUTOFF VALVE  
STYLE No. GUDV14, GU14DV (UK).  
All dimensions are based on original specification and are subject to change and variation.  
Please consult your Design Associate for current specifications.

W A T E R W O R K S

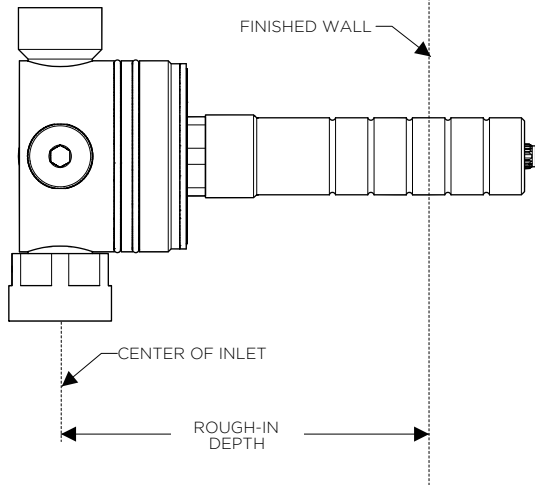

➤ You **must** have the thermostatic valve (GUTH37, GUTH56 or GUTH78) on hand in order to install this diverter valve.

1. Make sure the valve is positioned according to the valve markings with the inlet port situated so that mixed water flows into the inlet.

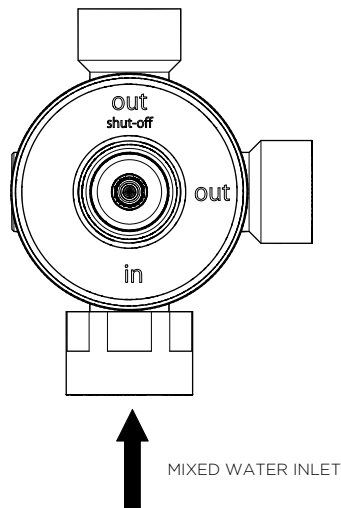

2. Rough-in the diverter valve to an appropriate depth based on the trim being used.
3. The cartridge stem and threaded tube on the diverter valve can be cut to various lengths depending on the style of trim. **Refer to the Installation Guidelines of individual trims for cutting dimensions and related information.**

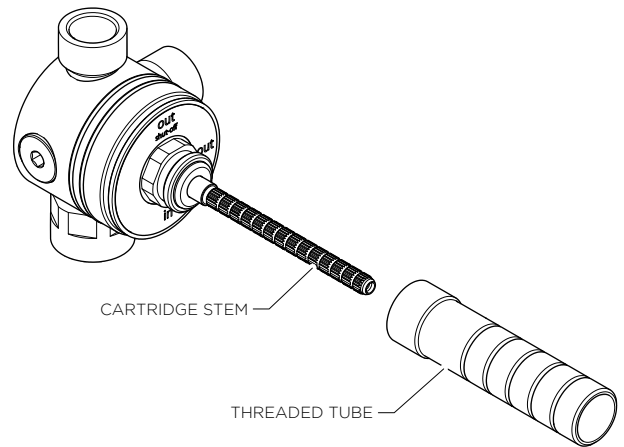

4. After the rough-in is completed, turn on the hot and cold supplies then check for leaks. Allow the water to run so the lines can be flushed completely.
5. Verify all the valves are functioning properly.
6. Attach the stem extension to the cartridge stem with the screw then install the tile guard.

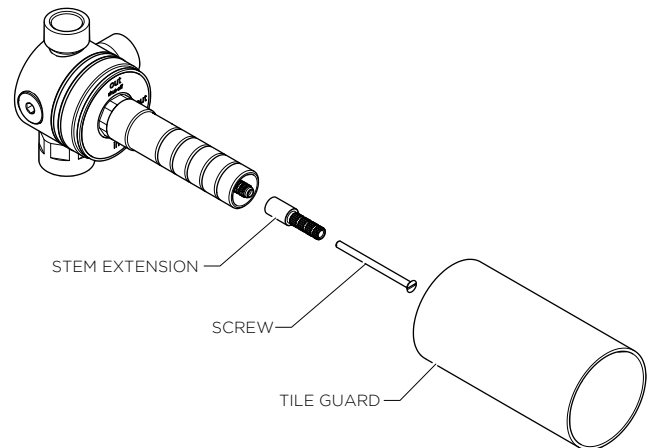

- If further assistance is required, please contact Product Support at 1-800-927-2120 (8am-6pm EST).
- See the service part document for parts ordering, available on [WATERWORKS.COM](http://WATERWORKS.COM).

† BSP Adapter can be ordered separately:

- (1x) **STYLE No. UNUK01**  
**ITEM No. 45-57632-24328**
- (2x) **STYLE No. UNUK02**  
**ITEM No. 45-57632-24328**