



ADJUSTABLE OPERATING ROD

Prevents Faucet Tube From Bursting in Freezing Conditions!

(Fits Woodford Models 14, 16, 17, 19, 22 or V22)

RK-ADJ-PRV

INCLUDES ANTI-BURST PRV VALVE

- Upgrade a Woodford Model 14 or 17 wall faucet or replace a Model 16, 19 or 22 operating rod with an RK-ADJ-PRV Adjustable Length Operating Rod with patented, resetting Pressure Relief Valve (PRV).
- The PRV is designed to prevent the copper tube from bursting in freezing conditions *even if a hose is unintentionally left on.*

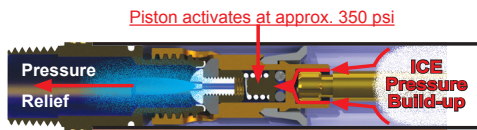

- Arrange and assemble a combination of color coded rod stems to create a replacement operating rod. Rod assemblies fit Woodford models with 4" to 14" wall thickness.
- Sample installation instructions are shown below. *Complete full scale instructions are provided with each RK-ADJ-PRV.*

RK-ADJ-PRV Components
NOT SOLD SEPARATELY

- (1) Inlet Stem
- (1) Middle Stem
- (1) Handle Stem
- (1) Stem Stop
- (2) Stainless Steel Clips
- (1) EPDM Packing
- (1) Packing Nut
- (1) Round Metal Wheel Handle
- (1) Handle Screw

See Reverse Side For More Faucet Accessories

Installation Instructions

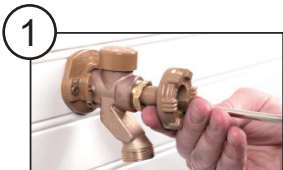

- 1
- Shut off water supply
 - Remove Handle Screw, Handle, Packing Nut and Packing.
 - Use flat head screwdriver to remove packing material.

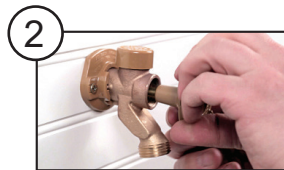

- 2
- Place handle back on rod without screw and turn counter-clockwise.
 - Remove old rod.
 - Save and reuse old brass washer

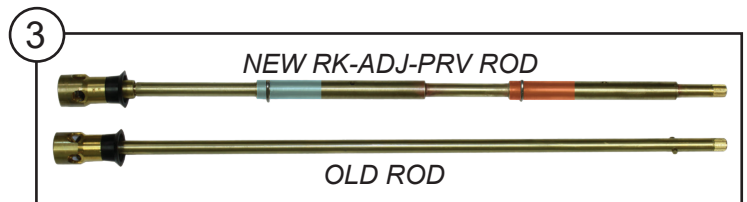

- 3
- Match old rod length with the new RK-ADJ-PRV rod assembly combination using chart below.

Assembly Combinations According To Measured Operating Rod Overall Length

Note: Lengths are not to scale. A detailed, full scale, diagram is included with each RK-ADJ-PRV.

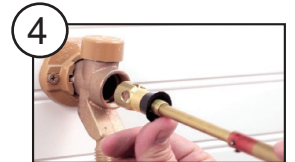

- 4
- Insert new RK-ADJ-PRV
 - Assemble old brass washer, new Packing, Packing Nut, Handle and Handle Screw.
 - Turn on water.

OVER SIZED FLANGE

RK-OSF



RK-OSF Parts:

1. Over Sized Flange - Top
2. Over Sized Flange - Bottom
3. Mounting Screws (2)

Hole in the wall?

- Whether updating an old faucet with a new Woodford freezeless faucet or improving an existing installation, the new **RK-OSF** Over Sized Flange can cover a larger hole due to previous installation plus secure the faucet to a solid surface.
- The **RK-OSF** can be attached to any new or existing Woodford Model 14, 16, 17, 19 & 101 wall flange.
- Outer holes are spaced a full 3 1/2" apart for better mounting screw contact in masonry or siding.

New Installation

1. Join the (2) RK-OSF halves around the faucet tube and behind the existing faucet flange.
2. Fasten flanges together using (2) included screws.
3. Position the faucet through the wall and secure with proper type and length screws.

Repair Installation

1. Remove any screws from the existing faucet flange.
2. Be sure the wall flange can be pulled 3/8" away from the wall.
3. Slip the Top and Bottom OSF halves behind the existing faucet flange.
4. Align the 2 inner OSF holes with the existing faucet flange holes and secure with (2) included screws.
5. Install (2) screws through the outer OSF holes to secure faucet onto wall.

STEM LOCK Vandal Resistant

SL-17



STOP Water Theft!

- The **SL-17** Stem Lock converts Woodford Model 14, 16, 17, 19, 22, V22 & 30 wall faucets into vandal resistant, tee key operated units.
- Simply remove the handle and packing nut and install the deep locking nut then snap on the cylinder lock. The faucet is now locked and secure.
- Use key to unlock and use the Tee Key to operate faucet.

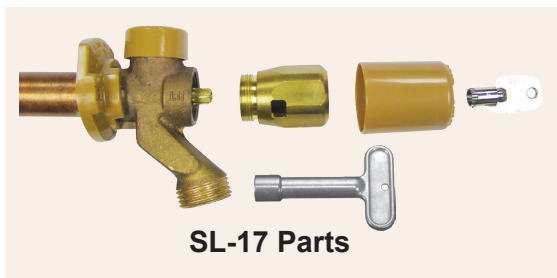

SL-17 Parts

Woodford Manufacturing Company
2121 Waynoka Road
Colorado Springs, CO 80915 USA
800-621-6032
800-765-4115 (Fax)
sales@woodfordmfg.com
www.woodfordmfg.com

© Woodford Mfg. Co. 2019
Printed in the U.S.A.