

OG011A 60.7x21.7

Height: 60.7
Width: 21.7
Depth: 6.6
Weight HO: 29.8lbs (13.5kg)
EO: 43.0lbs (19.5kg)

Tube ϕ : 1.26 Hex
Output @ 50° C Δ T: 318
Elec. element if specified: n/a
Face-Face Connections: 14.9

All dimensions in inches

Manufactured from ISO/CEN CuZn36As (BS CZ126) brass tube

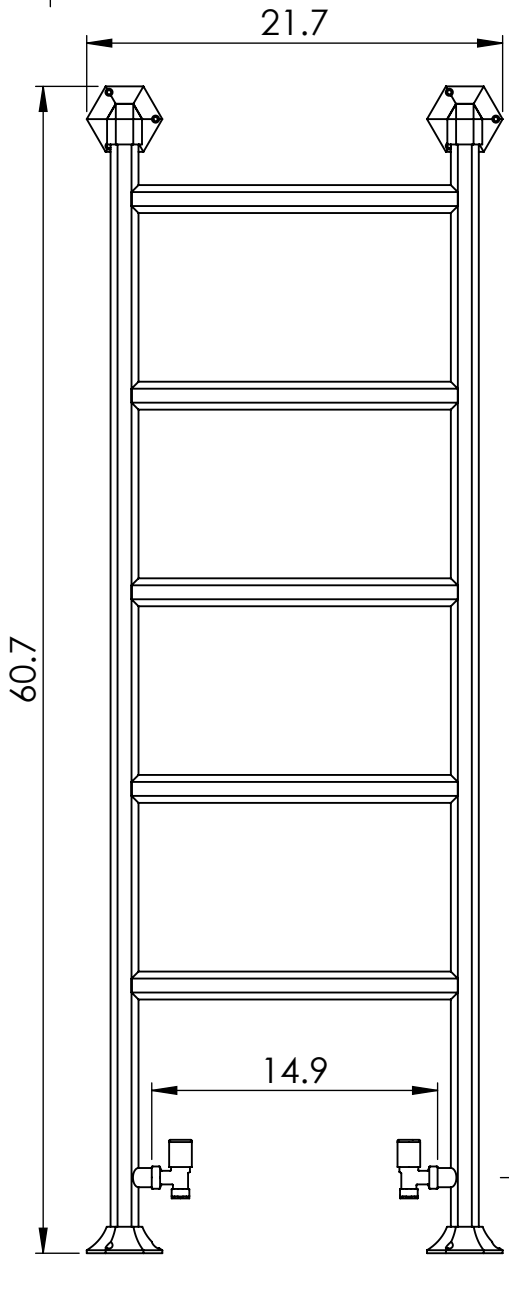
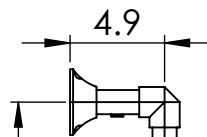
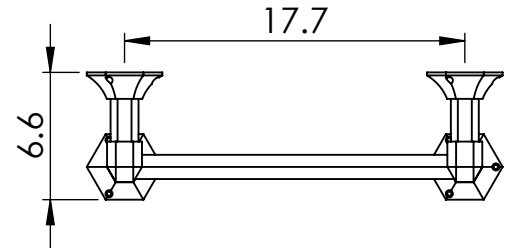
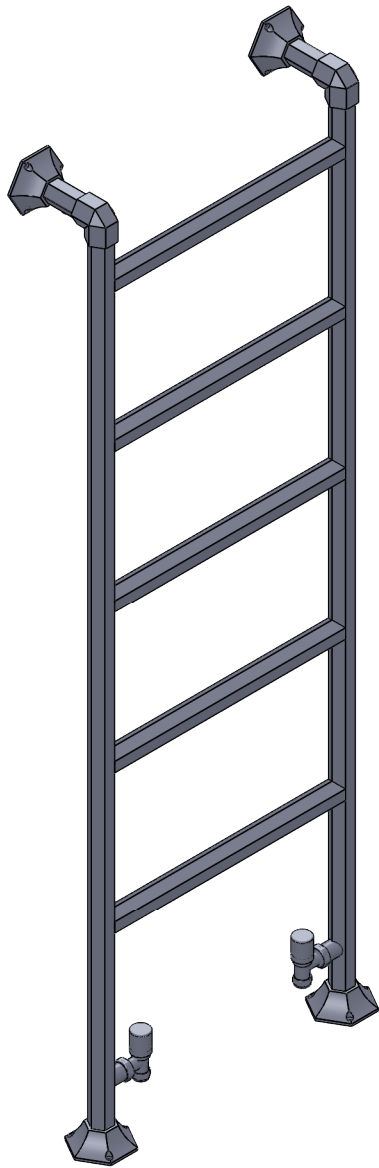

59.0

60.7

inches	mm
60.7	1543
21.7	550
6.6	168
59.0	1498
17.7	450
4.9	125
14.9	378
3.9	100

Vogue UK Ltd. reserve the right to alter specifications without prior notice.
ALL MEASUREMENTS ARE NOMINAL DIMENSIONS ONLY, AND ARE NOT BINDING.



SCALE 1:10

VOGUE

TOWEL DRYERS

175 Memorial Drive Unit C
Shrewsbury MA 01545 USA
Tel: 508 887 8771 Fax: 508 887 8774
e-mail: info@vogueuk.com www.vogueuk.com