



**T&S BRASS AND BRONZE WORKS, INC.**  
 2 Saddleback Cove / P.O. Box 1088  
 Travelers Rest, SC 29690

Model No.  
**HW-4C-72VB**

Item No.

Travelers Rest, SC: 800-476-4103 • Simi Valley, CA: 800-423-0150 • Fax: 864-834-3518 • www.tsbrass.com

This Space for Architect/Engineer Approval

Job Name \_\_\_\_\_ Date \_\_\_\_\_  
 Model Specified \_\_\_\_\_ Quantity \_\_\_\_\_  
 Customer/Wholesaler \_\_\_\_\_  
 Contractor \_\_\_\_\_  
 Architect/Engineer \_\_\_\_\_

# SAFE·T·LINK

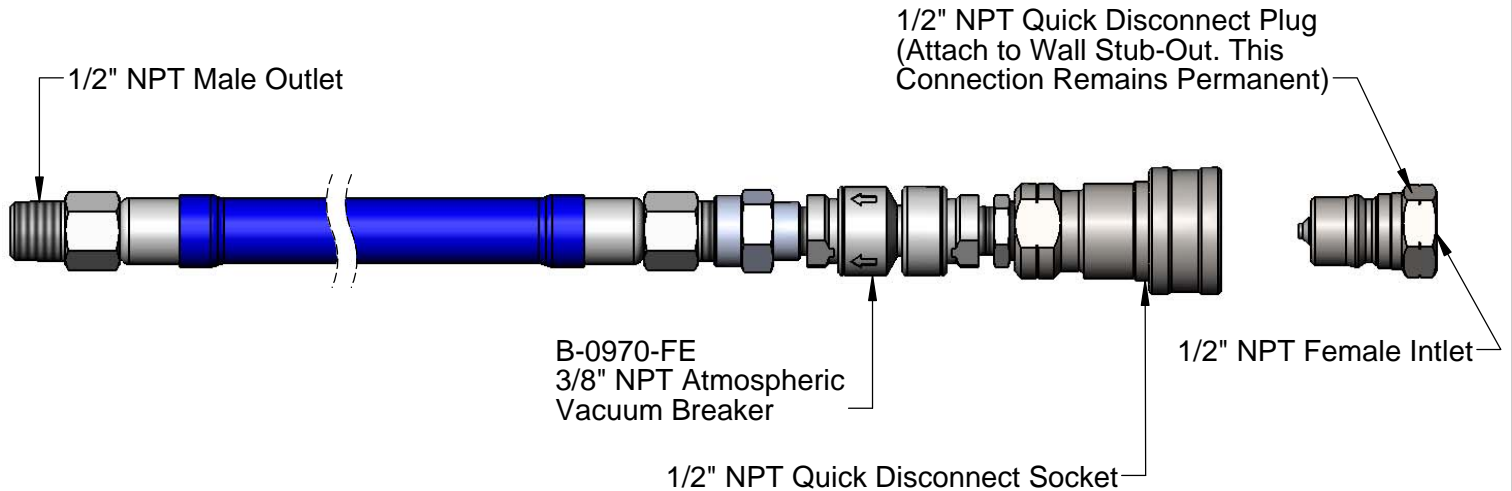
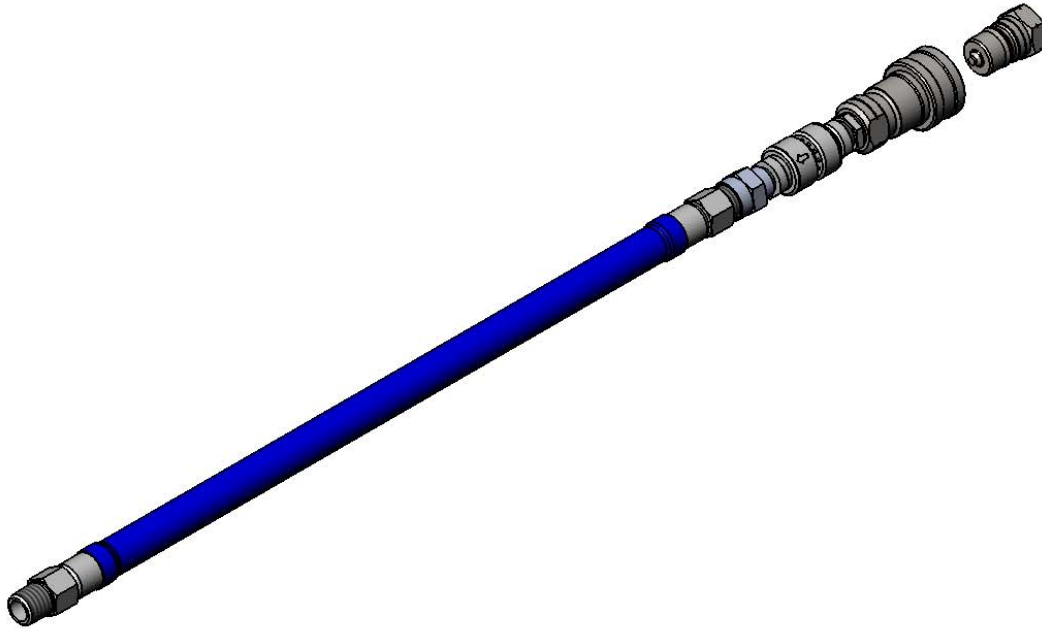

Product Specifications:  
 1/2" NPT x 72" Water Hose w/ Quick Disconnect & Vacuum Breaker

Product Compliance:  
 ASME A112.18.1 / CSA B125.1  
 NSF 61 - Section 9  
 NSF 372 (Low Lead Content)  
 CSA B64.8 (VB)



**T&S BRASS AND BRONZE WORKS, INC.**  
 2 Saddleback Cove / P.O. Box 1088  
 Travelers Rest, SC 29690

Model No.  
**HW-4C-72VB**

Item No.

Travelers Rest, SC: 800-476-4103 • Simi Valley, CA: 800-423-0150 • Fax: 864-834-3518 • www.tsbrass.com

ITEM NO.	SALES NO.	DESCRIPTION
1	001995-25	1/2" NPT x 3/8" NPT Adapter
2	002535-25	3/8" Close Nipple
3	B-0970-FE	3/8" NPT Vacuum Breaker
4	001359-40	Hex Bushing, 1/2" NPT Male x 3/8" NPT Female
5	AW-5C	Water Appliance Connector 1/2" NPT Stainless Steel Quick Disconnect Socket/Plug
6	HW-2C-72	1/2" NPT x 72" Water Hose

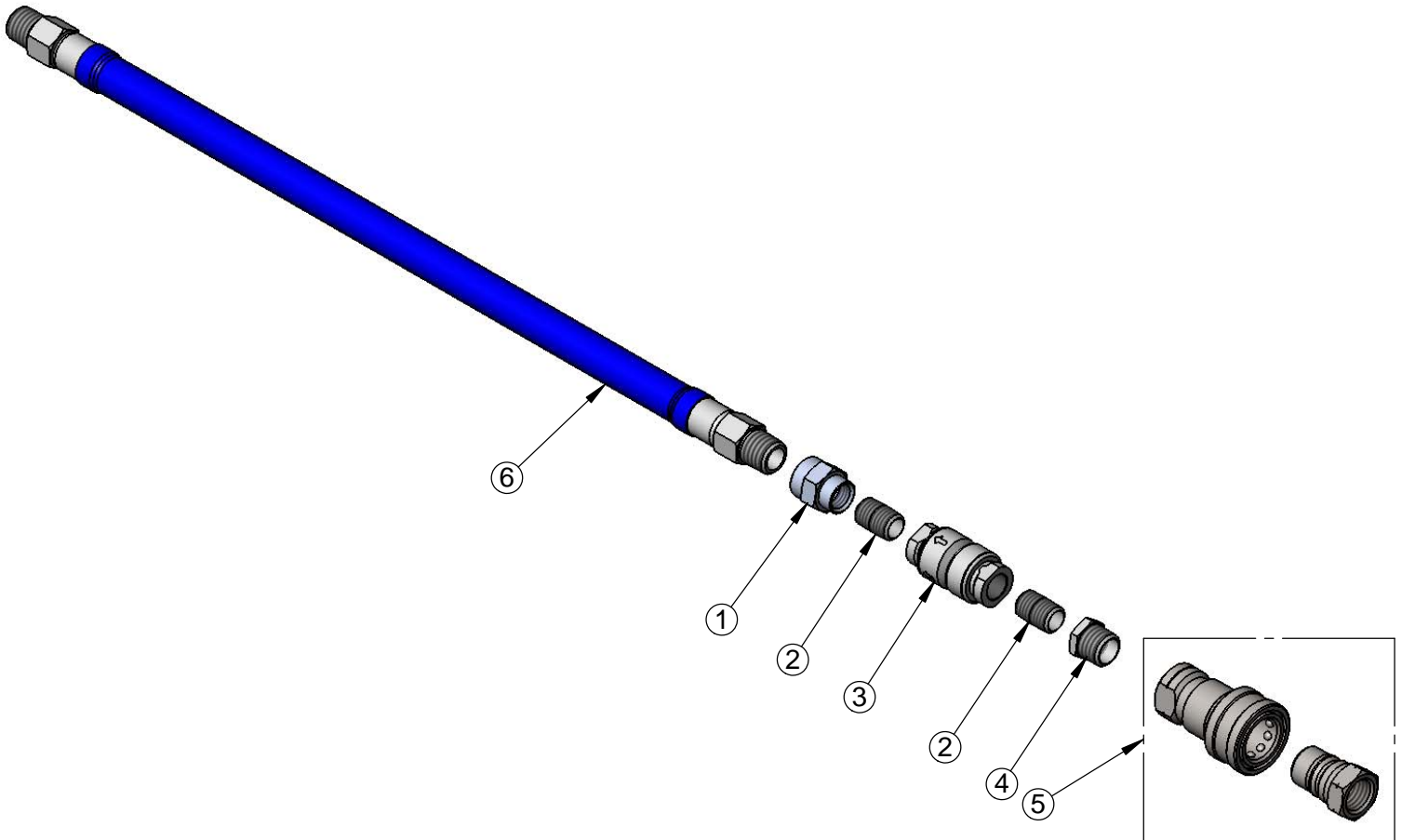

Product Specifications:  
 1/2" NPT x 72" Water Hose w/ Quick Disconnect & Vacuum Breaker

Product Compliance:  
 ASME A112.18.1 / CSA B125.1  
 NSF 61 - Section 9  
 NSF 372 (Low Lead Content)  
 CSA B64.8 (VB)