



T&S BRASS AND BRONZE WORKS, INC.
 2 Saddleback Cove / P.O. Box 1088
 Travelers Rest, SC 29690

Model No.
B-0679

Item No.

Travelers Rest, SC: 800-476-4103 • Simi Valley, CA: 800-423-0150 • Fax: 864-834-3518 • www.tsbrass.com

This Space for Architect/Engineer Approval

Job Name _____ Date _____
 Model Specified _____ Quantity _____
 Customer/Wholesaler _____
 Contractor _____
 Architect/Engineer _____

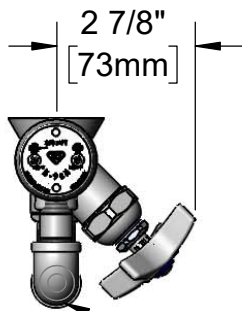

68" Reinforced PVC
 Hose & Extended
 Spray Nozzle

Items Not Shown
 For Clarity

B-0968
 3/8" NPT
 Vacuum Breaker

Control Valve
 Rotated 45° to
 Avoid Wall.

Ø 2" [51mm]
 Flange w/
 1/2" NPT
 Female Inlet

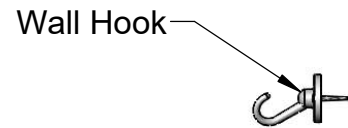
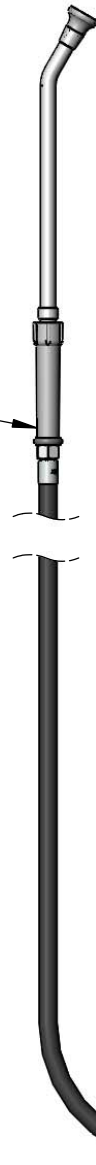
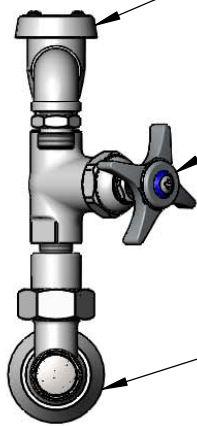

3 7/16"
 [87mm]

7 9/16"
 [192mm]

Loose Key Stop
 Mounting Surface

Product Specifications:
 Bedpan Washer, Loose Key Angle Stop, 3/8" NPT Vacuum Breaker, 4-Arm
 Handle & Extended Spray Outlet w/ 2.2 GPM Rosespray

Product Compliance:
 ASME A112.18.1 / CSA B125.1
 ASSE 1001 (VB)



T&S BRASS AND BRONZE WORKS, INC.
 2 Saddleback Cove / P.O. Box 1088
 Travelers Rest, SC 29690

Model No.
B-0679
 Item No.

Travelers Rest, SC: 800-476-4103 • Simi Valley, CA: 800-423-0150 • Fax: 864-834-3518 • www.tsbrass.com

ITEM NO.	SALES NO.	DESCRIPTION
1	002861-40	Bedpan Spray Nozzle
2	010476-45	#27 Washer
3	B-0068-R	68" Reinforced PVC Hose w/ Handle
4	B-0104-D	Dummy Wall Hook Bracket
5	B-0968	3/8" NPT Vacuum Breaker
6	002341-40	Nipple, 3/8" NPT x 1 1/2"
7	001355-40	Elbow, 3/8 NPT
8	053A	Adapter, 3/8" NPT Male
9	007010-40	Straight Stop Assembly w/ 4-Arm & Blue Index
10	002535-25	3/8" Close Nipple
11	B-1351	Loose Key 1/2" NPT Angle Stop w/ Tee Handle & Screw
12	166A	Service Stop Spindle w/ Cap, Handle & Screw

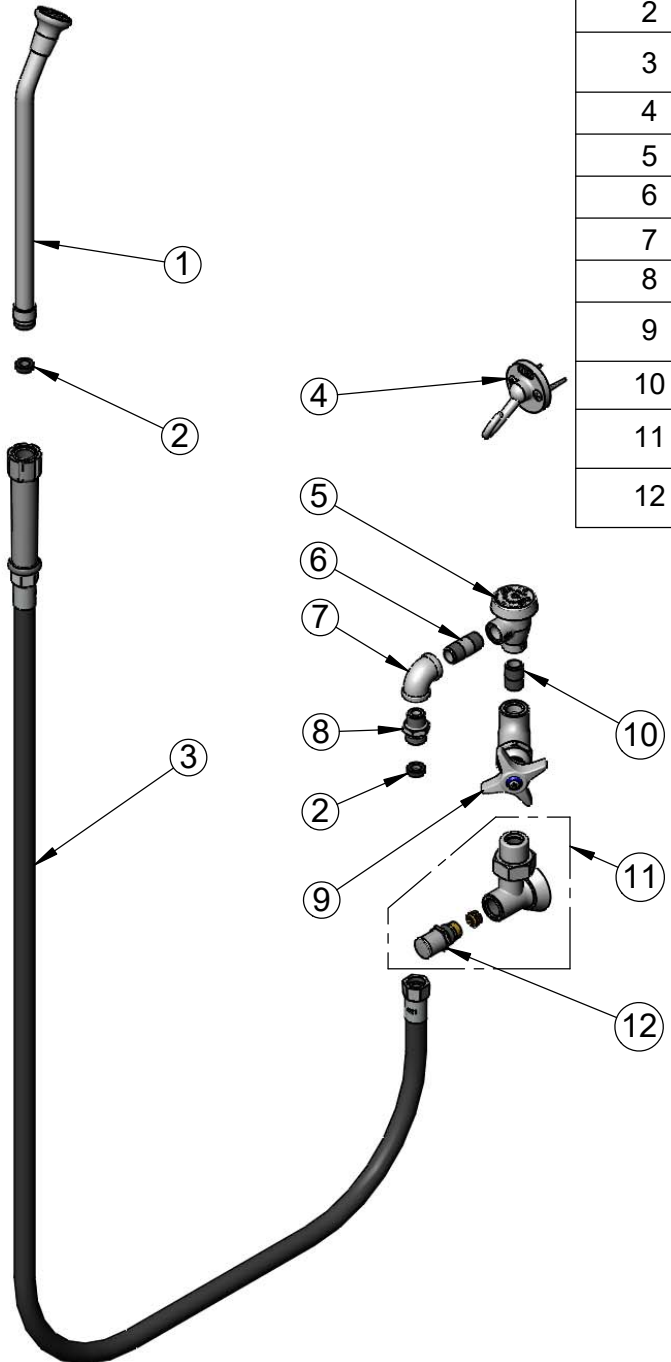

Product Specifications:
 Bedpan Washer, Loose Key Angle Stop, 3/8" NPT Vacuum Breaker, 4-Arm Handle & Extended Spray Outlet w/ 2.2 GPM Rosespray

Product Compliance:
 ASME A112.18.1 / CSA B125.1
 ASSE 1001 (VB)