

MASQUE DE FEMME LUNAIRE

A2R-517

Robe hook

THG[®]
PARIS

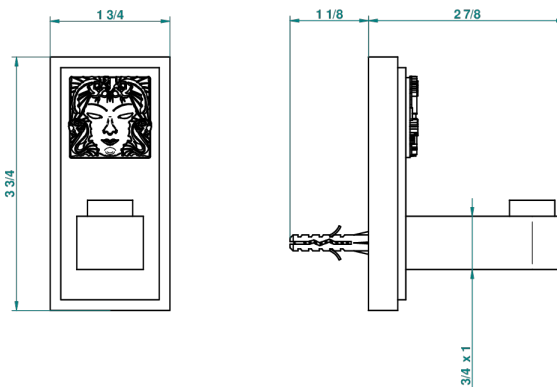

recommended drilling ø
ø de perçage conseillé
empfohlener Abstand
Ø de perforación aconsejado

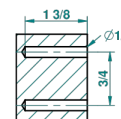

33437

25/05/2010

CHARACTERISTIC

- Masque de Femme lunaire
- Robe hook

AVAILABLE FINITIONS

Black nickel - D24
Chrome polished - A02
Chrome polished / gold polished - G02
Gold mat - F07
Gold polished - F01
Gold satiny - F03

Matt chrome (American satin) - C02
Matt nickel (American satin) - C01
Nickel polished - B01
Rose Gold - F27
Satin chrome - C03
Silver rhodium - F18

Soft gold - F30
Soft matt gold - F31
Soft satin gold - F32