

recommended drilling ø  
*ø de perçage conseillé  
 empfohlener abstand  
 Ø de perforación aconsejado*

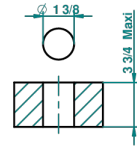

47103

02/10/2012

**CHARACTERISTIC**

- ASME : ASME A112.18.1-2011/CSA B125.1-11

**STANDARDS**



**AVAILABLE FINITIONS**

- Blush PVD - H62
- Brass color PVD - H49
- Brown bronze color PVD - F33
- Chrome polished - A02
- Chrome polished / gold polished - G02
- Gold color PVD - H52

- Gold polished - F01
- Graphite PVD - H64
- Matt Umber PVD - H67
- Matt blush PVD - H60
- Matt brass color PVD - H50
- Matt brown bronze color PVD - F34

- Matt gold color PVD - H53
- Matt graphite PVD - H65
- Matt nickel color PVD - H56
- Nickel color PVD - H55
- Nickel polished - B01
- Rose Gold - F27

- Silver rhodium - F18
- Soft gold - F30
- Soft satin gold - F32
- Umber PVD - H66