

SUNDIAL

20200 / 920000 / 200 SERIES
BATHWARE

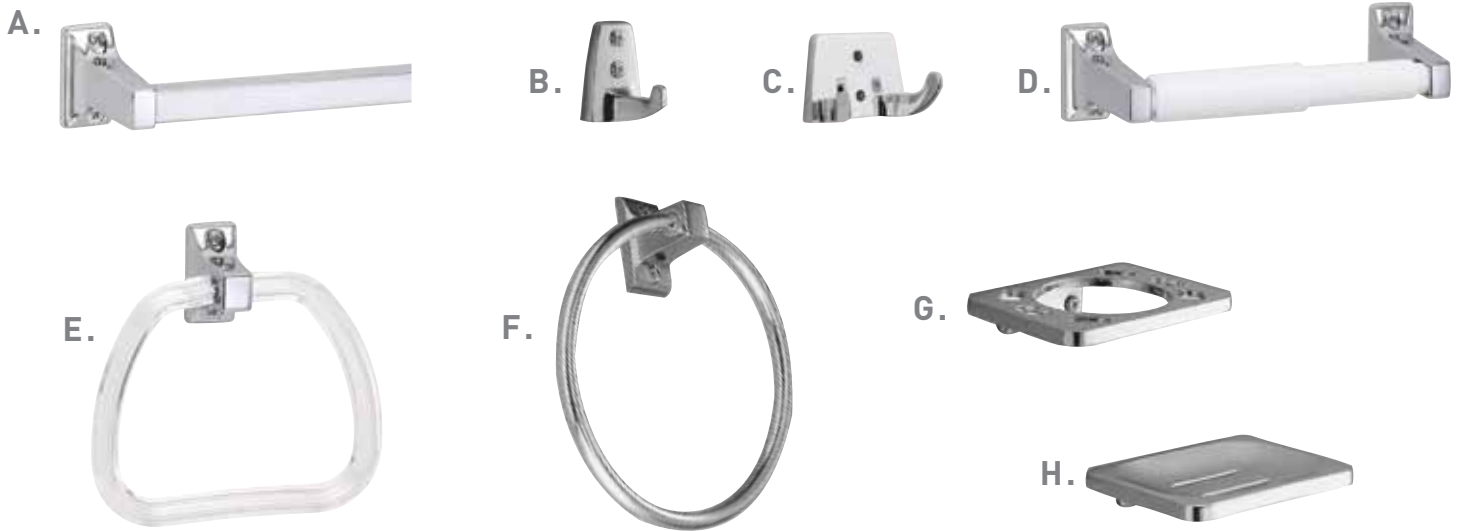

SPECIFICATIONS

- > CONTRACTOR PACK
- > APPLICATION: SINGLE-FAMILY RESIDENTIAL BUILDINGS, MULTI-FAMILY RESIDENTIAL BUILDINGS
- > EXPOSED SURFACE MOUNT
- > ZAMAC (DIECAST ZINC ALLOY)
- > MOUNTING HARDWARE AND INSTALLATION INSTRUCTIONS INCLUDED



LIMITED LIFETIME WARRANTY

5/8" STAINLESS STEEL BAR	POLISHED CHROME 26	CASE QTY	3/4" STAINLESS STEEL BAR	POLISHED CHROME 26	CASE QTY
A. TOWEL BAR - 18"	01-20218	4	A. TOWEL BAR - 18"	01-920018	4
TOWEL BAR - 24"	01-20224	4	TOWEL BAR - 24"	01-920024	4
TOWEL BAR - 30"	01-20230	4	TOWEL BAR - 30"	01-920030	4
			TOWEL BAR - 36"	01-920036	4
5/8" ALUMINUM BAR			3/4" ALUMINUM BAR		
A. TOWEL BAR - 18"	01-A20218	4	A. TOWEL BAR - 18"	01-A920018	4
TOWEL BAR - 24"	01-A20224	4	TOWEL BAR - 24"	01-A920024	4
TOWEL BAR - 30"	01-A20230	4	TOWEL BAR - 30"	01-A920030	4
			TOWEL BAR - 36"	01-A920036	4
B. SINGLE ROBE HOOK				01-211	50
C. DOUBLE ROBE HOOK				01-212	50
D. PAPER HOLDER - WITH WHITE PLASTIC ROLLER				01-201S	50
E. TOWEL RING WITH LUCITE RING				01-203	50
F. TOWEL RING WITH METAL RING				01-204	50
G. TOOTHBRUSH & TUMBLER HOLDER				01-205	50
H. SOAP DISH				01-206	50

A. TOWEL BAR

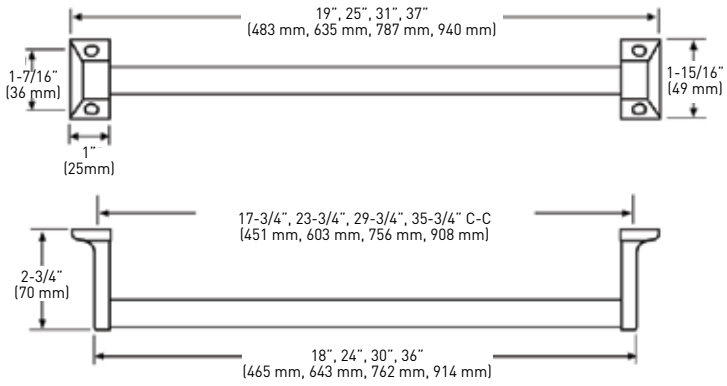

B. SINGLE ROBE HOOK

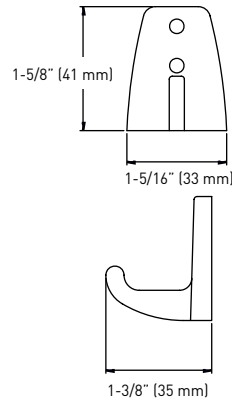

C. DOUBLE ROBE HOOK

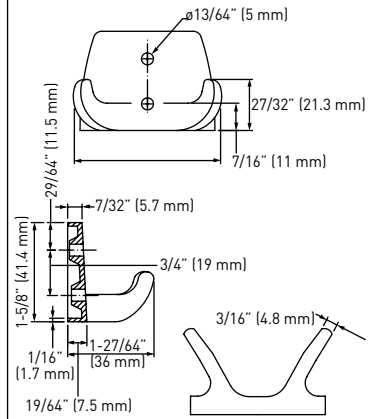

D. PAPER HOLDER

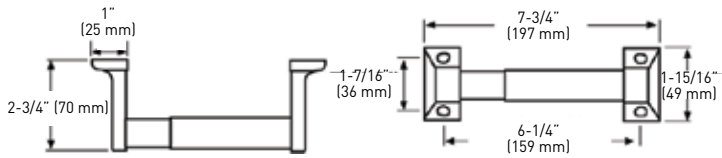

E. TOWEL RING WITH LUCITE RING

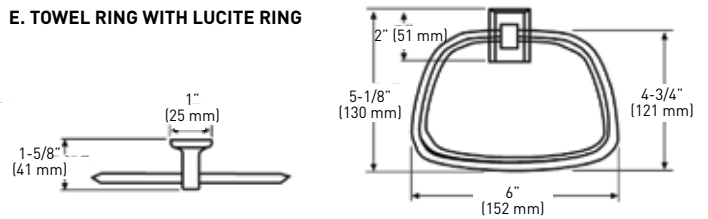

F. TOWEL RING WITH METAL RING

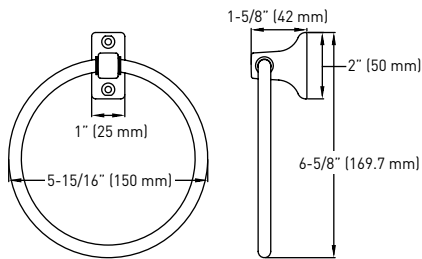

G. TOOTHBRUSH & TUMBLER HOLDER

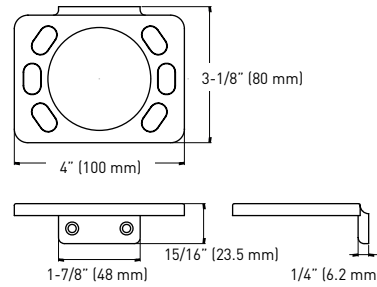

H. SOAP DISH

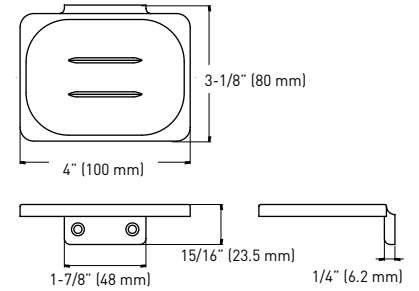

MEASUREMENTS SUBJECT TO A 3% VARIANCE.