

### SPECIFICATIONS

- UNIVERSAL 6-IN-1 LATCH: DRIVE IN, SQUARE MORTISE AND RADIUS CORNER WITH ADJUSTABLE BACKSET: 2-3/8" (60 mm) – 2-3/4" (70 mm)
- ANSI GRADE 3 COMPLIANT
- STANDARD BORE HOLES: 2-1/8" (54 mm)
- FITS STANDARD DOOR THICKNESS: 1-3/8" (35 mm) – 1-3/4" CH (45 mm)
- FULL LIP RADIUS CORNER STRIKE WITH ADJUSTABLE TAB STANDARD: 1-3/4" x 2-1/4" (45 mm x 57 mm)
- LIFETIME MECHANICAL AND FINISH WARRANTY



GRADE 3

ANSI GRADE 3



LIFETIME MECHANICAL & FINISH WARRANTY



SQUARE ROSE KIT OPTION



2-1/4" OPTIONAL EXTENSION KIT



20 MINUTE OPTIONAL FIRE RATING



REVERSIBLE



MEETS ADA STANDARDS

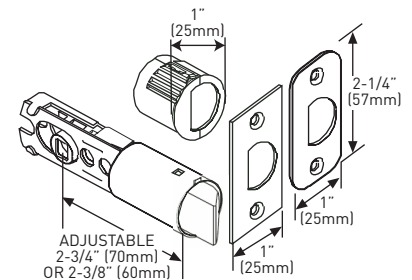
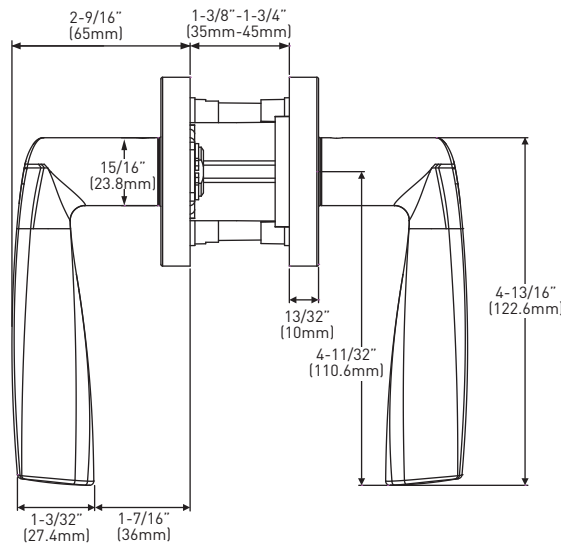
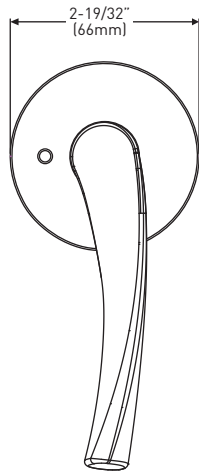

6-IN-1 PRIVACY/PASSAGE LATCH

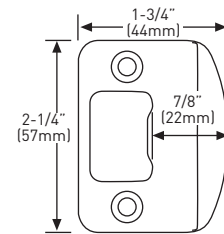

FULL LIP RADIUS STRIKE

#### BUILDER PACK

	SATIN NICKEL 15	CASE QTY
Privacy	30-D006324SN	20
Passage	30-D006334SN	20
Inside trim RH	30-HL0063SNR	20
Inside trim LH	30-HL0063SNL	20
Dummy RH	30-634SNR	20
Dummy LH	30-634SNL	20

#### SQAURE ROSE KIT OPTION



#### SQUARE CONTEMPORARY ROSE KIT

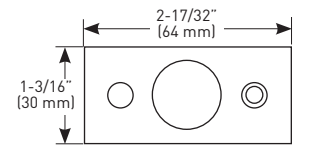
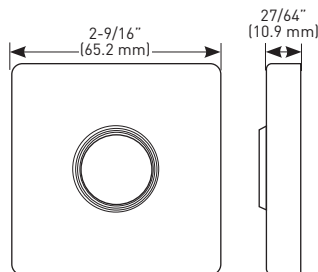

INTERIOR BRACKET

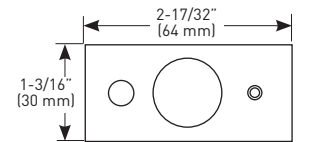

EXTERIOR BRACKET

#### BUILDER PACK

	SATIN NICKEL 15	CASE QTY
Privacy	30-SQR0024SN	10
Passage	30-SQR0034SN	10
Dummy/Inside trim	30-SQR0044SN	10

MEASUREMENTS SUBJECT TO A 3% VARIANCE

MEASUREMENTS ARE FOR REFERENCE ONLY. TAYMOR RESERVES THE RIGHT TO CHANGE THE PRODUCT SPECS WITHOUT NOTICE. FOR PRODUCT WARRANTY, PLEASE VISIT TAYMOR WEBSITE FOR DETAILS