

SUNGLOW

BATHWARE

Taymor®



FEATURES

- CONTRACTOR PACK
- CONCEALED SURFACE MOUNT
- LIFETIME WARRANTY
- MOUNTING HARDWARE AND INSTALLATION INSTRUCTIONS INCLUDED



SUNGLOW

BATHWARE

CONSTRUCTION: ZAMAC (DIECAST ZINC ALLOY)

INCLUDES MOUNTING PLATES — 5/16" (8mm) x 3/16" (5mm); NYLON ANCHORS AND STEEL PHILLIPS HEAD SCREWS — #8 x 1-1/4" (32mm)

	TOWEL BAR TUBE SIZE	TOWEL BAR TUBE MATERIAL	TOWEL RING TUBE MATERIAL	STANDARD PAPER HOLDER ROLLER MATERIAL	PAPER HOLDER/TOWEL HOLDER MATERIAL
C26 SUNGLOW – POLISHED CHROME	3/4" (19mm)	ALUMINUM OR STAINLESS STEEL	ALUMINUM	PLASTIC	N/A

TOWEL BAR

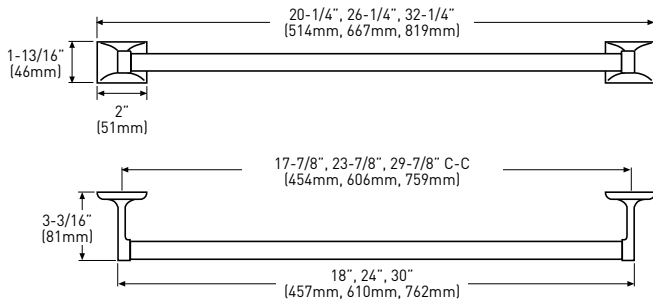

SINGLE ROBE HOOK

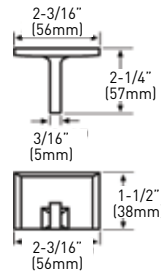

DOUBLE ROBE HOOK

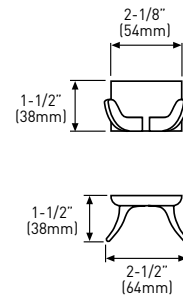

TOWEL RING - LUCITE RING

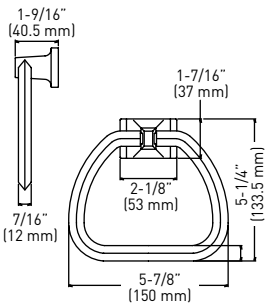

TOWEL RING - METAL RING

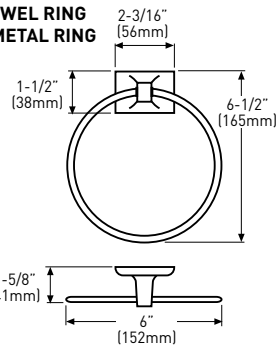

TOOTHBRUSH & TUMBLER HOLDER

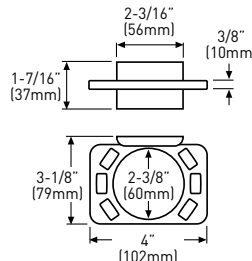

SOAP DISH

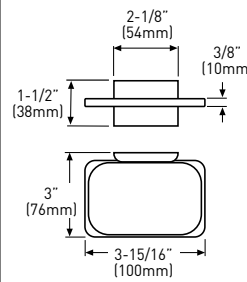

STANDARD PAPER HOLDER

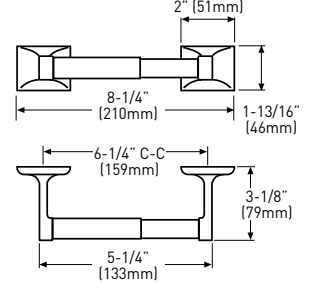

MEASUREMENTS SUBJECT TO A 3% VARIANCE.

PHOTO	DESCRIPTION	SATIN NICKEL US15	POLISHED CHROME US26	POLISHED CHROME US26 (ALUMINUM)	CASE PACK
	18" x 3/4" TOWEL BAR - DIECAST POST WITH STAINLESS STEEL BAR 24" x 3/4" TOWEL BAR - DIECAST POST WITH STAINLESS STEEL BAR 30" x 3/4" TOWEL BAR - DIECAST POST WITH STAINLESS STEEL BAR 36" x 3/4" TOWEL BAR - DIECAST POST WITH STAINLESS STEEL BAR	01-940018SN 01-940024SN 01-940030SN	01-940018 01-940024 01-940030 01-940036	01-A940018 01-A940024 01-A940030 01-A940036	50 50 50 50 50
	SINGLE ROBE HOOK		01-9401		50
	DOUBLE ROBE HOOK	01-9402SN	01-9402		50
	TOWEL RING - LUCITE RING		01-9402		50
	TOWEL RING - METAL RING	01-9404SN	01-9404		50
	TOOTHBRUSH & TUMBLER HOLDER		01-9405		50
	SOAP DISH		01-9406		50
	STANDARD PAPER HOLDER WITH WHITE PLASTIC ROLLER		01-9408		50
	STANDARD PAPER HOLDER WITH CHROME PLASTIC ROLLER	01-9409SN	01-9409		50