





362SH
1 Mode Showerhead
Specification Submittal

<p>Model Number</p> <p><input type="checkbox"/> 362SH <i>1 Mode Showerhead</i></p>	<p>Feature Highlights</p> <ul style="list-style-type: none"> • 1 mode showerhead • 3" diameter • Easy to clean rubber nozzles • 2.5 gpm (9.5 L/min) standard flow restrictor • Components shall be metal construction, plated in standard polished chrome finish
<p>Modifications</p> <p><input type="checkbox"/> -1.5  <i>1.5 gpm (5.7 L/min) flow restrictor</i></p> <p><input type="checkbox"/> -2.0 <i>2.0 gpm (7.6 L/min) flow restrictor</i></p> <p><input type="checkbox"/> -BBZ <i>Brushed Bronze finish</i></p> <p><input type="checkbox"/> -MB <i>Matte Black finish</i></p> <p><input type="checkbox"/> -STN <i>Satin Nickel finish</i></p> <p>Note: Append appropriate -suffix to model number.</p>	<p>Compliance</p> <p>-ASME A112.18.1/CSA B125.1</p> <p>-WaterSense 1.5 gpm and 2.0 gpm</p>  <p>Warranty</p> <p>Limited Lifetime - to the original end purchaser in consumer installations. 5 Years - for commercial installations. Refer to www.symmons.com/warranty for complete warranty information.</p>

Dimensions

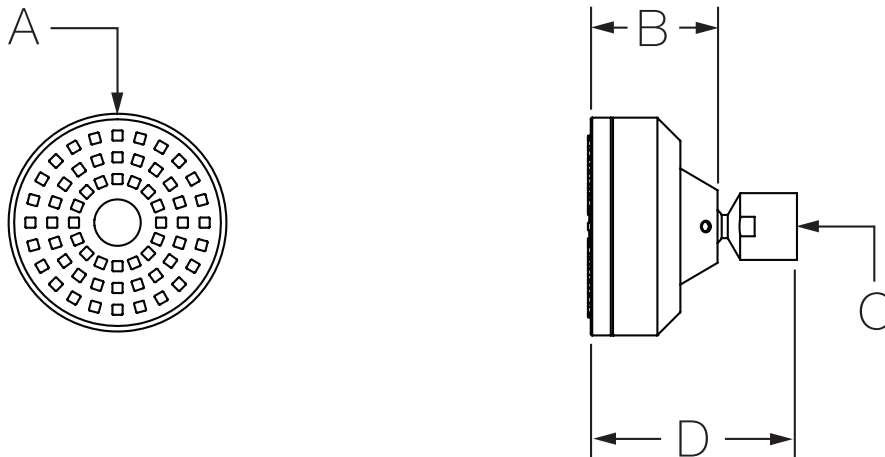

Measurements	
A	Ø 3", 76 mm
B	1-7/8", 48 mm
C	1/2-14 NPT
D	3", 76 mm

Note: Dimensions subject to change without notice.