



Location:

SYMMONS® DS Creations

the smart choice™

S0216-TRM (CDS0216-3500-TRM)

Tub/Shower Trim

Specification Submittal



Model Numbers	Specification
<input type="checkbox"/> S0216-TRM <i>Tub/Shower Trim</i>	Tub/Shower Trim with secondary integral diverter shall include metal lever handle. Tub/Shower trim shall be made from metal construction, plated in standard polished chrome finish.
Warranty	
Limited Lifetime - to the original end purchaser in consumer/residential installations. 5 Years - for industrial/commercial installations. Refer to www.symmons.com/warranty for complete warranty information.	



Dimensions

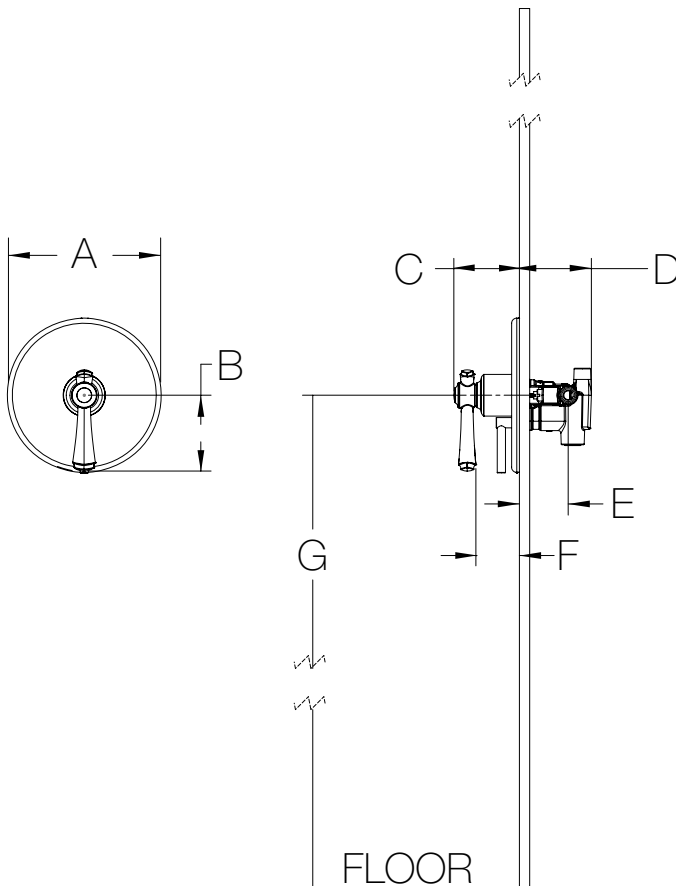

Measurements	
A	Ø 7-1/2", 191 mm
B	3-11/16", 94 mm
C	3-3/16", 81 mm
D	3-1/2", 89 mm
E	(Rough-in) 2-3/8" ± 1/2", 60 mm ± 13 mm
F	2-1/8", 54 mm
G	Ref. 42", 1067 mm

Notes:

- 1) All dimensions measured from nominal rough-in (see E as reference).
- 2) Dimensions subject to change without notice.