



Location:

0100-TB-20 (CD0100-3VMTB-20)
 20" Vanity Mounted Towel Bar
Specification Submittal



Model Numbers	Specification
<input type="checkbox"/> 0100-TB-20 <i>20" Vanity Mounted Towel Bar</i>	20" Vanity Towel Bar shall be made from metal construction, plated in standard polished chrome finish.
Warranty	
<p>Limited Lifetime - to the original end purchaser in consumer/residential installations. 5 Years - for industrial/commercial installations. Refer to www.symmons.com/warranty for complete warranty information.</p>	

Dimensions

Measurements	
A	20", 508 mm
B	Ref. Wood Thickness Min. 3/4", 19 mm Max. 1", 25 mm
C	Ø 3/4", 19 mm
D	2-7/8", 72 mm
E	20", 508 mm
F	(2x) Hole Size Ø 7/16", 11 mm

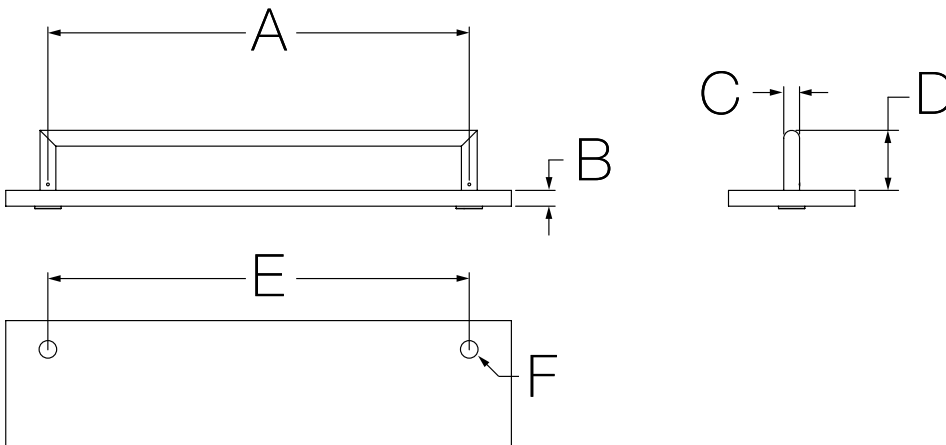

Note: Dimensions subject to change without notice.