

# SYMMONS® Dia® Lavatory Faucet

## SLS-3512-1.5, SLS-3510-1.5 Series

### Installation Brief

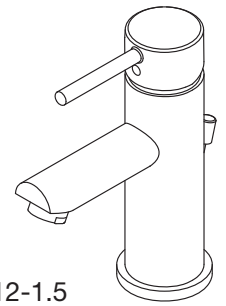

Model SLS-3512-1.5

#### Model Numbers

SLS-3512-1.5 Lavatory faucet with lift rod and pop-up drain

SLS-3510-1.5 Lavatory faucet only

#### Decorative Finishes

Append finish suffix code to replacement part numbers when applicable

- Polished chrome (standard)

#### Tools & Materials

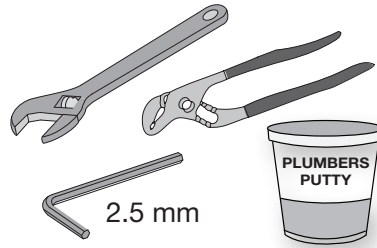

#### Need Help?

Contact Symmons customer service at  
P: (800) 796-6667, F: (800) 961-9621  
Email: [gethelp@symmons.com](mailto:gethelp@symmons.com)  
Monday - Friday 7:30 am - 6:00 pm EST

 Please check Symmons website for technical help, the latest product information and warranty policy.  
[www.symmons.com/service](http://www.symmons.com/service)

## Quick Install Guide Dia Lavatory Faucet, SLS-3512-1.5, SLS-3510-1.5 Series

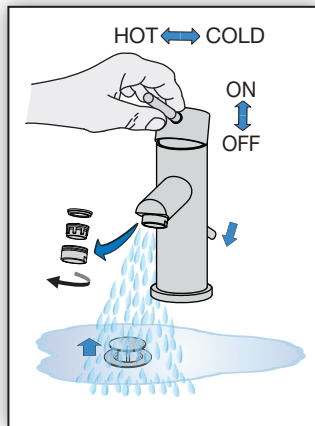

**Step 3**  
Flush lines and  
check for leaks

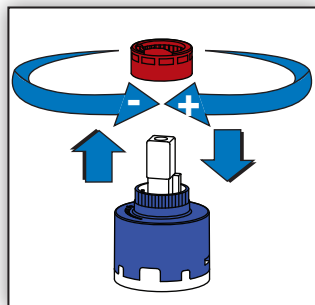

**Optional**  
Adjust limit stop washer  
to limit handle turn to the  
hot position if desirable

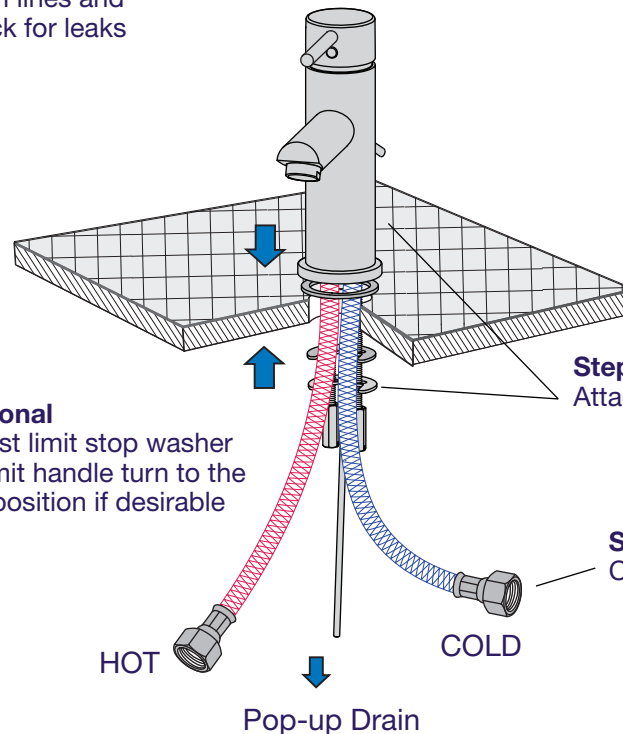

**Step 1**  
Attach faucet assembly

**Step 2**  
Connect supply hoses

**⚠ WARNING:** This product can expose you to chemicals including lead, which is known to the state of California to cause cancer, birth defects, or other reproductive harm. For more information, go to [www.P65Warnings.ca.gov](http://www.P65Warnings.ca.gov).

## Dimensions Dia Lavatory Faucet, SLS-3512-1.5, SLS-3510-1.5 Series

### Notes:



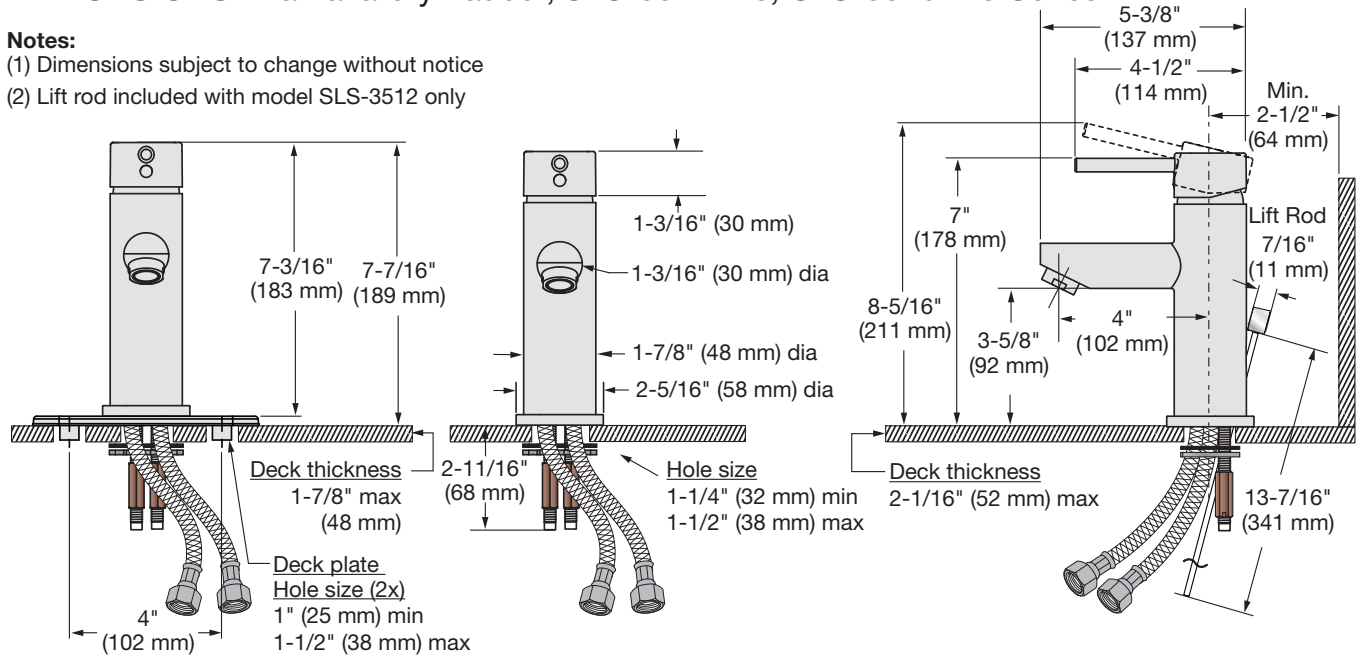



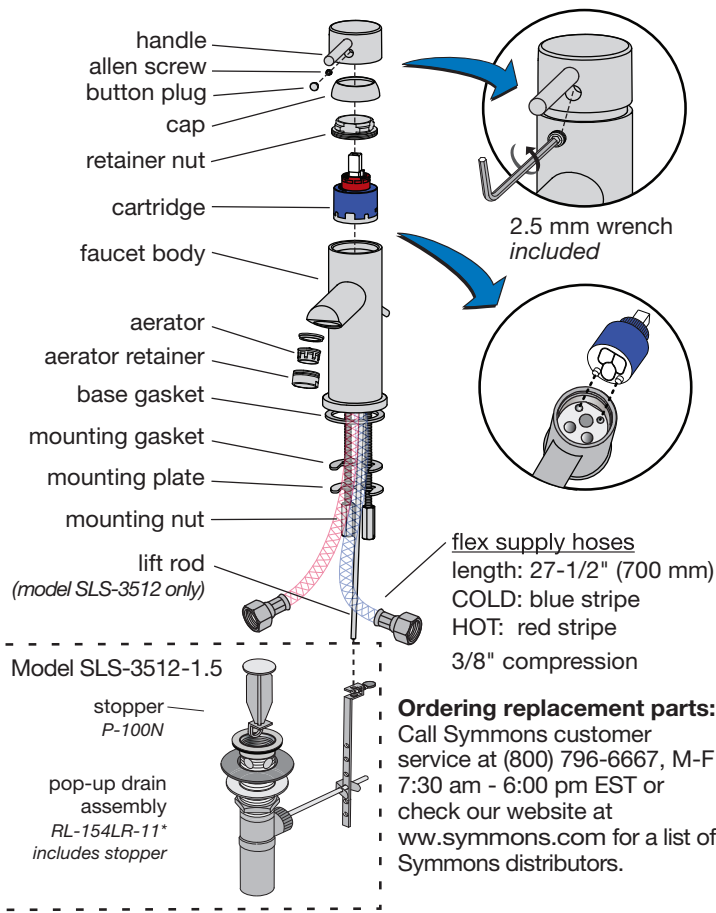



- (1) Dimensions subject to change without notice
- (2) Lift rod included with model SLS-3512 only

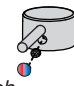

## Parts Assembly Dia Lavatory Faucet, SLS-3512-1.5, SLS-3510-1.5 Series

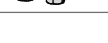
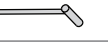

### Replacement Parts

Part Number	Item
RL-314	Cartridge with limit stop 
RL-059-1.5* RL-064* RL-071*	<u>Aerator kits</u> 1.5 gpm (5.7 L/min)  1.0 gpm (3.8 L/min)  0.5 gpm (1.9 L/min)  <i>includes aerator, retainer &amp; washer</i>
RL-066*	<u>Handle kit</u> <i>includes handle, allen screw &amp; RB button plug</i> <i>requires 2.5 mm Allen wrench</i> 
RL-067	<u>Mounting hardware kit</u> threaded studs (2)  hex nut (2)  rubber washer (1)  metal washer (1) 
LN-341*	Lift Rod 
RL-080	Copper Tube Hose Extension 
RL-081*	4" Deck Plate (Optional) 

\*Note: For decorative finish faucets append the appropriate suffix code letters to part numbers marked with an asterisk (\*)