

Top 100 System Galvanized Steel Grate / A15 / ADA

Product Specifications	
<p>Part. No. 865-T4GSAS (1 m) 865-T4GS5AS (1/2 m)</p> <p>Load Class: A15 (3,300 lbs) according EN 1433 Certified by MPA-HB (independent laboratories)</p> <p>Material: Galvanized Steel ST-37 Weight: 4.61 lbs (2.1kg)</p> <p>Surface: Slot design (0.39" x 3.93") Slots according ADA Standards</p> <p>Locking: Patented boltless grate locking system Water intake: 55.65 sq/in (359 cm²/m)</p> <p>Use: This grate is developed for use with HydroTec TOP 100 channels made of fiber reinforced concrete with a galvanized steel edge protection.</p>	

Fiber Reinforced Concrete Channel

Available heights(h):

- 3.15" (80mm)
- 4.33" (110mm)
- 6.30" (160mm)
- 7.28" (185mm)
- 8.27" (210mm)
- 9.25" (235mm)
- 10.24" (260mm)
- sloped (30 sections)

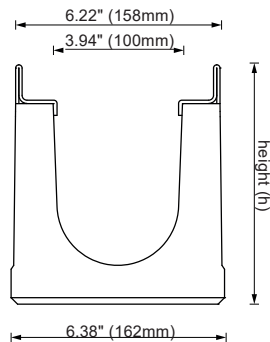

System Specifications

Grate Locking Tool (Part. No. 865-TOOL)

The Grate Locking Tool is made of galvanized steel. It's used to lock and unlock the grate.

TOP 100 galv. slotted Grate (Part. No. 865-T4GSAS) The grate is made of galvanized steel and certified to EN 1433 Load Class A15.

Locking Bar (Part. No. 865-4LR)

Two locking bars fix the grate to the channel body. They're unlocked by the Grate Locking Tool.

TOP 100 Channel

The channel body is made of fiber reinforced concrete with a galvanized steel edge protection. Connecting profiles at the end of the channel guarantee an easy and fast installation.

