

HydroBlock 300 System Ductile Iron Channel/Grate / F900 / ADA

Product Specifications

Part No.:
865-HB12ADA00FA

Load Class:
F900 (198,000 lbs) according EN 1433
Certified by MPA-HB (independent laboratories)

Material: Ductile Iron GJS-500-7 (ASTM A536 70-50-05)

Weight: 247.0 lbs (112.0 kg)

Surface: Slot design (0.47" x 1.10") ensures high water intake. Slip-resistant design.

Locking:
One piece trench drain with no loose parts. Outlet sections are locked by 4 stainless steel screws.

Use:
This channel is developed to be installed in areas with high dynamic forces. HydroBlock is qualified as "Type I" according EN 1433.

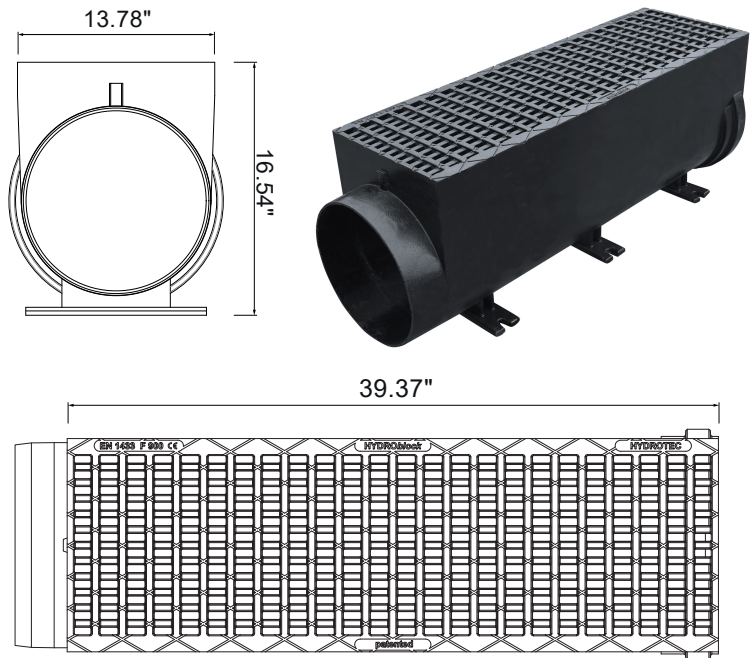

Outlet Sections

Bottom Outlet Part No.: 865-HB12ADA005BFA

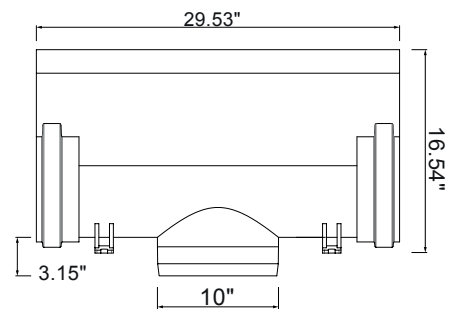

System Specifications

HydroBlock 300:
The channel section is made of ductile iron and certified to EN 1433 Load Class F900 and is qualified as TYPE I. The gasket connection ensures a fast, watertight installation.

Bottom Outlet (865-HB12ADA005BFA):
Outlet section length is 29.53" (3/4 m). Outlets are recommended at least every 75ft as inspection points to the channel run.
It is connected to the ground pipe by a 10" pipe.

Debris screen:
Debris screen is made from galvanized steel and is designed to reduce leaves and other large objects from entering the drain pipe.

