

TRENCH DRAIN CATCH BASIN

»» 865 SERIES

HydroTec™

SPECIFICATION

Sioux Chief 865 Series HydroTec Maxi 200 fiber-reinforced concrete catch basin shall be used where necessary for surface drainage. Catch basin shall incorporate a galvanized debris basket, ductile iron edge rails and Class F, ADA-compliant ductile iron grate. All concrete thickness and reinforcement per structural engineer's specification for the application. Designed in accordance with ASME A112.6.3

MATERIALS

Catch Basin: Fiber-reinforced concrete

Edge Rails: Ductile iron

Grating: Ductile iron (ASTM A536 70-50-05) with 'F1' lock-down system

GRATE INTAKE AREA

52.3 in²

LOAD RATING

DIN EN 1433 - Class F

ITEM # SUBMITTED	_____
JOB NAME	_____
LOCATION	_____
ENGINEER	_____
CONTRACTOR	_____
PO#	_____ TAG _____

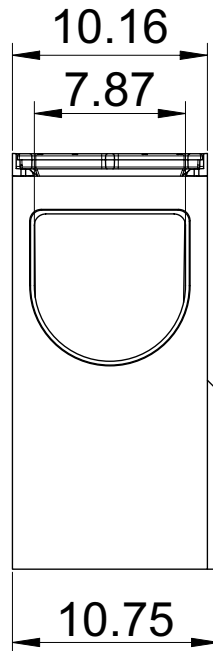
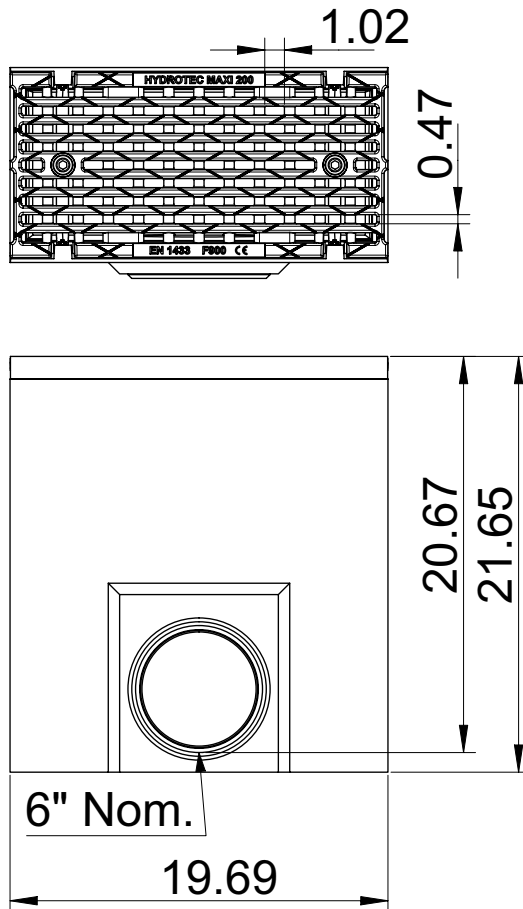

Item Number

865-M8CBF1A

Accessories - Available Separately:
 865-8LR: Grate-locking rod for Maxi 200 System
 865-6PC: PVC S&D connection pipe for 6" Nom. outlets