

ADJUSTABLE CLEANOUT FINISH FIXTURE

842 SERIES

FinishLine™

SPECIFICATION

Sioux Chief 834 Series FinishLine finish fixture for adjustable cleanout shall be used where necessary for replacement of Coring Plug in drainage systems. Finish Fixture shall be used with FinishLine rough-in fixtures and allow adjustment of 1.25" after the concrete pour. Scoriated cleanout cover shall meet all applicable load requirements for intended use.

Designed in accordance with ASME A112.36.2M

MATERIALS

Top Housing: ABS with threaded brass inserts

Cover: ABS

LOAD RATING

750 lbs (Light-Duty, pedestrian traffic)

DIMENSIONS

- A:** Top diameter 6½"
- B:** Overall height 2⅞"
- C:** Outlet diameter 4"

| | |
|------------------|-----------------|
| ITEM # SUBMITTED | _____ |
| JOB NAME | _____ |
| LOCATION | _____ |
| ENGINEER | _____ |
| CONTRACTOR | _____ |
| PO# | _____ TAG _____ |



834-4HPR

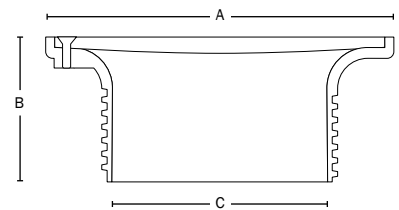

Item Number

834-4HPR