

ADJUSTABLE FLOOR DRAIN FINISH FIXTURE

» 832 SERIES

FinishLine™

SPECIFICATION

Sioux Chief 832 Series FinishLine finish fixture for adjustable floor drain shall be used where necessary in drainage systems. Finish Fixture shall allow adjustment of 1.25" after the concrete pour when used with FinishLine rough-in fixtures. Strainer shall be heel-proof and meet all applicable load requirements for intended use. Designed in accordance with ASME A112.6.3

MATERIALS

Top Housing: ABS with threaded brass inserts

Strainer: ABS

LOAD RATING

500 lbs (Light-Duty, pedestrian traffic)

STRAINER FREE AREA

8.74"

DIMENSIONS

A: Top diameter 6½"
B: Overall height 2⅞"
C: Outlet diameter 4"

ITEM # SUBMITTED	_____
JOB NAME	_____
LOCATION	_____
ENGINEER	_____
CONTRACTOR	_____
PO#	_____ TAG _____



832-4HPR

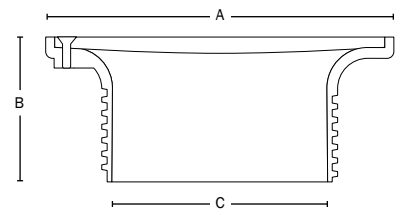

Item Number

832-4HPR