

TWO-HOLE TUBE STRAP

500/501/502 SERIES

SPECIFICATION

Sioux Chief 500/501/502 series tube straps shall be used where necessary to fasten or secure CTS tubing and IPS piping in residential or commercial applications. Mount to wood, metal studs or joists using nail or screw in both holes. Minimum recommended nail penetration is 3/4". Refer to local plumbing codes for proper hanger spacing requirements.

MATERIALS

500 Series: Copper

501 Series: Copper-plated steel

502 Series: Galvanized steel¹

¹ Complies with MSS SP58 Type 26 requirements

DIMENSIONS

CTS Item	A	B	C	D	Gauge	Safe Load
500-2	1/2" CTS	1.78"	1.27"	0.50"	26	9 lbs.
500-3	3/4" CTS	2.13"	1.60"	0.50"	26	13 lbs.
501-0	1/4" CTS	1.64"	1.10"	0.50"	24	4.5 lbs.
501-1	3/8" CTS	0.50"	1.32"	0.50"	24	6 lbs.
501-2	1/2" CTS	1.78"	1.27"	0.50"	24	9 lbs.
501-3	3/4" CTS	2.13"	1.60"	0.50"	24	13 lbs.
501-4	1" CTS	2.90"	2.19"	0.75"	22	24 lbs.
501-5	1-1/4" CTS	3.40"	2.64"	0.75"	22	33 lbs.
501-6	1-1/2" CTS	4.16"	3.11"	0.75"	22	40 lbs.
501-7	2" CTS	4.58"	3.59"	0.75"	22	60 lbs.

IPS Item	A	B	C	D	Gauge	Safe Load
502-0	1/4" IPS	1.88"	1.39"	0.63"	22	4.5 lbs.
502-1	3/8" IPS	2.27"	1.66"	0.63"	22	6 lbs.
502-2	1/2" IPS	2.27"	1.77"	0.63"	22	9 lbs.
502-3	3/4" IPS	2.36"	1.85"	0.63"	22	13 lbs.
502-4	1" IPS	2.94"	2.32"	0.75"	20	24 lbs.
502-5	1-1/4" IPS	3.67"	2.93"	0.75"	20	33 lbs.
502-6	1-1/2" IPS	3.92"	3.17"	0.75"	20	40 lbs.
502-7	2" IPS	5.02"	4.19"	0.75"	18	60 lbs.
502-75	2-1/2" IPS	5.72"	4.69"	1.00"	16	60 lbs.
502-8	3" IPS	6.58"	5.52"	1.00"	16	60 lbs.
502-9	4" IPS	7.72"	6.72"	1.00"	16	60 lbs.

ITEM # SUBMITTED	_____
JOB NAME	_____
LOCATION	_____
ENGINEER	_____
CONTRACTOR	_____
PO#	_____ TAG _____

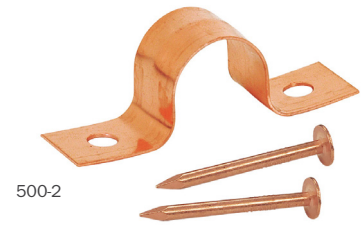

500-2



502-2

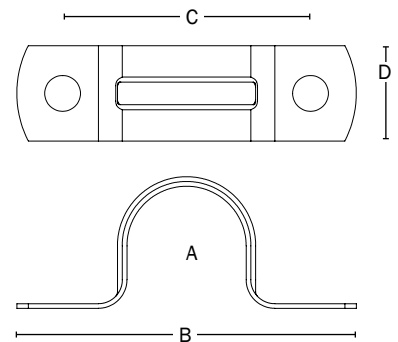

Create Item Number

A-B

e.g. **501-2:** Copper-plated steel tube strap for 1/2" CTS

STRAP MATERIAL A

500 = Copper
501 = Copper-plated Steel
502 = Galvanized Steel

NOMINAL TUBE SIZE B

0 = 1/4" ² **6** = 1-1/2" ²
1 = 3/8" ² **7** = 2" ²
2 = 1/2" **75** = 2-1/2" ^{2,3}
3 = 3/4" **8** = 3" ^{2,3}
4 = 1" ² **9** = 4" ^{2,3}
5 = 1-1/4" ²

² Not available in Copper | ³ Not available in Copper-plated Steel