

# MILWAUKEE UTILITY TRAP

## »» 240 SERIES

### SPECIFICATION

Sioux Chief 240 Series P-Traps shall be installed where necessary in plumbing systems. Trap shall provide a liquid seal that prevents the back passage of gas without affecting the flow of sewage or wastewater through the system when installed in a properly vented DWV system. Trap shall include reducing 1-1/4" x 1-1/2" nut/washer on inlet, bell escutcheon, and optional, plugged cleanout port for trap access. Designed in accordance with ASME A112.18.2.

### MATERIALS

**Tubular:** Chrome-plated brass

**Nuts:** Chrome-plated zinc, Chrome-plated brass

### DIMENSIONS

	-19875C04	-20825C04	-20835C04
A: Length	14-11/16"	14-11/16"	14-11/16"
B: Height	5-13/16"	6-3/16"	6-3/16"
C: Diameter	1-1/2"	1-1/2"	1-1/2"
D: Gauge	17ga	20ga	17ga
E: J-Bend	3-1/2"	3-1/2"	3-1/2"
F: Wall tube	11-3/16"	11-3/16"	11-3/16"
G: Trap seal	1-13/16"	1-13/16"	1-13/16"
H: Thread	1-1/2" MIP	1-1/2" MIP	1-1/2" MIP

ITEM # SUBMITTED	_____
JOB NAME	_____
LOCATION	_____
ENGINEER	_____
CONTRACTOR	_____
PO#	_____ TAG _____

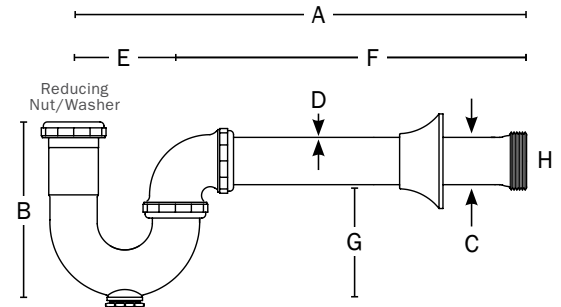

## Create Item Number

### 240-A

e.g. **240-20825C04:** 1-1/2" chrome-plated, 20ga. brass utility trap with cleanout and escutcheon

#### CONNECTION TYPE A

**19875C04** = 17ga. utility trap - no cleanout

**20825C04** = 20ga. utility trap with cleanout

**20835C04** = 17ga. utility trap with cleanout