

# » Lavatory Legs Installation

## For China or Iron Enamel Basin

These all purpose basin lavatory legs can be used in conjunction with china or iron enamel basins. When using these legs on china basin, discard universal adapter, item (7B). When using these legs on iron enamel basin, discard rubber hat washer, item (7A) and hex bell escutcheon, item (8) with screw (9).

1. Press in threaded top plug (2) into the hexagonal leg (1).
2. Press in pointed bottom plug (3) into other end of hexagonal leg (1).
3. Thread on square nut (6) onto one end of threaded rod (4) approximately 1½" from end of rod or as required.
4. Slip on round washer (5) over end of rod (4) and thread rod into threaded top plug (2).
5. A: For China Basin  
Press on rubber hat washer (7A) onto other open end of threaded rod (4) and discard universal adapter (7B).  
B: For Iron Enamel Basin  
Thread on universal adapter (7B) onto other open end of threaded rod (4) and discard rubber hat washer (7A) and hexagonal bell escutcheon (8).
6. For China Basin only slide on hexagonal bell escutcheon (8) onto hex leg (1) with round diameter facing upwards and screw (9) facing the side of hex leg (1).
7. Place completed leg assembly under the basin.  
A: For China Basin  
The rubber hat washer (7A) should fit into the hole on the underside of the basin  
B: For Iron Enamel Basin  
The universal adapter (7B) should engage the protrusion on the underside of the basin.
8. Thread up the threaded rod (4) until there is sufficient tension on the hex leg (1).
9. Thread down square nut (6) and round washer (5) to lock assembly securely in place.
10. For China Basin - Bring up hex bell escutcheon (8) to cover exposed rod and tighten screw (9).
11. Repeat the same steps on the second leg.

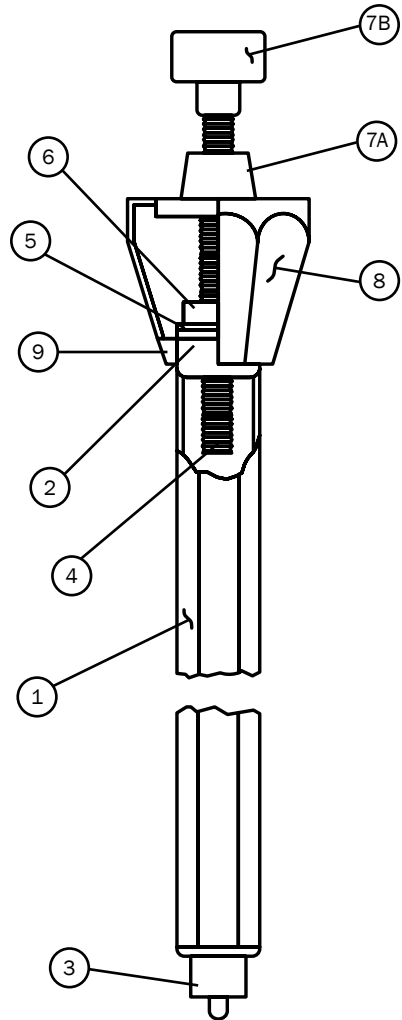

Note: When installing legs over a smooth tile floor, it is suggested that you drill a small diameter hole into the tile to permit the pointed end of the bottom plug (3) to anchor itself to the floor to prevent sliding.

#IS-974-95650004