

SPEAKMAN®

SE-900

SELF-CLOSING VALVE FOR EMERGENCY SHOWERS.

DESCRIPTION

Self-closing valve for emergency showers.

SPECIFICATIONS

Shank: 10" Dia. Brass, Nickel-Plated.

Valve: 1" NPT Female Brass, Chrome-Plated. Self-Closing

Inlet: 1" NPT Female

Outlet: 1-1/2" NPTM

Compliance: ANSI Z358.1

SE-900-CR

SE-900 With 8" S/S Ring on 32" #3 S/S Chain.

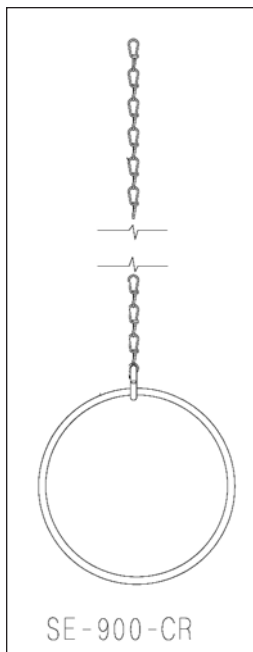
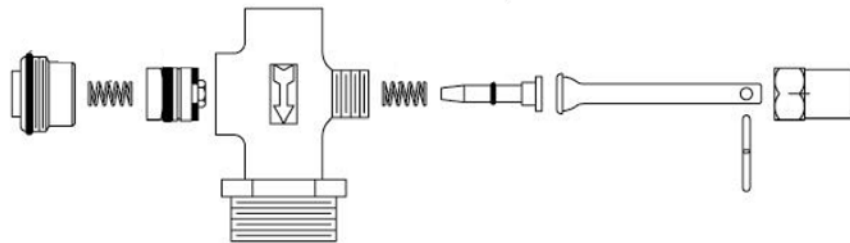

Job Name _____
Location _____
Architect/Engineer _____
Sales Representative _____
Wholesaler _____
Date _____ Model # _____