

# SPEAKMAN® VS-2950

## Versatile ADA+ Shower

### FEATURES:

- Hand held shower combination
- VS-100-PC handheld shower.
- VS-117 vacuum breaker
- G63-0072 5 ft. stainless steel hose
- 2.5 GPM (9.5 L/min) flow rate (VS-100-PC)
- Shower arm bracket

### FINISH:



PC

### COMPLIANCE:

- VS-100-PC Meets ASME A112.18.1 CSA B125.1 standards
- VS-100-PC Meets ICC/ANSI A117.1 SEC. 608.6 and ADAAG
- VS-117 meets ASSE 1014

### WARRANTY:

- 1 year limited

### DIMENSIONS:

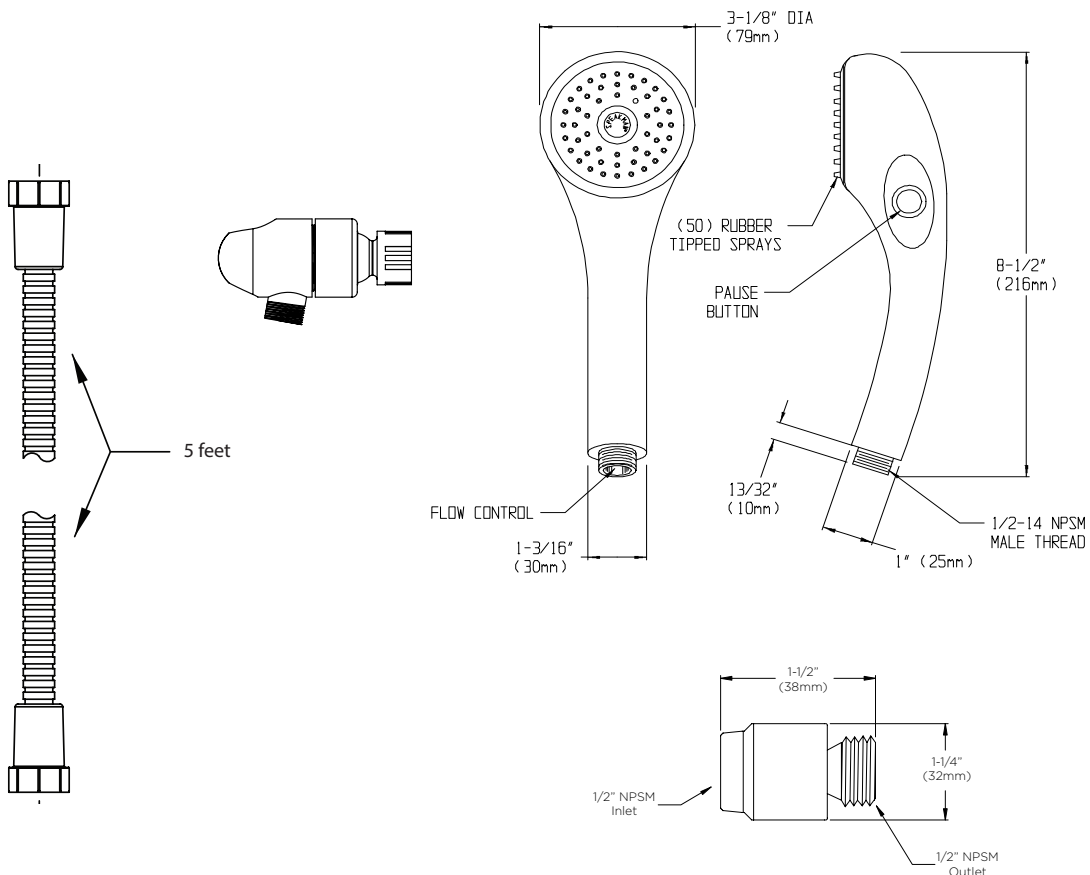
 NOTE: 1. All dimensions are in inches (millimeters) unless otherwise specified and are subject to change without notice.

Architect/Engineer Approval Space:

SPEAKMAN  
400 ANCHOR MILL ROAD  
NEW CASTLE, DE 19720

P: 800-537-2107  
F: 800-977-2747  
W: WWW.SPEAKMAN.COM  
R: OCTOBER 2016