

## Kubos™ Shower System Combination with Valve

### TRIM FEATURES:

- Metal lever handle
- Metal trim plate
- Includes mounting plate and hardware

### VALVE FEATURES:

- Brass body construction
- Four port valve with 1/2" -14 NPT male and 1/2" copper sweat inlets, shower and tub outlets
- Pressure balancing and ceramic temperature regulating cartridge with built-in check valves
- Adjustable temperature limit stop to control maximum temperature setting
- Integral stops allow water shut off for servicing valve
- Supports back-to-back installation
- Includes rough-in template and 1/2" pipe plug

### SHOWER FEATURES:

- Included shower head: S-3021 2.5 GPM (9.5 L/min) flow rate
- Included shower arm and flange: S-2560

### STOCK FINISHES:



PC BN

### TRIM STANDARDS:

- ASME A112.18.1/CSA B125.1 certified

### VALVE STANDARDS:

- ASME A112.18.1/CSA B125.1 certified
- ASSE 1016 certified

### SHOWER STANDARDS:

- ASME A112.18.1/CSA B125.1 certified

### WARRANTY:

Visit [www.speakman.com](http://www.speakman.com) for full product warranty information

- 5 Year Limited Warranty (commercial)
- Limited Lifetime Warranty (residential)

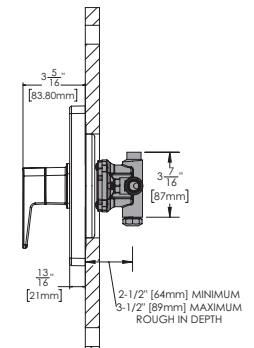
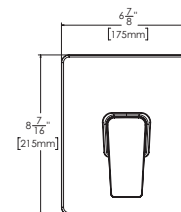
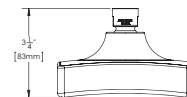
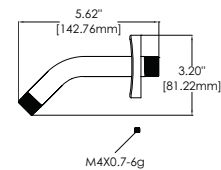
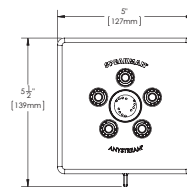

1. All dimensions are in inches (millimeters) unless otherwise specified and are subject to change without notice. 2. For ADA mounting locations consult ADAAG, ANSI A117.1 or state regulations.

Architect/Engineer Approval Space:

P: 800-537-2107  
 F: 800-977-2747  
 W: WWW.SPEAKMAN.COM  
 R: 01-DECEMBER 2018