

Strom Plumbing

BY
Sign of  the Grab

Ph: (916) 638-2722 / Fax: (916) 638-2725

Installation Information

Item #P1127

Mount Faucet with 7" Centers

Warranted only when installed by a qualified, licensed plumber. Please use Teflon tape on all threaded connections.

Please use Teflon tape on all threaded connections.

1. Shut off the water supply to the fixture before installation.
2. Rough in $\frac{1}{2}$ " IPS male pipe, $\frac{1}{2}$ " past the finished wall, with 7" centers. **Please note before roughing in: Allow adequate clearance of spout for tub being installed according to your local code requirement.**

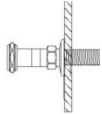

3. Thread on the wall mount couplers. Insert the screen washer into the nut of the coupler.
4. Attach the faucet body to the wall mount couplers and tighten nuts to secure.
5. Make no adjustments to valves or valve stems. They are tested at the factory for optimum performance.
6. Turn on the water and pressure-test connections.

- Faucet Body
- 6" Wall Mount Couplers & screen washers

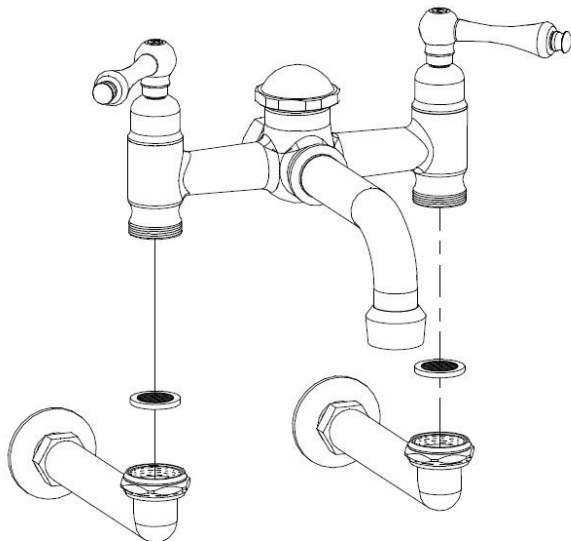

Parts Included: