

# Strom Plumbing



Ph: (916) 638-2722 / Fax: (916) 638-2725

## Installation Information

### Shower Only Set

Warranted only if installed by a qualified licensed plumber. Use Teflon tape on all threaded connections.

1. The maximum wall thickness is 1 1/2".
2. Rough in the valves from the back of a finished wall, assuring there is a proper distance for escutcheons and handles on the valve stems.
3. The spread between the Hot and Cold valves is **8" on center** with supplied nipples connected to the supplied Tee.
4. Connect the Hot & Cold valves to 1/2" iron pipe size water supply, where union and large nut are pointed down.

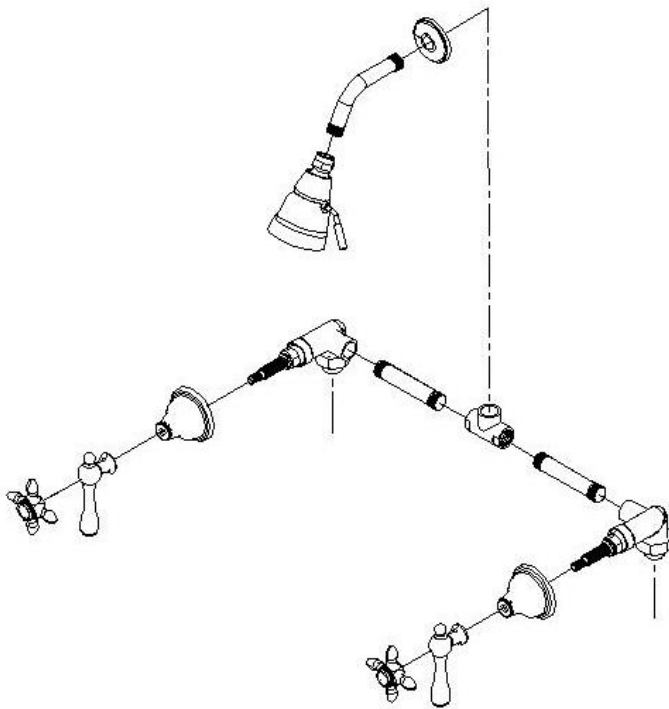

<u>Shower Only Sets</u>	<u>Centers</u>	<u>Escutcheon Diameter</u>	<u>Escutcheon Height</u>	<u>Handle Length</u>
P0112	8"	2 1/4"	1 1/2"	3 1/2"
P0158	8"	2 7/8"	1 7/8"	3 1/4"
P0407	8"	2 3/4"	2"	3 1/4"
P0409	8"	2 7/8"	1 3/4"	3 1/4"
P0413	8"	2 1/2"	1 3/4"	3 1/4"
P0450	8"	2 7/8"	1 3/4"	3 1/2"
P0591	8"	2 1/2"	1 3/4"	3"
P0808	8"	2 7/8"	1 7/8"	2 1/16"
P0846	8"	2 1/4"	1 1/2"	3 1/4"