

Feature

- 150# WSP / 600# WOG
- Lead free brass body
- Full port
- Adjustable packing
- Solder x Solder
- Solder ends (ASME B16.22)
- Blow-out proof stem
- MSS-SP-110
- AB1953, NSF/ANSI 61 & 372 certified



Meet BAA Requirement

Pressure / Temperature rating	
600 psi from 15 °F to 160 °F	150 psi max. at 366 °F

Solder used in joint	Working temp (°F)	Max. working pressure (PSI)		
		3/8" - 1"	1 1/4" - 2"	2 1/2" - 4"
95-5 Tin antimony (ASTM B32 grade 95TA)	100	500	400	300
	150	400	350	275
	200	300	250	200
	250	200	175	150

Material

Part	Material	Specification
1 Body	Lead Free Brass	ASTM B927 C28500
2 End piece	Lead Free Brass	ASTM B927 C28500
3 Ball	Lead Free Brass / Cr plated	ASTM B927 C28500
4 Seat	PTFE	PTFE
5 Stem	Lead Free Brass	ASTM B927 C28500
6 Packing	PTFE	PTFE
7 Packing nut	Brass	ASTM B124 C37700
8 Handle	Steel / Geomet® plated	ASTM A36
9 Handle nut	Steel / Zn plated	ASTM A36

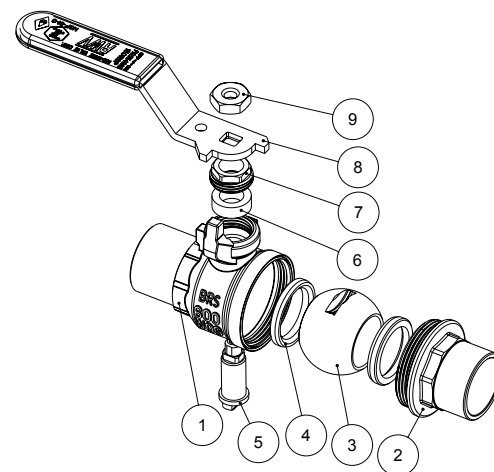

Dimension, Cv, Weight

	Φ [in]	A [in]	C [in]	H [in]	L [in]	P [in]	Cv	Wt. [lb]
1/2"	0.627-0.631	2.13	0.51	2.11	3.60	0.59	15	0.45
3/4"	0.877-0.881	2.87	0.75	2.24	3.60	0.79	30	0.65
1"	1.128-1.131	3.39	0.91	2.56	4.98	0.98	60	1.04
1 1/4"	1.378-1.381	3.90	0.98	2.78	4.98	1.26	110	1.58
1 1/2"	1.628-1.632	4.53	1.09	3.27	5.57	1.57	130	2.53
2"	2.128-2.132	5.51	1.34	3.57	5.57	1.97	360	3.53
2 1/2"	2.628-2.632	6.65	1.50	4.68	11.07	2.56	450	7.48
3"	3.128-3.132	7.72	1.69	5.13	11.07	3.07	620	11.31
4"	4.128-4.133	9.34	2.17	5.64	11.07	3.94	1200	17.31

