

PRODUCT SUBMITTAL 362

EVERLOC+ R-20 Connections for PRO-BALANCE Manifolds



Product: EVERLOC+® R-20 Connections for PRO-BALANCE® Manifolds

Date: 01 December 2021

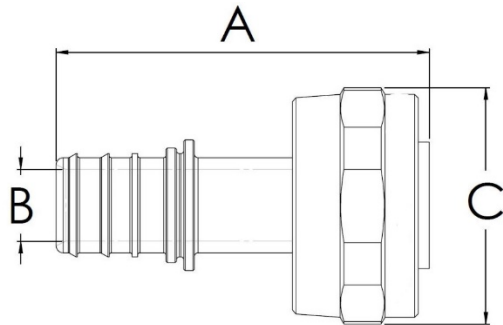

Article No.	Nominal Connection Size	A in (mm)	B in (mm)	C in (mm)
431459-001	3/8 in.	1.98 (50.2)	0.28 (7.0)	1.32 (33.4)
431461-001	1/2 in.	2.07 (52.7)	0.38 (9.7)	1.32 (33.4)
431462-001	5/8 in.	2.10 (53.3)	0.48 (12.2)	1.32 (33.4)
431463-001	3/4 in.	2.26 (57.5)	0.51 (13.0)	1.32 (33.4)

TECHNICAL DESCRIPTION

Specification	ASTM F877, CSA B137.5
Material	Machined from brass rod and nickel plated

FUNCTIONAL DESCRIPTION

EVERLOC+ R-20 connections are for use with RAUPEX® crosslinked polyethylene (PEXa) pipes and PRO-BALANCE® manifolds, as well as manifold circuit isolation valves (Art. 302047-001). These swivel nut connections install onto PRO-BALANCE manifolds without special tools. Installation of RAUPEX pipe is performed with EVERLOC+ compression-sleeve tools. Follow all published REHAU *Technical Guidelines*. EVERLOC+ R-20 connections are not for potable applications, EVERLOC+ PEXa compression sleeves sold separately. All fitting sizes include EVERLOC+ connection with installed O-ring, and swivel nut in one-piece assembly.

Follow the detailed installation instructions that are included with the PRO-BALANCE manifold and summarized here:

1. Align the fitting with the manifold outlet and push the fitting into the manifold.
2. Hand-tighten the compression nut onto the manifold outlet.
3. While holding the hex end of the manifold outlet with an adjustable wrench, verify tightness to snug fit, not exceeding 9 lb-ft (12 N-m).
4. After cutting the pipe square and clean, install RAUPEX pipe with EVERLOC+ Power Tool following all published REHAU *Technical Guidelines*.

NOTICE: Do not overtighten, as this may damage PRO-BALANCE manifold R-20 outlet

NOTICE: Do not use thread sealant tape or pipe dope on manifold outlets. These materials may prevent a proper seal, causing leaks.

For updates to this publication, visit na.rehau.com/resourcecenter

The information contained herein is believed to be reliable, but no representations, guarantees or warranties of any kind are made as to its accuracy, suitability for particular applications or the results to be obtained therefrom. Before using, the user will determine suitability of the information for user's intended use and shall assume all risk and liability in connection therewith. © 2021 REHAU