

## PRODUCT SUBMITTAL 316

Product: RAUPEX® Compression-nut Fitting – Dual MPT/ Copper Adapter

Date: 01 January 2017 (supersedes 05 November 2013)

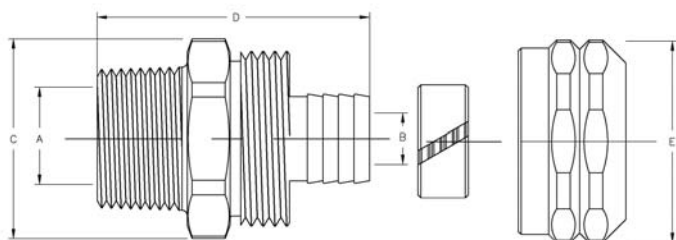

Article No.	Nominal Size	Dimensions in (mm)				
		A	B	C	D	E
267517	3/8" RAUPEX x 1/2" MPT or 1/2" C Female (Sweat)	.629 (16.0)	.225 (5.7)	1.063 (27.0)	1.937 (49.1)	1.25 (31.7)
260987	1/2" RAUPEX x 1 1/2" MPT or 1/2" C Female (Sweat)	.629 (16.0)	.331 (8.4)	1.063 (27.0)	1.937 (49.1)	1.25 (31.7)
267567	5/8" RAUPEX x 1/2" MPT or 1/2" C Female (Sweat)	.629 (16.0)	.406 (10.3)	1.063 (27.0)	1.937 (49.1)	1.25 (31.7)
260357	3/4" RAUPEX x 3/4" MPT or 1/2" C Female (Sweat)	.629 (16.0)	.510 (12.9)	1.312 (33.3)	2.011 (51.0)	1.50 (38.1)
260477	1" RAUPEX x 1" MPT or 3/4" C Female (Sweat)	.879 (22.3)	.717 (18.2)	1.75 (44.4)	2.095 (53.2)	1.875 (47.6)

### TECHNICAL DESCRIPTION

Specification	ASTM F877
Material	Brass
Certifications	ASTM F877 / CSA B137.5

### FUNCTIONAL DESCRIPTION

RAUPEX split-ring compression-nut brass fittings are an integral fitting/insert design providing positive clamping and sealing action with split compression ring. Dual adapter fittings connect RAUPEX pipe to other threaded piping systems (first size) or copper pipe (second size). Make threaded or solder connection before installing to RAUPEX pipe. Follow all published installation instructions.

REHAU recommends compression-nut fittings be accessible for periodic inspection.

For updates to this publication, visit [na.rehau.com/resourcecenter](http://na.rehau.com/resourcecenter)

The information contained herein is believed to be reliable, but no representations, guarantees or warranties of any kind are made as to its accuracy, suitability for particular applications or the results to be obtained therefrom. Before using, the user will determine suitability of the information for user's intended use and shall assume all risk and liability in connection therewith.

© 2017 REHAU