

# LagosSeries ADJUSTABLE LINEAR DRAIN 2"

## Adjustable Linear Drain:

### Materials:

Grate: Marine Grade Stainless Steel 316, Thickness: 8 gauge for Edge Bars and 9 gauge for Inside Bars.  
Base: PVC plastic 3mm

### Features:

- Removable Grate: Can be completely removed for easy cleaning and maintenance.
- Hair Strainer Basket Included: Fits inside the drain to collect hair and debris, helping prevent clogged pipes.

### Installation Methods

- Designed for compatibility with:
- Traditional waterproofing methods pair with our 2" Clamp-Down Drain for easy installation.



### Kit Includes:

- Base
- Outlet\*\*
- End Cap
- Grate\*
- Trims
- Hair Strainer
- Lifting Key
- Leveling Feet
- Threaded Nipple
- Stainless Steel Cutting Blade

## Specifications

### Base

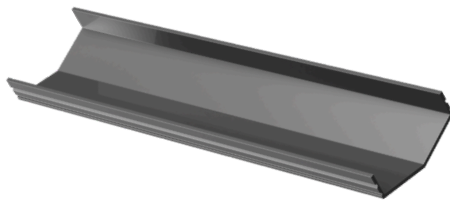

L:  
32"  
44"  
56"  
68"  
92"

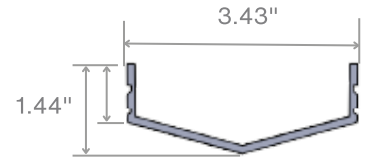

### Grate\*

36" / 48" / 60" / 72"

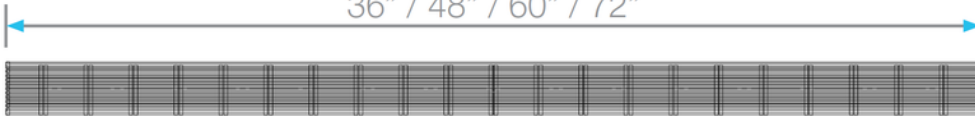

\*

96" kit has two 48" grates.  
72" kits in black, gold, luxe gray, champagne, and bronze have two 36" grates.

### Outlet

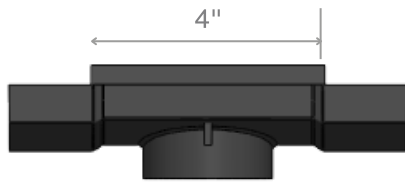

\*\* 72" and 96" Kits include two outlets.

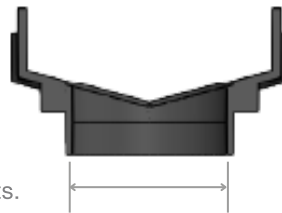

2"

### End Cap

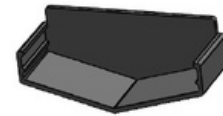

## Optional Components:

### Joiner

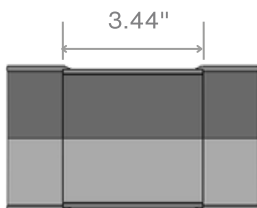

A Joiner is needed to connect kits to build the desired length. It is sold separately. It is not part of the kit.

SKU: 88.JOINER ●

### Corner

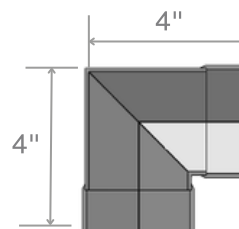







A corner is needed when connecting two channels at a 90-degree angle. Corner is an accessory, it is sold separately. It is not part of the kit.

SKU: 88.601.COR ●

# LagosSeries ADJUSTABLE LINEAR DRAIN 2"

## Complete Kits SKU: WEDGEWIRE

|   |     |              |   |
|---|-----|--------------|---|
|          | 36" | 88.610.36 ST | ● |
|   | 48" | 88.610.48 ST | ● |
|   | 60" | 88.610.60 ST | ● |
|   | 72" | 88.610.72 ST | ● |
|   | 96" | 88.610.96 ST | ● |
|           | 36" | 88.610.36 PS | ● |
|   | 48" | 88.610.48 PS | ● |
|   | 60" | 88.610.60 PS | ● |
|   | 72" | 88.610.72 PS | ● |
|   | 96" | 88.610.96 PS | ● |
|          | 36" | 88.610.36 BK | ● |
|   | 48" | 88.610.48 BK | ● |
|   | 60" | 88.610.60 BK | ● |
|   | 72" | 88.610.72 BK | ● |
|   | 96" | 88.610.96 BK | ● |
|          | 36" | 88.610.36 GD | ● |
|   | 48" | 88.610.48 GD | ● |
|   | 60" | 88.610.60 GD | ● |
|   | 72" | 88.610.72 GD | ● |
|   | 96" | 88.610.96 GD | ● |
|        | 36" | 88.610.36 BZ | ● |
|   | 48" | 88.610.48 BZ | ● |
|   | 60" | 88.610.60 BZ | ● |
|   | 72" | 88.610.72 BZ | ● |
|   | 96" | 88.610.96 BZ | ● |
|        | 36" | 88.610.36 CH | ● |
|   | 48" | 88.610.48 CH | ● |
|   | 60" | 88.610.60 CH | ● |
|   | 72" | 88.610.72 CH | ● |
|   | 96" | 88.610.96 CH | ● |
|  | 36" | 88.610.36 LG | ● |
|   | 48" | 88.610.48 LG | ● |
|   | 60" | 88.610.60 LG | ● |
|   | 72" | 88.610.72 LG | ● |
|   | 96" | 88.610.96 LG | ● |

Note: Installer must verify all rough-in dimensions prior to installation and consult local and national codes. Conformity and compliance to local and national codes are the responsibility of the installer. Dimensions are subject to manufacturers tolerance and change without notice. We can assume no responsibility for use of superseded or voided data. [Contact us if you have any question at: info@qm-us.com](mailto:info@qm-us.com)