



DelmarSeries Square Drain

Center Drain | Square 4":

- Stainless Steel 316 Gauges: Grate: 16 gauges = 1.5 mm | Base: 18 gauges = 1.2 mm.
- Grate can be removed completely for cleaning.
- Designed for compatibility with:
 - Traditional waterproofing methods pair with our 2" Clamp-Down Drain for easy installation.
 - Modern waterproofing: pair with our QM Waterproofing Kit.
 - QM Shower Pan: For a mortar-free solution
- Hair strainer basket comes with every drain, fits inside the drain to collect hair and other debris, preventing clogged pipes.

Kit Includes:

- A** Lifting Key
- B** Grate
- C** Hair/Debris Strainer
- D** Base

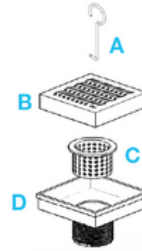

Specifications

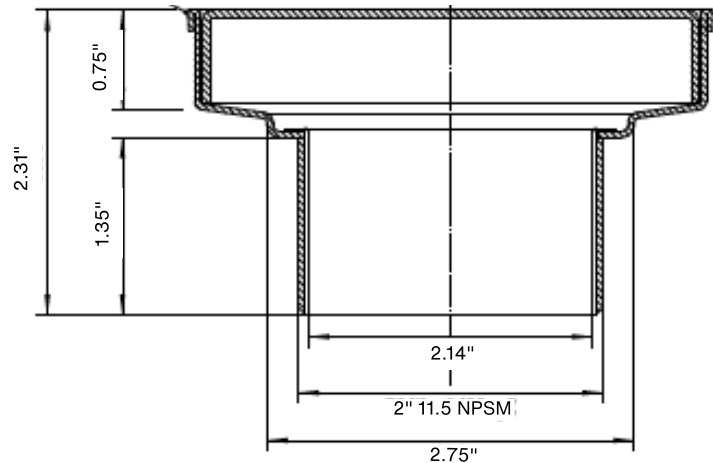
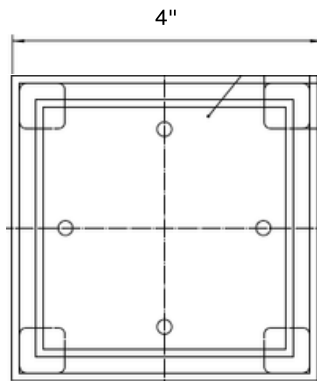

Complete Kits

MIST (TILE-IN)



33.500.04 ST

33.500.04 BZ



33.500.04 BK

33.500.04 GD

Note: The Tile-In grate accepts flooring material up to 3/8" thickness.