

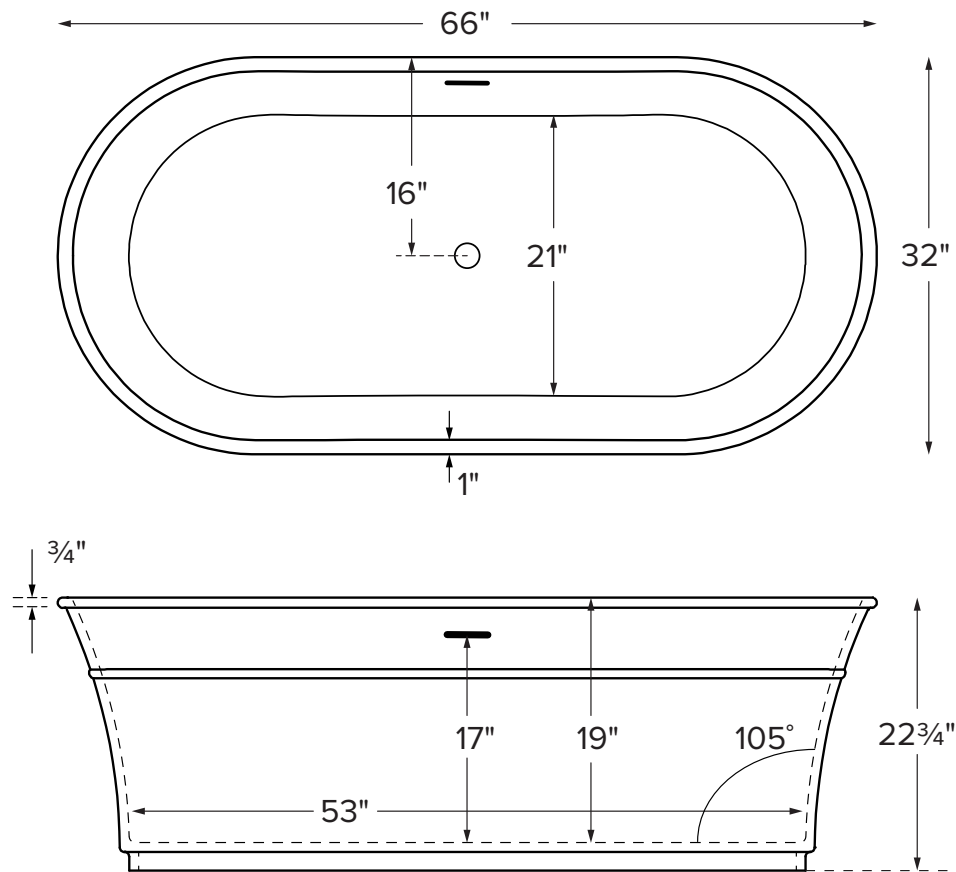

acquabella®

Hudson

MODEL 404
66" x 32" x 23"
FREESTANDING 85 gal to overflow
Mineral Composite
208 lbs / 94 kg soaker
Filling this tub to the maximum may require an above average size or dedicated water heater.



Drain Rough-In
Measurement

X
16"

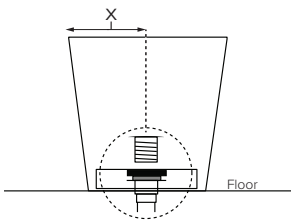

ELECTRICAL COMPONENTS & SPECIFICATIONS

Required Electrical Service - 110 Volt

Hydrotherapy Package	Components Included	GFCI
Air Massage	heated blower	1-15 amp

Electrical requirements may change with the addition of optional therapy components.
See specific option details or installation information.
CSA Certified C/US; B45.5/IAPMO ANSI Z124.1 and ANSI 112.19.7

See the Installation & Operation Manual for more details.
MTI's Customer Service: Monday-Friday 8am-6pm EST
800-783-8827 or service@mtibaths.com

ORDERING AND INSTALLATION

- Before ordering or installing, please consider future access to equipment.
- Integrated overflow with toe tap drain included.
- Air baths require job site preparations for remote mounting the blower and required check valve. Check valve must be installed higher than the rim of the tub.
- Waterproof remote control included. Keypad is shipped loose and may be mounted nearby.
- Faucet valves cannot be installed on this tub model.

- Before discarding tub packaging, check for accessories that may be packaged inside.
- All product measurements are $\pm 1/2"$.
- Specifications and configurations are subject to change without notice.
- Measurements herein supersede all others published prior to publication date below.

CSA # MMCT- 404

©2024 by MTI Baths, Inc. Modification Rights Reserved

For more information on options and accessories
go to Cosmopolitan Mineral Composite Tubs Options on mtibaths.com

- Blower & required check valve for airbath must be remote mounted
- Check valve must be installed higher than the rim of the tub.

acquabella®
Hudson
MODEL # 404
66" x 32" x 23"

Hydrotherapy	Package Contents	Part #	MSRP
Soaker	Soaking bath - no jets. Includes an integrated slotted overflow with white toe-tap drain kit.	S404	\$7,100
Air Bath	20 air jets, heated air blower, keypad, waterproof remote control, integrated slotted overflow with white toe-tap drain kit.	AST404	\$11,430

Recommended Drain Kits
Westbrass D98LTBPA-XX (included with tub) OS&B 500 Series Mountain Plumbing BDWOF-ST

Accessories
Drain Kit Accessories Brass Tailpiece (WIOBS) \$90 Quick Drain Kit (WOQ) \$485
Pillows from \$190
Teak Bath Mat (TKMAT3018) \$840 <i>Custom sizes also available. Contact MTI for details and pricing.</i>



Inside view of tub