



ENGINEERING EXCELLENCE

Installation Guide

Wallmount Pot Filler:





- 2AM600
- 2MT600

This product meets the following standards:

- ASME A112.18.1
- ANSI A117.1
- ANSI / NSF 61, SECTION 9
- CUPC / IAPMO LISTED / ADA COMPLIANT
- CONTAINS NO MORE THAN 0.25% WEIGHTED AVERAGE LEAD CONTENT

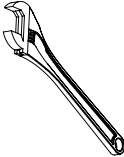
Thank you for purchasing this Pioneer quality product.

Tools Required

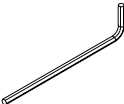
				
Adjustable Wrench	Teflon Tape	Rags	3/32" Allen Wrench	1/16" Allen Wrench

Prior to Installation

- Observe all local plumbing and building codes before you begin installation.
- Carefully shut off cold water supply.
- Plug the sink drain with a soft cloth to prevent intrusion of debris or the loss of any parts.
- Pioneer reserves the right to make changes in the design of faucets without notice.

Faucet Installation

- Caution:- Do not hold both swivel arms to avoid any damage when install the pot-filler to inlet pipe nipple.
1. Ensure the 1/2" IPS/NPT threaded inlet is installed properly.
 2. Confirm the 1/2" IPS/NPT threaded inlet pipe nipple must be kept with a length of 1/2" from the finished wall.
 3. After wall is finished install the pot filler to the 1/2" IPS/NPT threaded inlet pipe nipple. Do not fully tighten.
 4. Level the pot-filler. Mark the drilling hole location on the finished wall.
 5. Remove the pot filler.
 6. Drill the four 3/32" holes on the premarked location.

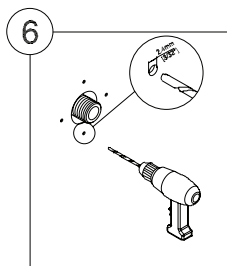
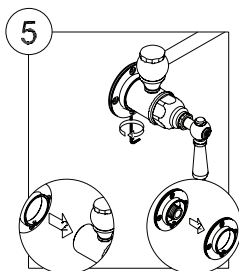
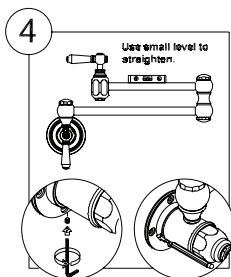
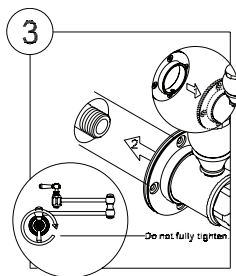
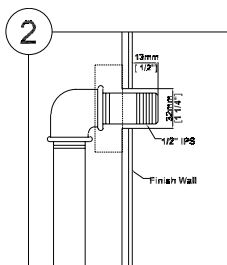
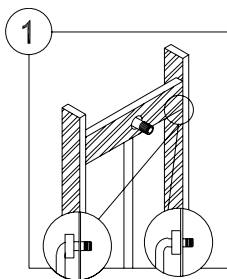

Faucet Installation

7. Apply teflon tape before installing the mounting bracket(B). Put the mounting washer on the wall and drill the 3/32" hole on the same location as wall. Ensure the mounting washer(A) is behind the mounting bracket(B) to form the watertight seal. Install the mounting bracket(B) with the mounting screws (C) supplied with faucet. Tighten the mounting screws(C).
8. Remove the 3/32" allen screw(D).
9. Carefully screw the pot-filler into inlet pipe nipple using strap wrench to fully tighten the pot filler. Ensure the notches on the faucet align with the 3/32" allen screw(D).
10. Level the pot filler.
11. Tighten the 3/32" allen screw(D).
12. Place the escutcheon in correct position. Tighten the 1/16" allen screw(E).

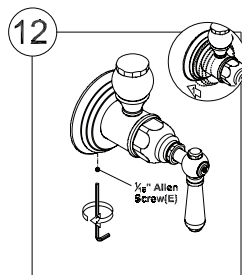
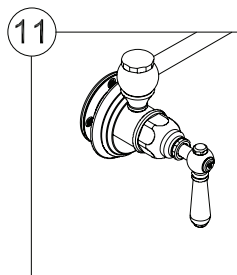
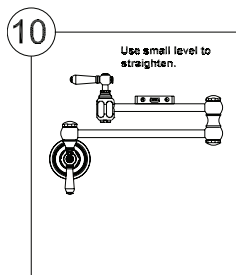
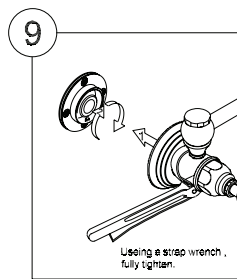
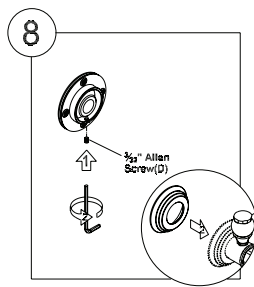
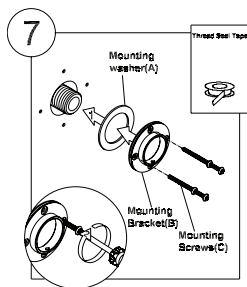

Faucet Installation

13. Make sure the pot filler spout swivels smoothly.
14. Place a bucket underneath of the pot-filler. Remove the aerator.
15. Turn on inlet water supply. Make sure all the connections are secure. Open both handles. Flush and allow water to run at full flow for at least one minute. Replace the aerator.
16. Turn off water.

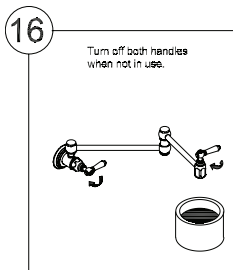
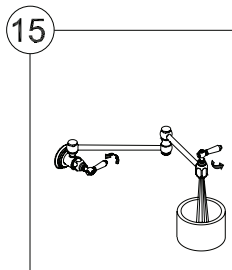
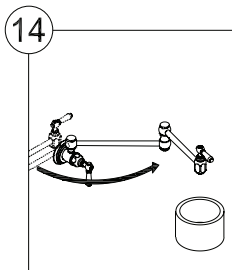
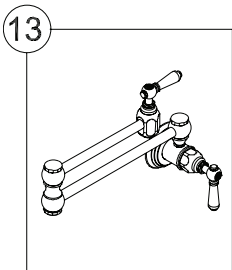

For more care information or trouble shooting inquiries about your Pioneer Product, please see the contact information on the back page.



ENGINEERING EXCELLENCE

3325 S. Garfield Ave. | Commerce, CA 90040
Telephone: (800) 338-9468 | (323) 888-8873 | Fax: (323) 888-9515
Hours: M - F, 7:30am to 5:00pm PST
www.pioneerind.com