

K330



- Available Split Finish Options:
Montaione Brown Onyx / Blue Sodalite / Pink Onyx / Fienze Black Onyx

PRODUCT FEATURES

- Style: Traditional
- Collection: Versailles
- Temperature Controlled By Handles
- Lever Handles
- Split Finish: Green Onyx

TECHNICAL DETAILS

ADA Compliance: Yes
Deck Thickness Maximum: 1"
Deck Thickness Minimum: 1/8"
Drain Assembly Material: Brass
Drain Style: Lift Pop-up
Fitting Hole Diameter: 1 1/8"
Number of Holes: Three Hole
Number of Handles: Two
Handle Spread Maximum: 12"
Handle Spread Minimum: 8"
Handle Turn Angle: Quarter Turn
Spout Reach: 5 5/16"
Spout Height: 6 5/16"
Inlet Connection Type: Male 1/2" NPSM
Installation Type: Deck Mounted
Primary Material: Brass
Valve Material: Ceramic
Flow Restriction: 1.2 gpm
Water Pressure Maximum: 85 PSI
Water Pressure Minimum: 20 PSI
Water Pressure Recommended: 60 PSI

PRODUCT DIMENSIONS

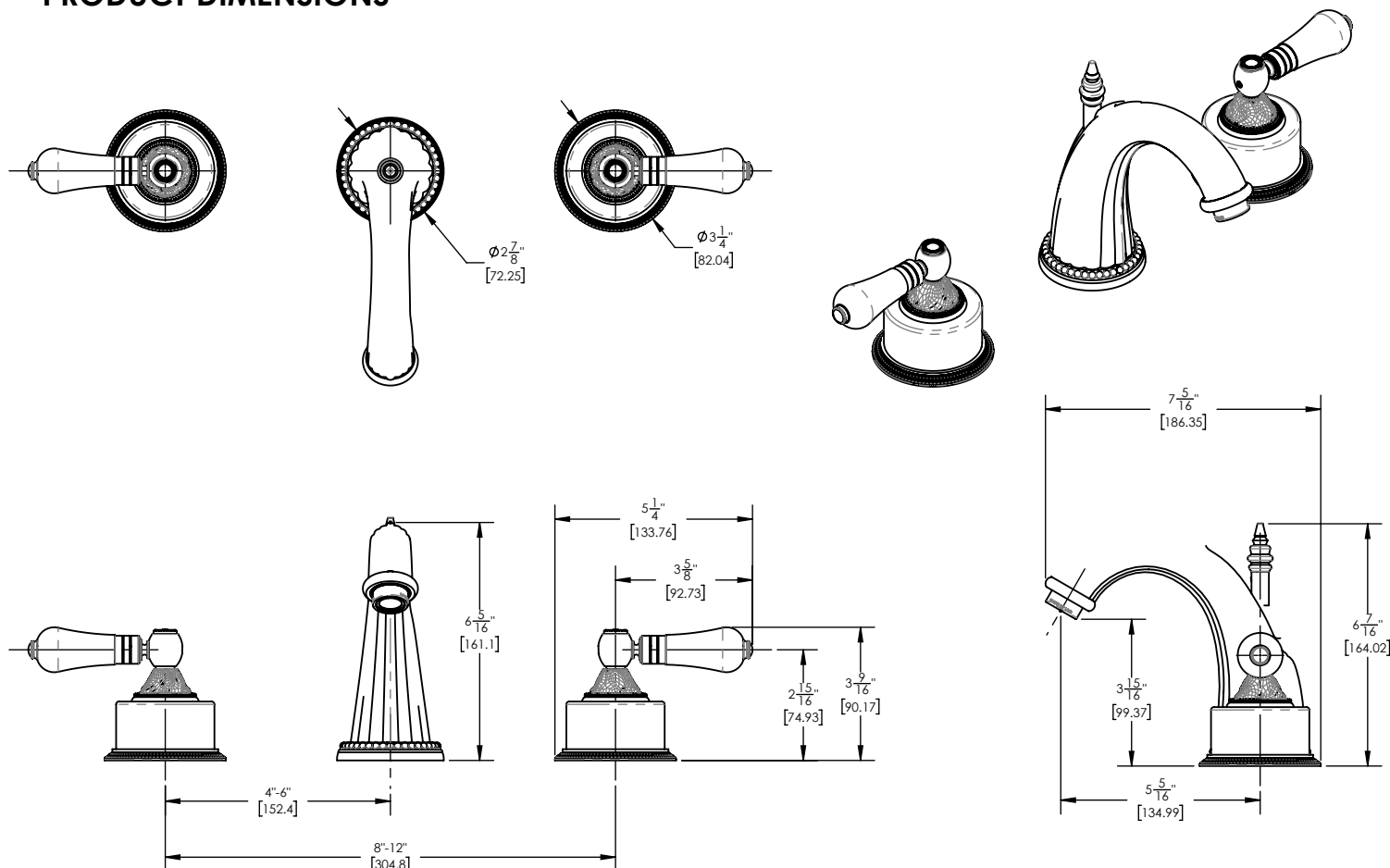

www.phylrich.com

1261 Logan Avenue, Costa Mesa, California 92626.
Phone: 714.361.4800 Fax: 714.617.3120



CODES & STANDARDS

ASME A112.181/CSA B125.1, ASME 112.18.2/CSA B125.2, ANSI NSF, CEC

WARRANTY

Mechanical Warranty: 10 Years from date of purchase.
Finish Warranty: See catalog for further information.

Rev-