

# STAINLESS STEEL DOOR PULL BACK TO BACK INSTALLATION

(for 4010, 4019 & 8190 pulls)

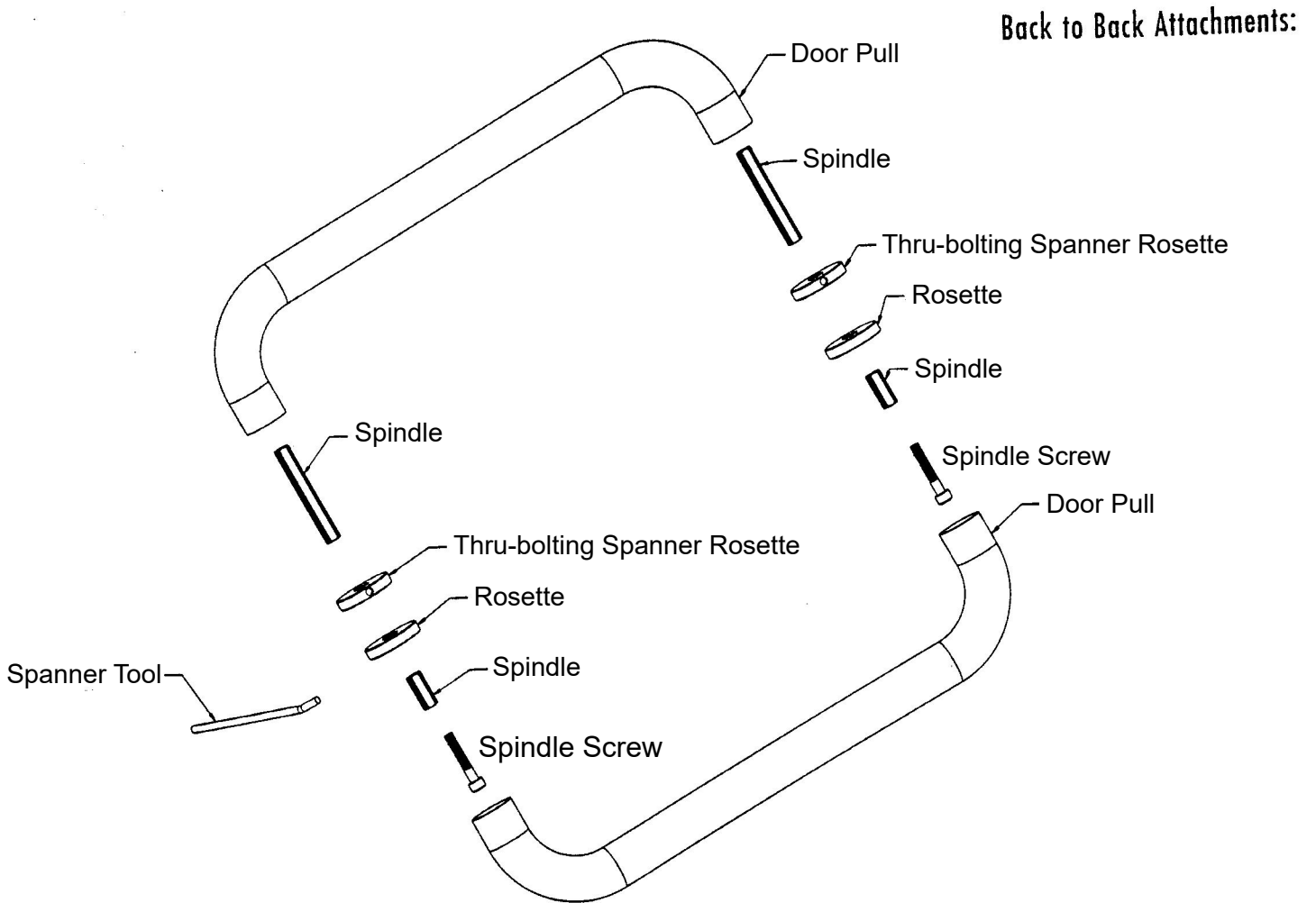

Assemble parts according to exploded view. Door surface is between the thru-bolting spanner rose and the rosette. Position the Spanner Tool in the hole on the side of the Thru-bolting Spanner Rosette and turn to tighten the assembly.