

**Lisbon**

Product code : **LI65**

Draft revision : **20130805114300**

External dimensions : **65" x 29" x 24" [165,1 cm x 73,7 cm x 61,0 cm]**

Series : **Influence**

Seats : **1**

2012 catalog page :

Lumbar support : **no**

Arm rests : **no**

Low-profile available : **no**

**Draft and specs**

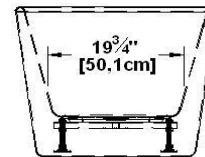
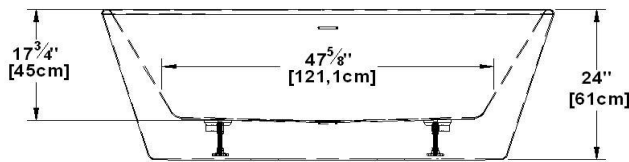
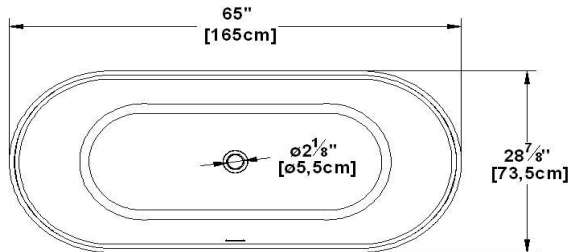

Specifications	
Capacity :	<b>45 IMP Gal. / 58,7 US Gal. / 204,6 liters</b>
AeroMassage™ :	<b>unavailable</b>
Super AeroMassage™ :	<b>unavailable</b>
Dynamic Turbo™ :	<b>unavailable</b>
Comfort Air™ :	<b>unavailable</b>
Characteristics :	<b>One-piece freestanding bath</b>

Remarks
*all measures have a precision of ± 1/4" (0,63cm)
*internal dimensions taken at 4" (10cm) from bath bottom
*capacity is measured by filling the soaker to 1-1/2" under the overflow
*textured skirt available on all Freestanding products
*shelf height is 3/4" on all "low-profile" models

**Options and installation**

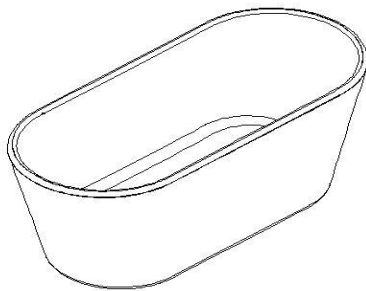

accessories and decorative lines positions are approximative

Additional(s) note(s) :

**Drain and overflow are included and factory installed.**

Legend		
(S) Blower	(L) Chromatherapy light	(C) Keypad
(P1) Pump	(P2) Grab bar	
Recommended faucets drilling location*		
Deck cut-out line - - - - -		

Model	Availability
Soaker alone	✓
Comfort Air™	
AeroMassage™	
Super AeroMassage™	
Dynamic Turbo™ (not available in the U.S.)	
Dynamic Turbo™ + AeroMassage™	
Dynamic Turbo™ + Super AeroMassage™	

Available recommended options
Front skirt :
Recommended drain : <i>Factory installed</i>
Tile flanges : <i>unavailable</i>
Remote control** : <i>unavailable</i>
**Floating

\*It is possible to install the faucets elsewhere on the product. The installer must verify that there are no piping or wires before drilling.

**IMPORTANT NOTE : Specifications, dimensions and models are subject to change.**

Visit our website <http://www.oceania-attitude.com> to access up-to-date dimensions and informations. In all cases, information on the website is the most up-to-date. Dimensions may vary slightly. To ensure proper fit, mesurements must be taken on the product directly.

**Head office**

591, avenue des Entreprises  
Thetford Mines, Quebec  
CANADA G6H 4B2

**Phone numbers**

No-charge : 1-877-332-4224  
Fax : 1-866-460-4334

**Internet**

Web : <http://www.oceania-attitude.com>  
Email : [info@oceaniabaths.com](mailto:info@oceaniabaths.com)