

Features

Solid brass construction
5.56" (14.1 cm) spout height at outlet
7.15" (18.2 cm) spout reach (c-c)
Intended for use with Newport Brass rough valve kit (Required Accessory) which i
Brass valve bodies and quick-connect spout fitting
Quarter-turn washerless ceramic disc 3/4" valve cartridges
ADA Compliant

Codes / Standards Compliance

Meets or exceeds the following at date of manufacture:

ASME A112.18.1/CSA B125.1
IAMPO/cUPC
IPC
ADA & ICC/ANSI A117.1
All applicable US Federal and State material regulations

ROMAN TUB DECK TRIM

3-2496

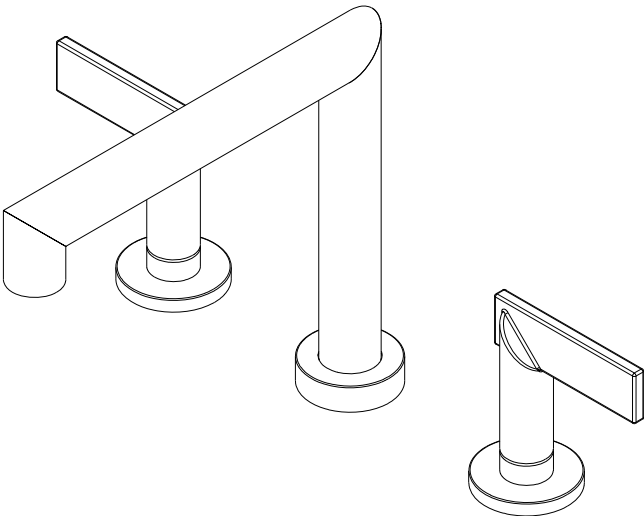

ACCESSORY REQUIRED	
System Element	Deck Tub Valve
Description	2-Valve Assembly With Quick Connect Spout Adapter
Inlet/Outlet Size	3/4" / 3/4"
Part Number	1-697
Image	The image shows three components of the accessory: two cylindrical valve bodies with handles and one quick-connect spout adapter with a threaded end.

3-2496

PRODUCT DIMENSIONS *(Units are in inches)*

Product Dimensions are provided for reference only. For specific product installation guidelines, please reference the Installation Instructions of the product being installed.

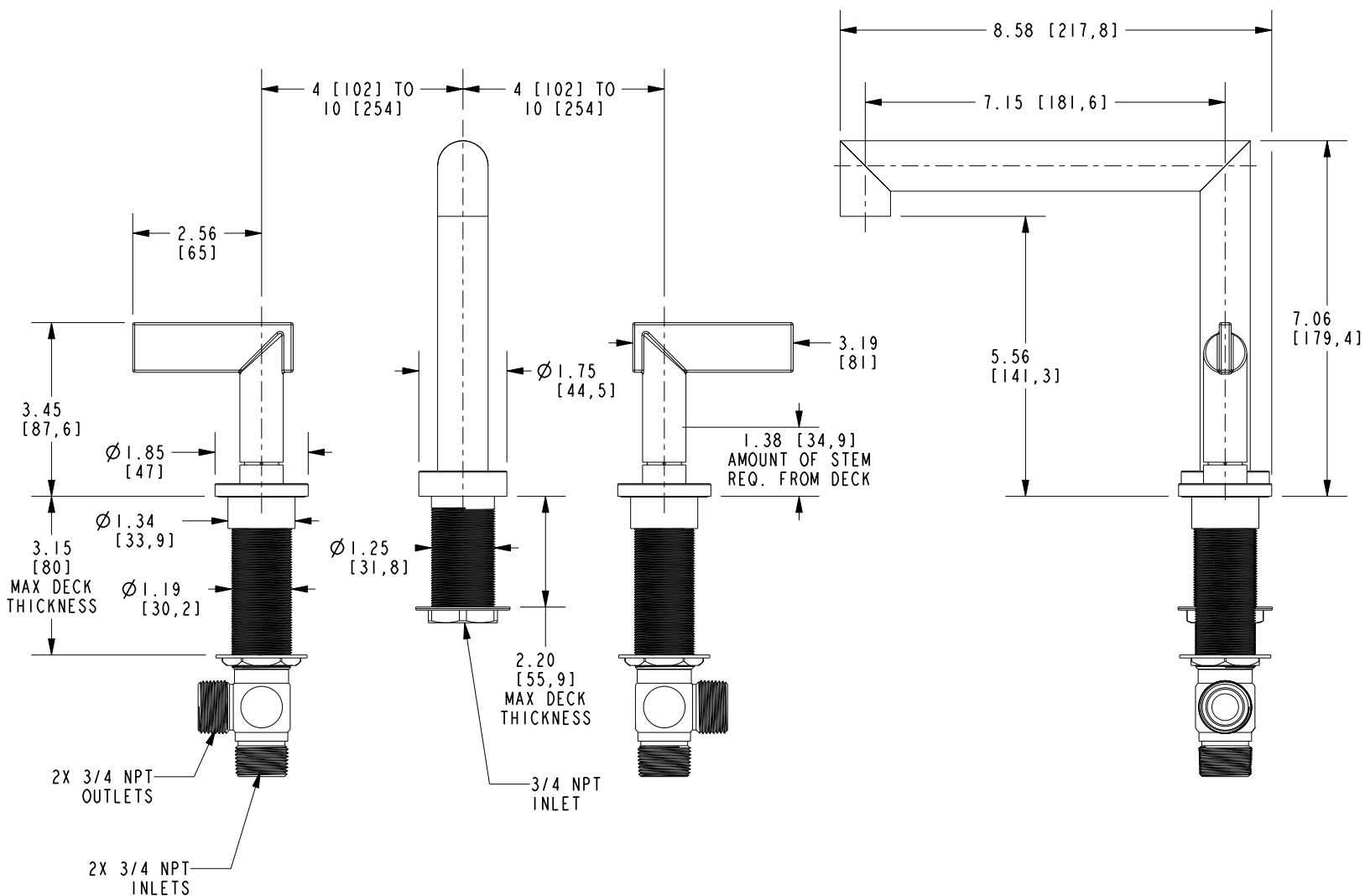

ROMAN TUB DECK TRIM

3-2496

Page 2 of 2

EN- 4882

REV D

NEWPORT BRASS
Flawless Beauty. From Faucet to Finish.

t: 949.417.5207 | www.newportbrass.com
©2024 Brasstech, Inc.